

Amendment 33 to Council Bill No. 32 -2013

**BY: Chairperson at the request
of the County Executive**

**Legislative Day No. 9
Date: July 1, 2013**

Amendment No. 33

(This amendment makes a technical correction to insert maps 43.001, 43.002, 43.004, and 43.013. Due to a printing error, these maps were not included in the paper prefiled version of the Comprehensive Zoning Plan.)

- 1 In the Comprehensive Zoning Plan as attached to the Bill as introduced;
- 2
- 3 In the Section entitled “Map Amendments”, behind the tab entitled “Supported by DPZ”, insert
- 4 maps 43.001, 43.002, 43.004, and 43.013 as attached to this amendment.
- 5
- 6 Make a conforming change to the summary chart.

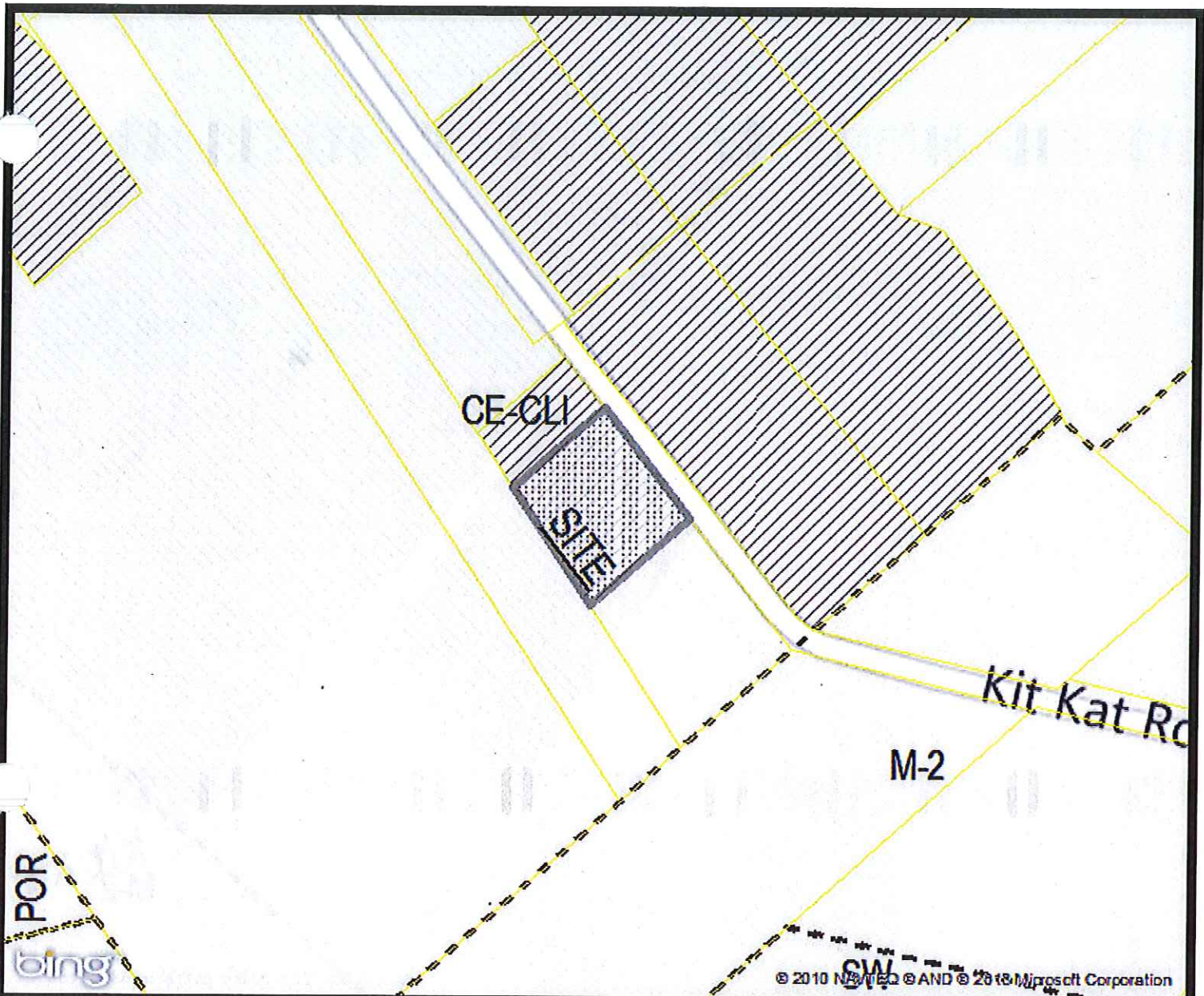

1	2	3	4	5		
6	7	8	9	10	11	
12	13	14	15	16	17	18
19	20	21	22	23	24	25
	27	28	29	30	31	32
	33	34	35	36	37	38
	39	40	41	42	43	44
		45	46	47	48	
				50		



Zoning Map General Plan Amendment: **43.001** Tax ID: **1401157671**
 Current Zoning: **CE-CLI** Tax Map: **43** Grid: **4** Parcel: **449** Lot: **N/A**
 Proposed Zoning: **M-2**
 Address: **7080 KIT KAT RD** Council District: **2**

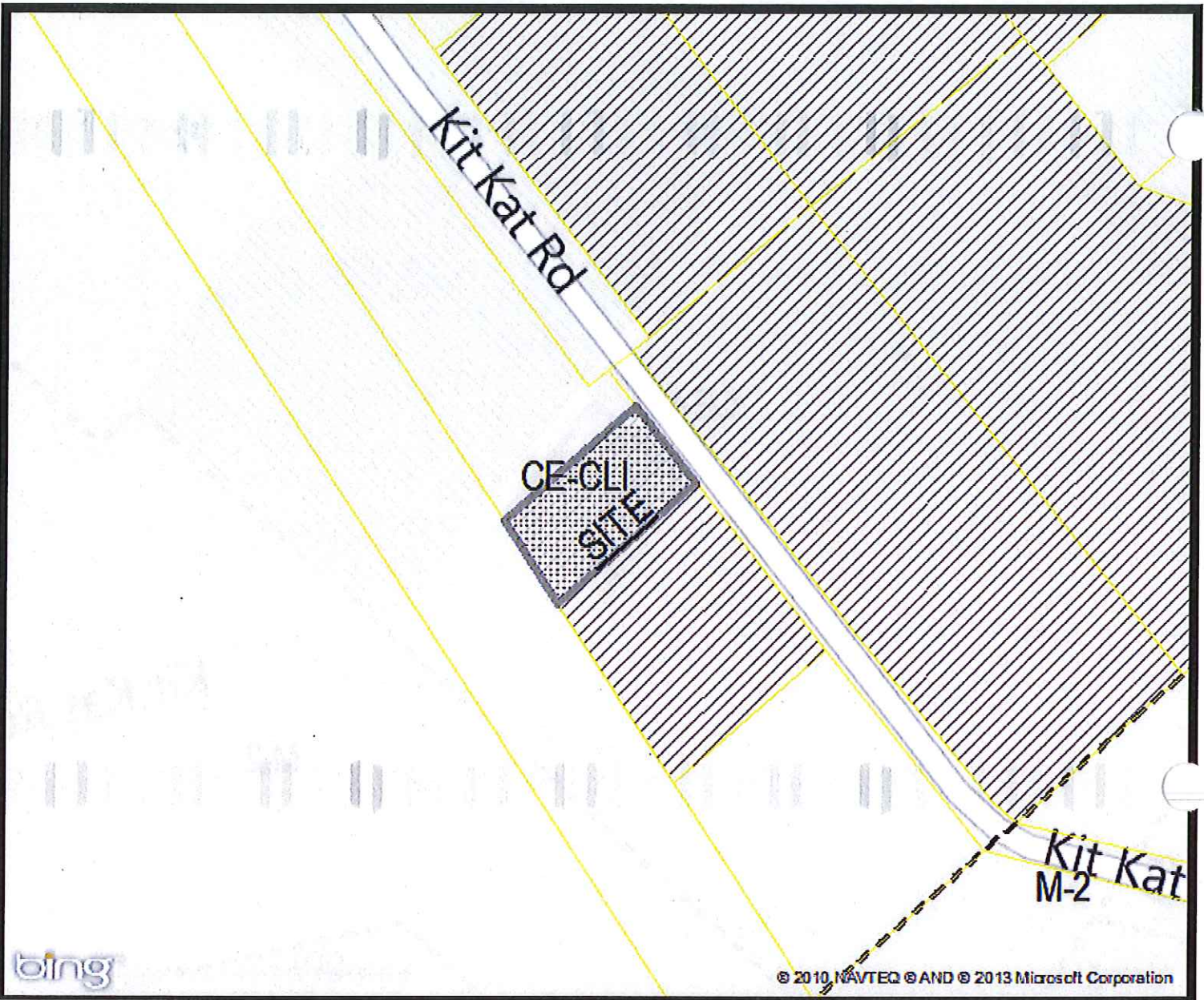

1	2	3	4	5		
6	7	8	9	10	11	
12	13	14	15	16	17	18
19	20	21	22	23	24	25
	27	28	29	30	31	32
	33	34	35	36	37	38
	39	40	41	42	43	44
		45	46	47	48	
				50		



Zoning Map General Plan Amendment: **43.002** Tax ID: **1401171844**
 Current Zoning: **CE-CLI** Tax Map: **43** Grid: **4** Parcel: **36** Lot: **N/A**
 Proposed Zoning: **M-2**
 Address: **7066 KIT KAT RD** Council District: **2**

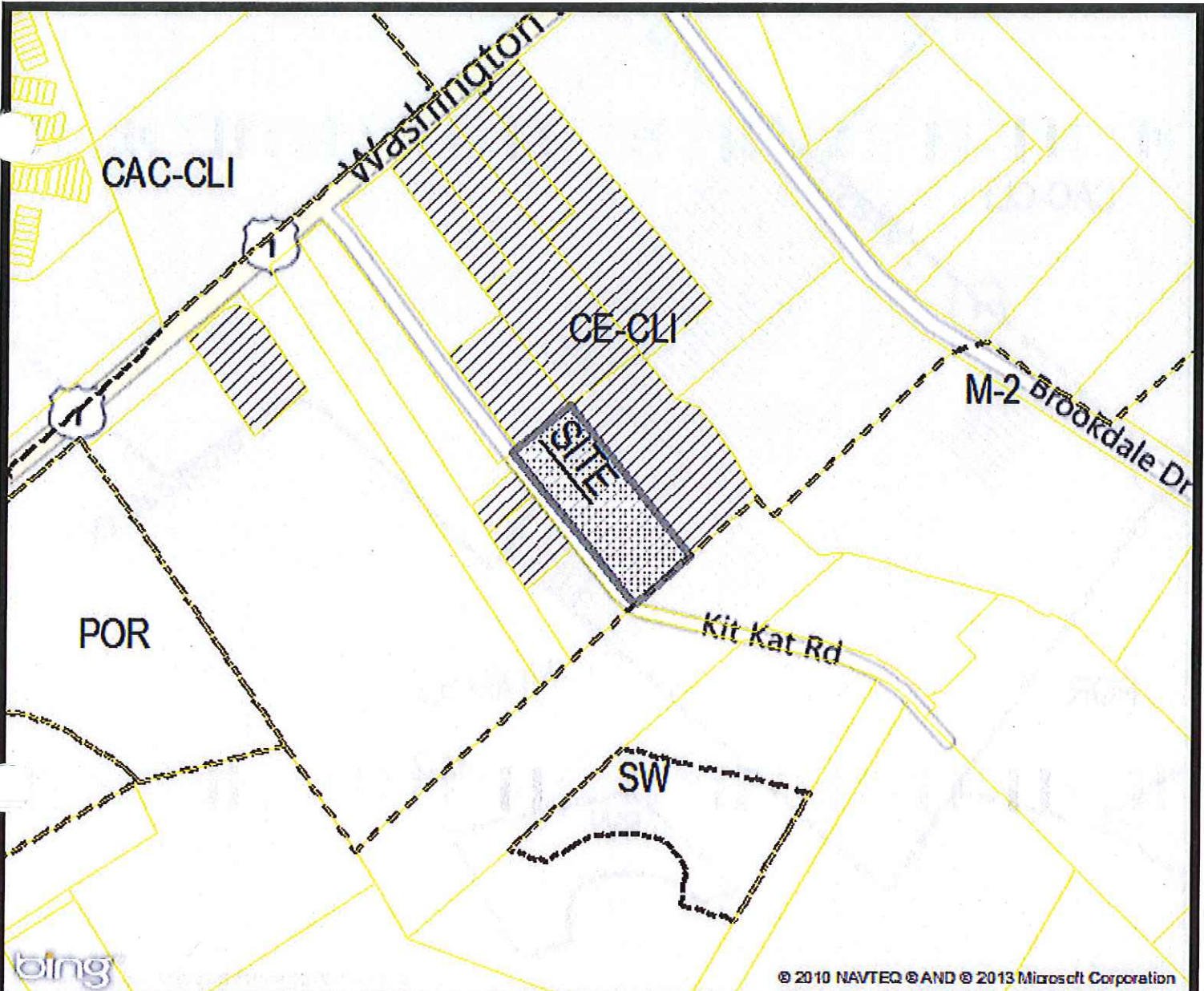

© 2010 NAVTEQ © AND © 2013 Microsoft Corporation

1	2	3	4	5		
6	7	8	9	10	11	
12	13	14	15	16	17	18
19	20	21	22	23	24	25
	27	28	29	30	31	32
	33	34	35	36	37	38
	39	40	41	42	43	44
		45	46	47	48	
						50



Zoning Map General Plan Amendment: 43.004 Tax ID: 1401170023
 Current Zoning: CE-CLI Tax Map: 43 Grid: 4 Parcel: 41 Lot: 45
 Proposed Zoning: M-2
 Address: 7065 KIT KAT RD Council District: 2

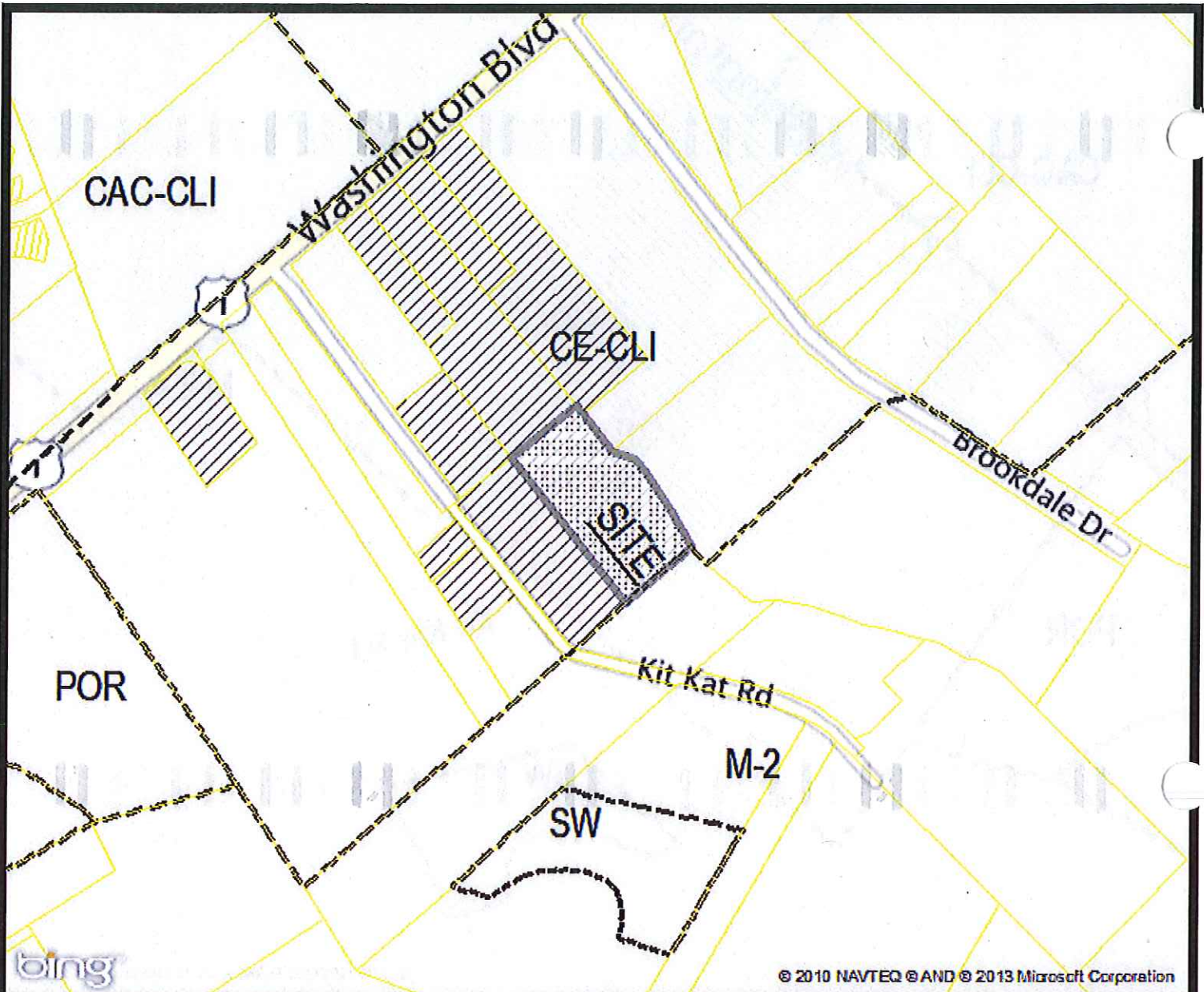

1	2	3	4	5		
6	7	8	9	10	11	
12	13	14	15	16	17	18
19	20	21	22	23	24	25
	27	28	29	30	31	32
	33	34	35	36	37	38
	39	40	41	42	43	44
		45	46	47	48	
						50



Zoning Map General Plan Amendment: **43.013** Tax ID: **1401170031**
 Current Zoning: **CE-CLI** Tax Map: **43** Grid: **4** Parcel: **44** Lot: **N/A**
 Proposed Zoning: **M-2**
 Address: **7059 KIT KAT RD** Council District: **2**