

County Council of Howard County, Maryland

2012 Legislative Session

Legislative day # 11

RESOLUTION NO. 134 - 2012

Introduced by: Courtney Watson

Cosponsored by Calvin Ball and Jennifer Terrasa

A RESOLUTION requesting the Public Service Commission of Maryland investigate the reliability of the electric power supply for certain areas in Howard County and require electrical utility providers doing business in Howard County to disclose outage information to Howard County after 24 hours; and directing certain other actions by certain County officials.

Introduced and read first time on September 4, 2012

By order Stephen M LeGendre  
Stephen LeGendre, Administrator to the County Council

Read for a second time and a public hearing held on September 18, 2012

By order Stephen M LeGendre  
Stephen LeGendre, Administrator to the County Council

This Resolution was read the third time and was Adopted , Adopted with amendments , Failed , Withdrawn  by the County Council on October 1, 2012.

Certified by Stephen M LeGendre  
Stephen LeGendre, Administrator to the County Council

NOTE: [[text in brackets]] indicates deletions from existing language; TEXT IN SMALL CAPITALS indicates additions to existing language. Strike-out indicates material deleted by amendment; Underlining indicates material added by amendment.

1           **WHEREAS**, Baltimore Gas and Electric Company (BGE) is a public service company  
2 licensed by the Public Service Commission (PSC) to conduct business in Howard County; and

3  
4           **WHEREAS**, Section 3-102 of the Public Utility Companies Article of the Maryland  
5 Code requires the PSC to conduct an investigation into the reliability of the electric power supply  
6 on complaint filed by the legislative body of a county in which an electric company is authorized  
7 to operate; and

8  
9           **WHEREAS**, Section 3-102 of the Public Utilities Article also requires the PSC to  
10 conduct an investigation into the reliability of the electric power supply on complaint filed by not  
11 less than 100 customers of the electric company; and

12  
13           **WHEREAS**, *Reliability4HOCO* filed a complaint dated February 22, 2012 with the PSC  
14 against BGE about the reliability of electric service in the neighborhoods of Font Hill, Little  
15 Patuxent Ridge, Dunmore Woods, Gwyn Acres, Dunloggin, Beaverbrook, Valley Mede,  
16 Sebring, Dalton, Green Henge, Clarksville Ridge, Turf Valley Road, Normandy Heights, The  
17 Oaks, Forest Hill Drive, Bethgate, and Worthington; and

18  
19           **WHEREAS**, On April 12, 2012, the PSC docketed the complaint filed by  
20 *Reliability4HOCO* against BGE as Case No. 9291;

21  
22           **WHEREAS**, The complaint filed by *Reliability4HOCO* also asserted that other  
23 neighborhoods in Howard County experience problems with reliability of electric service  
24 provided by BGE; and

25  
26           **WHEREAS**, The County Council, as the legislative body for Howard County, finds that  
27 ~~the many neighborhoods of Braeburn, Burleigh Manor, Columbia, Columbia Hills, Dunloggin,~~  
28 ~~Hammond Village, Historic Ellicott City, Hollifield, Laurel, Pleasant Chase, Ridgley's Run, The~~  
29 ~~Oaks, Turf Valley Legends, Turf Valley Vistas and Worthington in Howard County, including~~  
30 the neighborhoods under review in Case No. 9291, as specified in Exhibit A to this Resolution

1 experience reliability problems with electric service provided by BGE; and

2  
3 **WHEREAS**, The County Council intends that this Resolution, constitutes a new  
4 complaint for purposes of Section 3-102 of the Public Utility Companies Article to require the  
5 PSC to conduct an investigation of the reliability of electric power supply to the neighborhoods  
6 set forth on Exhibit A to this Resolution at the behest of the legislative body of Howard County;  
7 and

8  
9 **WHEREAS**, Howard County is charged with important public health, safety and welfare  
10 responsibilities for its citizens; and

11  
12 **WHEREAS**, Sustained power outages of more than 24 hours duration are a threat to  
13 public health, safety and welfare, and especially a threat to the well-being of the senior  
14 population and persons with disabilities; and

15  
16 **WHEREAS**, During sustained power outages of more than 24 hours, the ability of  
17 Howard County to meet the emergency needs of its citizens, and especially the needs of the  
18 senior population and persons with disabilities, is compromised absent timely information of the  
19 affected locations; and

20  
21 **WHEREAS**, electrical utility providers doing business in Howard County are able to  
22 identify the locations of sustained power outages of more than 24 hours in duration;

23  
24 **NOW, THEREFORE, BE IT RESOLVED** by the County Council of Howard County,  
25 Maryland this 1<sup>ST</sup> day of October, 2012, that the Howard County Council  
26 requests that the PSC investigate the reliability of the electric power supply provided by BGE in  
27 the neighborhoods of ~~Braeburn, Burleigh Manor, Columbia, Columbia Hills, Dunloggin,~~  
28 ~~Hammond Village, Historic Ellicott City, Hollifield, Laurel, Pleasant Chase, Ridgeley's Run,~~  
29 ~~The Oaks, Turf Valley Legends, Turf Valley Vistas and Worthington~~ identified in Exhibit A to  
30 this Resolution.

1  
2           **BE IT FURTHER RESOLVED** by the County Council of Howard County, Maryland  
3 that the Howard County Council requests that the PSC direct its staff or an independent  
4 consultant selected by PSC staff and paid for by BGE to conduct an investigation of the  
5 reliability of the feeder systems that serve the neighborhoods of ~~Braeburn, Burleigh Manor,~~  
6 ~~Columbia, Columbia Hills, Dunloggin, Hammond Village, Historic Ellicott City, Hollifield,~~  
7 ~~Laurel, Pleasant Chase, Ridgeley's Run, The Oaks, Turf Valley Legends, Turf Valley Vistas and~~  
8 ~~Worthington~~ identified in Exhibit A to this Resolution.

9  
10           **BE IT FURTHER RESOLVED** by the County Council of Howard County, Maryland,  
11 that the County Solicitor is directed to take all reasonable and appropriate steps to intervene as a  
12 party in Case No. 9291 to promote efficient resolution of the complaint of the County Council  
13 without undue duplication.

14  
15           **BE IT FURTHER RESOLVED** by the County Council of Howard County, Maryland,  
16 that the Howard County Council requests that the PSC consolidate Case No. 9291 with the  
17 complaint of the County Council with Case No. 9291 regarding the neighborhoods identified on  
18 Exhibit A that are not under review in Case No. 9291 to the extent that consolidation would not  
19 unreasonably delay Case No. 9291.

20  
21           **BE IT FURTHER RESOLVED** by the County Council of Howard County, Maryland,  
22 that the Administrator of the Howard County Council shall send a copy of this Resolution to the  
23 Executive Director of the PSC in order to have an investigation begin promptly.

24  
25           **BE IT FURTHER RESOLVED** by the County Council of Howard County, Maryland,  
26 that the County Solicitor is directed to take all actions necessary to pursue the complaint of the  
27 County Council with the PSC.

28  
29           **BE IT FURTHER RESOLVED** by the County Council of Howard County, Maryland  
30 that the County Council requests that the PSC require utility providers in Howard County to

1 provide to the County Executive and to the County Council detailed information of power  
2 outages after 24 hours, to include a complete list of addresses reporting outages that have not had  
3 power restored.

4

5 **BE IT FURTHER RESOLVED** by the County Council of Howard County, Maryland,  
6 that the Administrator of the Howard County Council shall send a copy of this Resolution to the  
7 President and Chief Executive Officer of BGE and to the Senior Vice President and Chief  
8 Operating Officer of BGE.

AMENDED Exhibit A to Resolution 134-2012

20723

Hammond Village

7900 block of Helmart Drive

8000 block of Nicky Court

10600 block of Persimmon Court

Laurel

8400 through 8600 blocks of Flowering Cherry Lane

8700 block of Hidden Pool Court

10000 block of Harding Road

8200 block of Sandy Stream

10100 block of Stansfield Road

8600 block of Water Fall Drive

20794

Jessup - Pleasant Chase

Oakmead Way

Pleasant Chase Road

Summit Hill Way

Wades Way

Woodmar Lane

Jessup - Ridgeley's Run

8100-8400 blocks of Mission Road

21029

Clarksville

11500 block of Crows Nest Road

7400 block of Guilford Road

6800 block of Maiden Lane

7000 block of River Oak Court

6700 block of Surrey Lane

6600 block of Swing Court

6700 block of White Gate Road

21042

Ellicott City

10100 block of Bell Inn Lane

9800 block of Century Drive

3300, 3400, and 3500 blocks of Coventry Court Drive

2800 block of Eagles Mere Court

3100 block of Evergreen Way

3500 block of Folly Quarter Road

9900 block of Frederick Road

9400 block of Garnett Lane

3900 block of Hawthorne Road

9800 block of Middle Meadow Road

9800 block of Northbrook Court

9900 block of Oak Lea Court

3200 block of Old Fence Court

2900 block of Pinewick Court

3700 block of Plum Spring Lane

3500 block of Rhode Valley Trail

9000 Side Hill Road

8400 block of Spring Showers Way

3700 block of Tamee Circle

3100 block of The Cascades Court

9800 block of Woodbridge Court

Ellicott City - Burleigh Manor

10000 block of Camelford Court

10000 block of Culverene Road

10000 block of Galahad Court

10000 block of Inkpen Place

Ellicott City – Centennial Area

3500 block of Centennial Lane

Ellicott City - Chateau Ridge Lake

10200 block of Little Brick House Court  
3700 block of Cross Bow Court  
3600 and 3700 blocks of Chateau Ridge Drive  
10200 block of Feaga Farm Court  
3700 block of Tustin ~~Drive~~ Road

Ellicott City - Dunloggin

3500 block of North Chatham Road  
4000 block of Chatham Road  
4000 block of Crescent Road  
4000 block of Dado Court  
9000 and 9400 blocks of Dunloggin Road  
3900 block of Foxhill Drive  
3900 and 4000 blocks of Macalpine Road  
9300 block of Meadowhill Road  
9100 block of Northfield Road  
9000 block of Overhill Drive  
4000 block of Pebble Branch  
3900 and 4000 blocks of Saint John's Lane  
3700 block of Spring Meadow Drive  
3700 block of Valley Road

Ellicott City - Fairway Hills

10200 block of Fairway Drive  
10200 and 10300 blocks of Globe Drive  
10000 block of Sand Trap Court

Ellicott City - Font Hill

4000 and 4100 blocks of Arjay Circle  
10000 block of Autumn View Lane  
9800 and 9900 blocks of Carrigan Drive  
10000 block of Coehorn Court  
3600 block of Craigmont Road



3600 block of Cragsmoor Court  
3600 block of Cragsmoor Road  
3800 block of Dahlgren Court  
4000 block of Dee Jay Drive  
4100 block of Drum Circle  
9900 block of Eldee Drive  
3400, 3600, 3700, and 4000 blocks of Font Hill Drive  
3700 block of Garand Road  
3600, 3700, and 3800 blocks of Grosvenor Drive  
3400 block of Jay Drive  
4000 block of Jay Em Circle  
9900 block of Lamott Court  
9800 block of Madelaine Court  
3600 block of Morningview Court  
3800 block of Palmetto Court  
3400 block of Pierce Drive  
4200 block of Red Fox Court  
3700 block of Restmor Knoll  
3800 block of Spencer Court  
9900 block of Springfield Drive  
10000 block of Tanya Court  
9900 block of Timberknoll Lane  
3400 block of Tyler Court  
3400 block of Tyler Drive  
9900 and 10000 blocks of Whitworth Way  
9100 and 9900 blocks of Windflower Drive

Ellicott City – Gwynn Acres

9700 block of Riverside Circle

Ellicott City - Patuxent Chase

11200 block of Independence Way

Ellicott City - Stonecrest

4100 block of Flower Blossom Drive

Ellicott City - Turf Valley

2900 block of Blowing Rock Court

2900 block of Cypress Bay Court

2600 block of Golf Island Road

2600 block of Legends Way

2600 block of Turf Valley Road

2700 block of Wedge Court

Ellicott City - Valley Mede

3000 block of Ebbwood Drive

9800 block of Longview Drive

21043

Ellicott City

5100 block of Bonnie Acres

4900 block of Walking Stick Road

Ellicott City - Autumn View

4600 block of Isaac Court

4600 block of Terry Court

Ellicott City - Bethany Manor

2800 block of Foxhound Road

Ellicott City - Columbia Hills

4600 block of Dower Court

Dower Drive

4600 block of E. Leisure Court

Parkvale Court

4600 block of S. Leisure Court

9200 block of Spring Valley Road

9100 block of Sybert Drive

4600 – 7800 Westhill Road

9100 and 9200 blocks of Winding Way

Ellicott City - Historic district

3400 block of Deanwood Avenue

Ellicott City - Hollifield

2700 block of Millers Way Drive

Ellicott City - Meadowbrook Farms

4600 block of Clydesdale Court

4600 block of Dapple Court

Ellicott City - Normandy Heights

2900 block of Knoll Circle

2900 block of Normandy Drive

2800 block of Rosemar Drive

Ellicott City - Stonecrest

8600 block of Trailview Drive

Ellicott City - Taylor Village

8200 block of Academy Road

Ellicott City - The Oaks

3100 block of Edgewood Road

3100 block of The Oaks Road

Ellicott City - Wilton Acres

8900 block of Chapel Avenue

Ellicott City - Worthington

4600 block of Autumn Woods Way

4700, 4800 block of Carmen Drive

8100 block of Elberta Drive

4800 block of Ellicott Woods Lane

4700 block of Gawain Drive

4600 block of Huntley Drive

7900 block of Nottingham Way

4800 block of Rolling Top Road

4500, 4600, and 4700 blocks of Roundhill Road

4600 block of Shelley Lane

4600 block of Terry Drive

4900 block of Worthington Way

8100 block of Woodview Road

21044

Columbia - Beaverbrook

5100 block of Aver Court

5000 and 5100 blocks of Beaverbrook Road

4900 and 5000 blocks of Castle Moor Drive

5100 block of Dawn Marie Court

5000 block of Dover Court

5000, 5100, 5200, and 5300 blocks of Durham Road East

5000 and 5100 blocks of Durham Road West

5000 block of Lake Circle West

5200 block of Lynngate Road

5000 block of Teal Court

5200 block of Woodam Court

Columbia - Braeburn

10800 block of Braeburn Road

6400 block of Lochridge Road

Columbia

6400 block of Hickory Overlook

10000 block of Windstream Drive

Columbia - Sebring

6100 block of Covington Road

21045

Columbia

4900 block of Dalton Drive

9400 block of Dartmouth Road

9300 block of Diamondback Drive

5000 block 5000, 5100, 5200, and 5400 blocks of Thunder Hill Road

Columbia - Owen Brown

7000 block of Deepage Drive

21046

Columbia - Allview

6900 block of Allview Drive  
6200 and 6300 blocks of Amherst Avenue  
6300 block of Beechwood Drive  
6400 block of Belleview Drive  
6800 block of Carlinda Avenue  
10000 block of Hackberry Lane  
10000 block of Maple Avenue  
6500 block of Stephens Forest Road

Columbia - Kings Contrivance - Dickinson

7300 block of Eden Brook Drive  
7500 block of Indian Pipe  
7500 block of Midas Touch  
7500 block of New Grace Mews  
8800 block of Stonebrook Lane  
7500 block of Summer Leave Lane  
7500 block of Waterlilly Way  
Weatherworn Way (houses that back to Midas Touch)

Columbia - Kings Contrivance - Huntington

9600 block of Sea Shadow  
Green Moon Path

21075

Elkridge

6000 block of Duckey's Run Road  
6300 and 6400 blocks of Euclid Avenue  
6200 block of Grafton's View  
6200 block of Latchlift Court  
6500 and 6600 blocks of Pheasant Drive  
6200 block of Summer Home

21104

Marriottsville

1200 block of Crows Foot Road  
1200 block of Shady Creek Road

21162

Woodstock

10300 block of Cavey Lane

21794

West Friendship

2900 block of New Rover Road

Late Additions:

5200 block of Bright Dawn Court, Columbia, 21045

8700 block of Autumn Hill Drive, Ellicott City, 21043

7000 block of Golden Seeds Row, Columbia, 21044

5000 block of Lake Circle Court, Columbia, 21044

7000 block of Garden Walk, Columbia, 21044

10300 block of Burnside Drive, Ellicott City, 21042

all of Old Dobbin Lane, Columbia, 21045

Amendment to Council Resolution 134-2012

BY: Courtney Watson

Legislative Day No: 13

Date: October 1, 2012

Amendment No. 1

*(This amendment expands the places identified as having electric reliability problems and provides instructions to the County Solicitor.)*

1 On page 1, in line 27, strike “the” and substitute “many” and strike beginning with “of”  
2 down through “Worthington” in line 29 and substitute “in Howard County, including the  
3 neighborhoods under review in Case No. 9291,”.

4 On page 2, in line 1, insert a comma after “Resolution”.

5 Also on page 2, in line 5, after “supply” insert “to the neighborhoods set forth on Exhibit  
6 A to this Resolution”.

7 Also in page 2, beginning in line 26, strike “of Braeburn” down through “Worthington”  
8 and substitute “set forth in Exhibit A to this Resolution”.

9 On page 3, beginning in line 4, strike “of Braeburn” down through “Worthington” and  
10 substitute “identified in Exhibit A to this Resolution”.

11 Also on page 3, in line 8, insert “BE IT FURTHER RESOLVED by the County Council  
12 of Howard County, Maryland, that the County Solicitor is directed to take all reasonable and  
13 appropriate steps to intervene as a party in Case No. 9291 to promote efficient resolution of the  
14 complaint of the County Council without undue duplication.”.

15 Also on page 3, in line 10, after “consolidate” insert “Case No. 9291 with”.

16 Also on page 3, in line 11, strike “with Case No. 9291” and substitute “regarding the  
17 neighborhoods identified on Exhibit A that are not under review in Case No. 9291”.

18 Remove Exhibit A as attached to the Resolution and substitute the Exhibit A attached to  
19 this Amendment.

ADOPTED October 1, 2012  
FAILED  
SIGNATURE Stephen M. Tolson

AMENDED Exhibit A to Resolution 134-2012

20723

Hammond Village

7900 block of Helmart Drive

8000 block of Nicky Court

10600 block of Persimmon Court

Laurel

8400 through 8600 blocks of Flowering Cherry Lane

8700 block of Hidden Pool Court

10000 block of Harding Road

8200 block of Sandy Stream

10100 block of Stansfield Road

8600 block of Water Fall Drive

20794

Jessup - Pleasant Chase

Oakmead Way

Pleasant Chase Road

Summit Hill Way

Wades Way

Woodmar Lane

Jessup - Ridgeley's Run

8100-8400 blocks of Mission Road

21029

Clarksville

11500 block of Crows Nest Road

7400 block of Guilford Road

6800 block of Maiden Lane

7000 block of River Oak Court

6700 block of Surrey Lane

6600 block of Swing Court



6700 block of White Gate Road

21042

Ellicott City

10100 block of Bell Inn Lane

9800 block of Century Drive

3300, 3400, and 3500 blocks of Coventry Court Drive

2800 block of Eagles Mere Court

3100 block of Evergreen Way

3500 block of Folly Quarter Road

9900 block of Frederick Road

9400 block of Garnett Lane

3900 block of Hawthorne Road

9800 block of Middle Meadow Road

9800 block of Northbrook Court

9900 block of Oak Lea Court

3200 block of Old Fence Court

2900 block of Pinewick Court

3700 block of Plum Spring Lane

3500 block of Rhode Valley Trail

9000 Side Hill Road

8400 block of Spring Showers Way

3700 block of Tamee Circle

3100 block of The Cascades Court

9800 block of Woodbridge Court

Ellicott City - Burleigh Manor

10000 block of Camelford Court

10000 block of Culverene Road

10000 block of Galahad Court

10000 block of Inkpen Place

Ellicott City – Centennial Area

3500 block of Centennial Lane

Ellicott City - Chateau Ridge Lake

10200 block of Little Brick House Court  
3700 block of Cross Bow Court  
3600 and 3700 blocks of Chateau Ridge Drive  
10200 block of Feaga Farm Court  
3700 block of Tustin ~~Drive~~ Road

Ellicott City - Dunloggin

3500 block of North Chatham Road  
4000 block of Chatham Road  
4000 block of Crescent Road  
4000 block of Dado Court  
9000 and 9400 blocks of Dunloggin Road  
3900 block of Foxhill Drive  
3900 and 4000 blocks of Macalpine Road  
9300 block of Meadowhill Road  
9100 block of Northfield Road  
9000 block of Overhill Drive  
4000 block of Pebble Branch  
3900 and 4000 blocks of Saint John's Lane  
3700 block of Spring Meadow Drive  
3700 block of Valley Road

Ellicott City - Fairway Hills

10200 block of Fairway Drive  
10200 and 10300 blocks of Globe Drive  
10000 block of Sand Trap Court

Ellicott City - Font Hill

4000 and 4100 blocks of Arjay Circle  
10000 block of Autumn View Lane  
9800 and 9900 blocks of Carrigan Drive  
10000 block of Coehorn Court  
3600 block of Craigmont Road

3600 block of Cragsmoor Court  
3600 block of Cragsmoor Road  
3800 block of Dahlgren Court  
4000 block of Dee Jay Drive  
4100 block of Drum Circle  
9900 block of Eldee Drive  
3400, 3600, 3700, and 4000 blocks of Font Hill Drive  
3700 block of Garand Road  
3600, 3700, and 3800 blocks of Grosvenor Drive  
3400 block of Jay Drive  
4000 block of Jay Em Circle  
9900 block of Lamott Court  
9800 block of Madelaine Court  
3600 block of Morningview Court  
3800 block of Palmetto Court  
3400 block of Pierce Drive  
4200 block of Red Fox Court  
3700 block of Restmor Knoll  
3800 block of Spencer Court  
9900 block of Springfield Drive  
10000 block of Tanya Court  
9900 block of Timberknoll Lane  
3400 block of Tyler Court  
3400 block of Tyler Drive  
9900 and 10000 blocks of Whitworth Way  
9100 and 9900 blocks of Windflower Drive

Ellicott City – Gwynn Acres

9700 block of Riverside Circle

Ellicott City - Patuxent Chase

11200 block of Independence Way

Ellicott City - Stonecrest

4100 block of Flower Blossom Drive

Ellicott City - Turf Valley

2900 block of Blowing Rock Court

2900 block of Cypress Bay Court

2600 block of Golf Island Road

2600 block of Legends Way

2600 block of Turf Valley Road

2700 block of Wedge Court

Ellicott City - Valley Mede

3000 block of Ebbwood Drive

9800 block of Longview Drive

21043

Ellicott City

5100 block of Bonnie Acres

4900 block of Walking Stick Road

Ellicott City - Autumn View

4600 block of Isaac Court

4600 block of Terry Court

Ellicott City - Bethany Manor

2800 block of Foxhound Road

Ellicott City - Columbia Hills

4600 block of Dower Court

Dower Drive

4600 block of E. Leisure Court

Parkvale Court

4600 block of S. Leisure Court

9200 block of Spring Valley Road

9100 block of Sybert Drive

4600 – 7800 Westhill Road

9100 and 9200 blocks of Winding Way

Ellicott City - Historic district

3400 block of Deanwood Avenue

Ellicott City - Hollifield

2700 block of Millers Way Drive

Ellicott City - Meadowbrook Farms

4600 block of Clydesdale Court

4600 block of Dapple Court

Ellicott City - Normandy Heights

2900 block of Knoll Circle

2900 block of Normandy Drive

2800 block of Rosemar Drive

Ellicott City - Stonecrest

8600 block of Trailview Drive

Ellicott City - Taylor Village

8200 block of Academy Road

Ellicott City - The Oaks

3100 block of Edgewood Road

3100 block of The Oaks Road

Ellicott City - Wilton Acres

8900 block of Chapel Avenue

Ellicott City - Worthington

4600 block of Autumn Woods Way

4700, 4800 block of Carmen Drive

8100 block of Elberta Drive

4800 block of Ellicott Woods Lane

4700 block of Gawain Drive

4600 block of Huntley Drive

7900 block of Nottingham Way

4800 block of Rolling Top Road

4500, 4600, and 4700 blocks of Roundhill Road

4600 block of Shelley Lane

4600 block of Terry Drive

4900 block of Worthington Way

8100 block of Woodview Road

21044

Columbia - Beaverbrook

5100 block of Aver Court

5000 and 5100 blocks of Beaverbrook Road

4900 and 5000 blocks of Castle Moor Drive

5100 block of Dawn Marie Court

5000 block of Dover Court

5000, 5100, 5200, and 5300 blocks of Durham Road East

5000 and 5100 blocks of Durham Road West

5000 block of Lake Circle West

5200 block of Lynngate Road

5000 block of Teal Court

5200 block of Woodam Court

Columbia - Braeburn

10800 block of Braeburn Road

6400 block of Lochridge Road

Columbia

6400 block of Hickory Overlook

10000 block of Windstream Drive

Columbia - Sebring

6100 block of Covington Road

21045

Columbia

4900 block of Dalton Drive

9400 block of Dartmouth Road

9300 block of Diamondback Drive

~~5000 block~~ 5000, 5100, 5200, and 5400 blocks of Thunder Hill Road

Columbia - Owen Brown

7000 block of Deepage Drive

21046

Columbia - Allview

6900 block of Allview Drive  
6200 and 6300 blocks of Amherst Avenue  
6300 block of Beechwood Drive  
6400 block of Belleview Drive  
6800 block of Carlinda Avenue  
10000 block of Hackberry Lane  
10000 block of Maple Avenue  
6500 block of Stephens Forest Road

Columbia - Kings Contrivance - Dickinson

7300 block of Eden Brook Drive  
7500 block of Indian Pipe  
7500 block of Midas Touch  
7500 block of New Grace Mews  
8800 block of Stonebrook Lane  
7500 block of Summer Leave Lane  
7500 block of Waterlilly Way  
Weatherworn Way (houses that back to Midas Touch)

Columbia - Kings Contrivance - Huntington

9600 block of Sea Shadow  
Green Moon Path

21075

Elkridge

6000 block of Duckey's Run Road  
6300 and 6400 blocks of Euclid Avenue  
6200 block of Grafton's View  
6200 block of Latchlift Court  
6500 and 6600 blocks of Pheasant Drive  
6200 block of Summer Home

21104

Marriottsville

1200 block of Crows Foot Road  
1200 block of Shady Creek Road

21162

Woodstock

10300 block of Cavey Lane

21794

West Friendship

2900 block of New Rover Road

Late Additions:

5200 block of Bright Dawn Court, Columbia, 21045

8700 block of Autumn Hill Drive, Ellicott City, 21043

7000 block of Golden Seeds Row, Columbia, 21044

5000 block of Lake Circle Court, Columbia, 21044

7000 block of Garden Walk, Columbia, 21044

10300 block of Burnside Drive, Ellicott City, 21042

all of Old Dobbin Lane, Columbia, 21045



Amendment 1 to Amendment 1 to Council Resolution 134-2012

BY: Courtney Watson

Legislative Day No: 13

Date: October 1, 2012

Amendment 1 to Amendment No. 1

*(This amendment expands the places identified as having electric reliability problems.)*

1 On Exhibit A attached to Amendment 1,

- 2 1. Delete the reference to the 3700 block of Tustin "Drive" and substitute 3700 block of  
3 Tustin "Road".
- 4 2. Delete the reference to the "5000 block" of Thunder Hill Road and substitute "5000,  
5 5100, 5200, and 5400 blocks" of Thunder Hill Road.
- 6 3. At the end of the Exhibit, insert:

7 "Late Additions:

8 5200 block of Bright Dawn Court, Columbia, 21045

9 8700 block of Autumn Hill Drive, Ellicott City, 21043

10 7000 block of Golden Seeds Row, Columbia, 21044

11 5000 block of Lake Circle Court, Columbia, 21044

12 7000 block of Garden Walk, Columbia, 21044

13 10300 block of Burnside Drive, Ellicott City, 21042

14 all of Old Dobbin Lane, Columbia, 21045"

ADOPTED

October 1, 2012

PAIRED

SIGNATURE

Stephen McSweeney

Exhibit A to Resolution 134-2012

20723

Hammond Village

- 7900 block of Helmart Drive
- 8000 block of Nicky Court
- 10600 block of Persimmon Court

Laurel

- 8400 through 8600 blocks of Flowering Cherry Lane
- 8700 block of Hidden Pool Court
- 10000 block of Harding Road
- 8200 block of Sandy Stream
- 10100 block of Stansfield Road
- 8600 block of Water Fall Drive

20794

Jessup - Pleasant Chase

- Oakmead Way
- Pleasant Chase Road
- Summit Hill Way
- Wades Way
- Woodmar Lane

Jessup - Ridgeley's Run

- 8100-8400 blocks of Mission Road

21029

Clarksville

- 11500 block of Crows Nest Road
- 7400 block of Guilford Road
- 6800 block of Maiden Lane
- 7000 block of River Oak Court
- 6700 block of Surrey Lane
- 6600 block of Swing Court

6700 block of White Gate Road

21042

Ellicott City

10100 block of Bell Inn Lane  
9800 block of Century Drive  
3300, 3400, and 3500 blocks of Coventry Court Drive  
2800 block of Eagles Mere Court  
3100 block of Evergreen Way  
3500 block of Folly Quarter Road  
9900 block of Frederick Road  
9400 block of Garnett Lane  
3900 block of Hawthorne Road  
9800 block of Middle Meadow Road  
9800 block of Northbrook Court  
9900 block of Oak Lea Court  
3200 block of Old Fence Court  
2900 block of Pinewick Court  
3700 block of Plum Spring Lane  
3500 block of Rhode Valley Trail  
9000 Side Hill Road  
8400 block of Spring Showers Way  
3700 block of Tamee Circle  
3100 block of The Cascades Court  
9800 block of Woodbridge Court

Ellicott City - Burleigh Manor

10000 block of Camelford Court  
10000 block of Culverene Road  
10000 block of Galahad Court  
10000 block of Inkpen Place

Ellicott City – Centennial Area

3500 block of Centennial Lane

Ellicott City - Chateau Ridge Lake

10200 block of Little Brick House Court  
3700 block of Cross Bow Court  
3600 and 3700 blocks of Chateau Ridge Drive  
10200 block of Feaga Farm Court  
3700 block of Tustin Drive

Ellicott City - Dunloggin

3500 block of North Chatham Road  
4000 block of Chatham Road  
4000 block of Crescent Road  
4000 block of Dado Court  
9000 and 9400 blocks of Dunloggin Road  
3900 block of Foxhill Drive  
3900 and 4000 blocks of Macalpine Road  
9300 block of Meadowhill Road  
9100 block of Northfield Road  
9000 block of Overhill Drive  
4000 block of Pebble Branch  
3900 and 4000 blocks of Saint John's Lane  
3700 block of Spring Meadow Drive  
3700 block of Valley Road

Ellicott City - Fairway Hills

10200 block of Fairway Drive  
10200 and 10300 blocks of Globe Drive  
10000 block of Sand Trap Court

Ellicott City - Font Hill

4000 and 4100 blocks of Arjay Circle  
10000 block of Autumn View Lane  
9800 and 9900 blocks of Carrigan Drive  
10000 block of Coehorn Court  
3600 block of Craigmont Road

3600 block of Cragsmoor Court  
3600 block of Cragsmoor Road  
3800 block of Dahlgren Court  
4000 block of Dee Jay Drive  
4100 block of Drum Circle  
9900 block of Eldee Drive  
3400, 3600, 3700, and 4000 blocks of Font Hill Drive  
3700 block of Garand Road  
3600, 3700, and 3800 blocks of Grosvenor Drive  
3400 block of Jay Drive  
4000 block of Jay Em Circle  
9900 block of Lamott Court  
9800 block of Madelaine Court  
3600 block of Morningview Court  
3800 block of Palmetto Court  
3400 block of Pierce Drive  
4200 block of Red Fox Court  
3700 block of Restmor Knoll  
3800 block of Spencer Court  
9900 block of Springfield Drive  
10000 block of Tanya Court  
9900 block of Timberknoll Lane  
3400 block of Tyler Court  
3400 block of Tyler Drive  
9900 and 10000 blocks of Whitworth Way  
9100 and 9900 blocks of Windflower Drive

Ellicott City – Gwynn Acres

9700 block of Riverside Circle

Ellicott City - Patuxent Chase

11200 block of Independence Way

Ellicott City - Stonecrest

4100 block of Flower Blossom Drive

Ellicott City - Turf Valley

2900 block of Blowing Rock Court

2900 block of Cypess Bay Court

2600 block of Golf Island Road

2600 block of Legends Way

2600 block of Turf Valley Road

2700 block of Wedge Court

Ellicott City - Valley Mede

3000 block of Ebbwood Drive

9800 block of Longview Drive

21043

Ellicott City

5100 block of Bonnie Acres

4900 block of Walking Stick Road

Ellicott City - Autumn View

4600 block of Isaac Court

4600 block of Terry Court

Ellicott City - Bethany Manor

2800 block of Foxhound Road

Ellicott City - Columbia Hills

4600 block of Dower Court

Dower Drive

4600 block of E. Leisure Court

Parkvale Court

4600 block of S. Leisure Court

9200 block of Spring Valley Road

9100 block of Sybert Drive

4600 – 7800 Westhill Road

9100 and 9200 blocks of Winding Way

Ellicott City - Historic district



3400 block of Deanwood Avenue

Ellicott City - Hollifield

2700 block of Millers Way Drive

Ellicott City - Meadowbrook Farms

4600 block of Clydesdale Court

4600 block of Dapple Court

Ellicott City - Normandy Heights

2900 block of Knoll Circle

2900 block of Normandy Drive

2800 block of Rosemar Drive

Ellicott City - Stonecrest

8600 block of Trailview Drive

Ellicott City - Taylor Village

8200 block of Academy Road

Ellicott City - The Oaks

3100 block of Edgewood Road

3100 block of The Oaks Road

Ellicott City - Wilton Acres

8900 block of Chapel Avenue

Ellicott City - Worthington

4600 block of Autumn Woods Way

4700, 4800 block of Carmen Drive

8100 block of Elberta Drive

4800 block of Ellicott Woods Lane

4700 block of Gawain Drive

4600 block of Huntley Drive

7900 block of Nottingham Way

4800 block of Rolling Top Road

4500, 4600, and 4700 blocks of Roundhill Road

4600 block of Shelley Lane

4600 block of Terry Drive

4900 block of Worthington Way

8100 block of Woodview Road

21044

Columbia - Beaverbrook

5100 block of Aver Court

5000 and 5100 blocks of Beaverbrook Road

4900 and 5000 blocks of Castle Moor Drive

5100 block of Dawn Marie Court

5000 block of Dover Court

5000, 5100, 5200, and 5300 blocks of Durham Road East

5000 and 5100 blocks of Durham Road West

5000 block of Lake Circle West

5200 block of Lynngate Road

5000 block of Teal Court

5200 block of Woodam Court

Columbia - Braeburn

10800 block of Braeburn Road

6400 block of Lochridge Road

Columbia

6400 block of Hickory Overlook

10000 block of Windstream Drive

Columbia - Sebring

6100 block of Covington Road

21045

Columbia

4900 block of Dalton Drive

9400 block of Dartmouth Road

9300 block of Diamondback Drive

5000 block of Thunder Hill Road

Columbia - Owen Brown

7000 block of Deepage Drive



21046

Columbia - Allview

- 6900 block of Allview Drive
- 6200 and 6300 blocks of Amherst Avenue
- 6300 block of Beechwood Drive
- 6400 block of Belleview Drive
- 6800 block of Carlinda Avenue
- 10000 block of Hackberry Lane
- 10000 block of Maple Avenue
- 6500 block of Stephens Forest Road

Columbia - Kings Contrivance - Dickinson

- 7300 block of Eden Brook Drive
- 7500 block of Indian Pipe
- 7500 block of Midas Touch
- 7500 block of New Grace Mews
- 8800 block of Stonebrook Lane
- 7500 block of Summer Leave Lane
- 7500 block of Waterlilly Way
- Weatherworn Way (houses that back to Midas Touch)

Columbia - Kings Contrivance - Huntington

- 9600 block of Sea Shadow
- Green Moon Path

21075

Elkridge

- 6000 block of Duckey's Run Road
- 6300 and 6400 blocks of Euclid Avenue
- 6200 block of Grafton's View
- 6200 block of Latchlift Court
- 6500 and 6600 blocks of Pheasant Drive
- 6200 block of Summer Home

21104

Marriottsville

1200 block of Crows Foot Road

1200 block of Shady Creek Road

21162

Woodstock

10300 block of Cavey Lane

21794

West Friendship

2900 block of New Rover Road

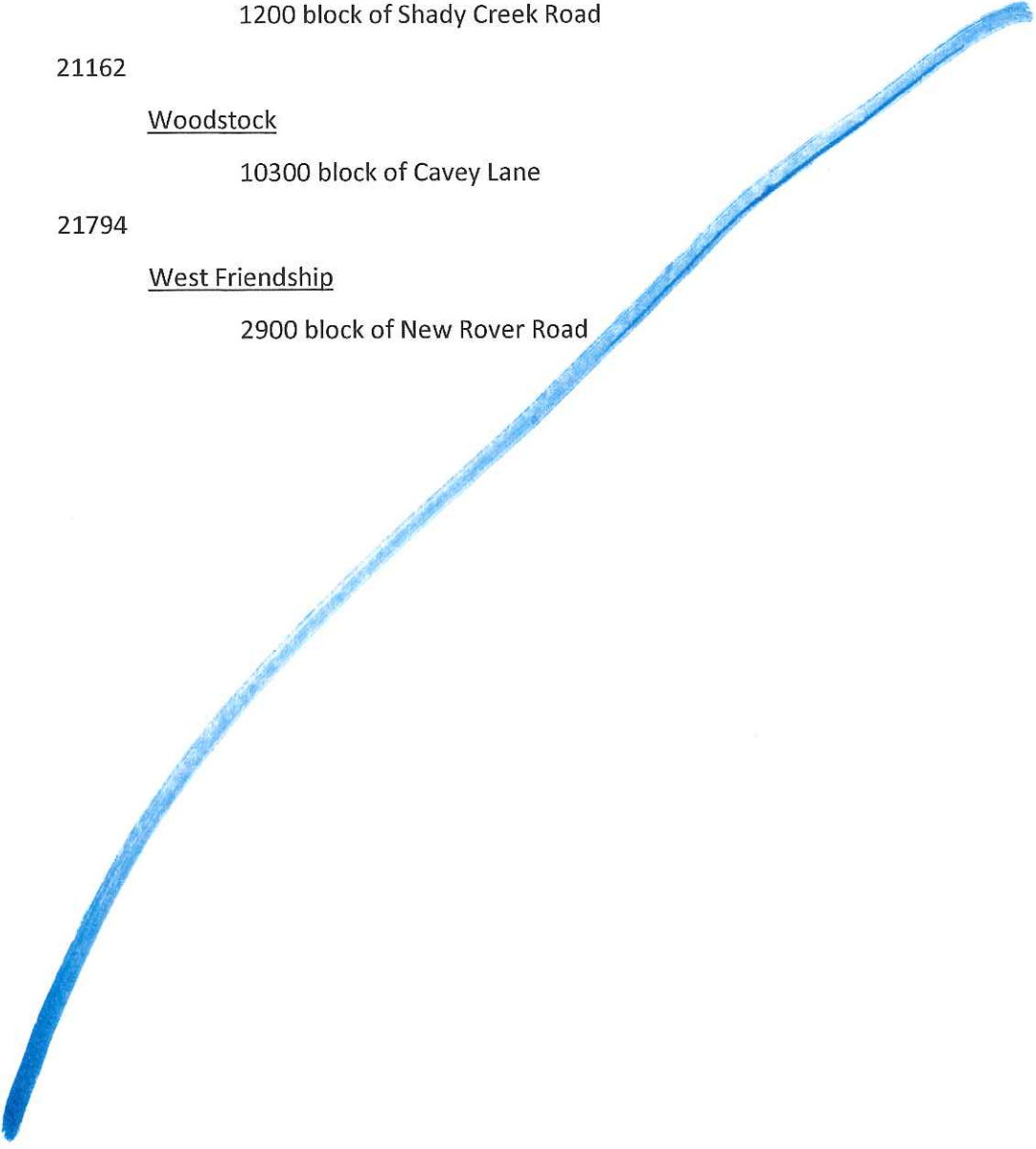

Braeburn, Columbia 21044

6400 block of Lochridge Road

Burleigh Manor, Ellicott City 21042

10000 block of Inkpen Place

10000 block of Camelford Court

Columbia 21045

9400 block of Dartmouth Road

Columbia 21046

6200, 6300 blocks of Carlinda Avenue

6300 block of Amherst Avenue

9600 block of Green Moon Path

Columbia Hills, Ellicott City 21043

4600 block of Clydesdale

4600 block of Dapple Court

4600 block of S. Leisure Court

9100, 9200 block of Winding Way

9200 block of Spring Valley Road

9100 block of Sybert Court

4600 block of Dower Court

Dower Drive

W. Hill Road

Parkvale Road

Dunloggin 21012

Chatham Road

Hammond Village 20723

7900 block of Helmart Drive

8000 block of Nicky Court

Historic Ellicott City 21043

3400 block of Deanwood Avenue

Hollifield, Ellicott City 21043

2700 block of Millers Way Drive

Laurel 20723

10100 block of Stansfield Road

Pleasant Chase, Jessup 20723

Pleasant Chase Road

Wades Way

Woodmar Lane

Oakmead Way

Chow Lane

Summit Hill Way

The Oaks, Ellicott City 21043

3100 block of The Oaks Road

Edgewood Road

Ridgeley's Run, Jessup 20794

Mission Road

Turf Valley, Ellicott City 21042

2600 block of Golf Island Road

2700 block of Wedge Court

2900 block of Blowing Rock Court

3100 block of Evergreen Way

2600 block of Legends Way

Worthington, Ellicott City 21043

4500, 4600, 4700 block of Round Hill Road

4600 block of Terry Drive

4700 block of Gawain Drive

4800 block of Rolling Top Road

4800 block of Ellicott Woods Lane

4600 block of Autumn Woods Way

4600 block of Shelley Lane

7900 block of Nottingham Way

4700, 4800 block of Carmen Drive

8100 of Elberta Drive

8100 block of Woodview Road

4900 block of Worthington Way

4600 block of Huntley Drive

# County Council of Howard County, Maryland

2012 Legislative Session

Legislative day # 11

## RESOLUTION NO. 134 - 2012

Introduced by: Courtney Watson

Cosponsored by Calvin Ball and Jennifer Terrasa

A RESOLUTION requesting the Public Service Commission of Maryland investigate the reliability of the electric power supply for certain areas in Howard County and require electrical utility providers doing business in Howard County to disclose outage information to Howard County after 24 hours; and directing certain other actions by certain County officials.

---

Introduced and read first time on \_\_\_\_\_, 2012

By order \_\_\_\_\_  
Stephen LeGendre, Administrator to the County Council

Read for a second time and a public hearing held on \_\_\_\_\_, 2012

By order \_\_\_\_\_  
Stephen LeGendre, Administrator to the County Council

This Resolution was read the third time and was Adopted \_\_, Adopted with amendments \_\_, Failed \_\_, Withdrawn \_\_ by the County Council on \_\_\_\_\_, 2012.

Certified by \_\_\_\_\_  
Stephen LeGendre, Administrator to the County Council

NOTE: [[text in brackets]] indicates deletions from existing language; TEXT IN SMALL CAPITALS indicates additions to existing language. ~~Strike out~~ indicates material deleted by amendment; Underlining indicates material added by amendment.



1           **WHEREAS**, Baltimore Gas and Electric Company (BGE) is a public service company  
2 licensed by the Public Service Commission (PSC) to conduct business in Howard County; and  
3

4           **WHEREAS**, Section 3-102 of the Public Utility Companies Article of the Maryland  
5 Code requires the PSC to conduct an investigation into the reliability of the electric power supply  
6 on complaint filed by the legislative body of a county in which an electric company is authorized  
7 to operate; and  
8

9           **WHEREAS**, Section 3-102 of the Public Utilities Article also requires the PSC to  
10 conduct an investigation into the reliability of the electric power supply on complaint filed by not  
11 less than 100 customers of the electric company; and  
12

13           **WHEREAS**, *Reliability4HOCO* filed a complaint dated February 22, 2012 with the PSC  
14 against BGE about the reliability of electric service in the neighborhoods of Font Hill, Little  
15 Patuxent Ridge, Dunmore Woods, Gwyn Acres, Dunloggin, Beaverbrook, Valley Mede,  
16 Sebring, Dalton, Green Henge, Clarksville Ridge, Turf Valley Road, Normandy Heights, The  
17 Oaks, Forest Hill Drive, Bethgate, and Worthington; and  
18

19           **WHEREAS**, On April 12, 2012, the PSC docketed the complaint filed by  
20 *Reliability4HOCO* against BGE as Case No. 9291;  
21

22           **WHEREAS**, The complaint filed by *Reliability4HOCO* also asserted that other  
23 neighborhoods in Howard County experience problems with reliability of electric service  
24 provided by BGE; and  
25

26           **WHEREAS**, The County Council, as the legislative body for Howard County, finds that  
27 the neighborhoods of Braeburn, Burleigh Manor, Columbia, Columbia Hills, Dunloggin,  
28 Hammond Village, Historic Ellicott City, Hollifield, Laurel, Pleasant Chase, Ridgley's Run, The  
29 Oaks, Turf Valley Legends, Turf Valley Vistas and Worthington as specified in Exhibit A to this

1 Resolution experience reliability problems with electric service provided by BGE; and

2  
3 **WHEREAS**, The County Council intends that this Resolution constitutes a new  
4 complaint for purposes of Section 3-102 of the Public Utility Companies Article to require the  
5 PSC to conduct an investigation of the reliability of electric power supply at the behest of the  
6 legislative body of Howard County; and

7  
8 **WHEREAS**, Howard County is charged with important public health, safety and welfare  
9 responsibilities for its citizens; and

10  
11 **WHEREAS**, Sustained power outages of more than 24 hours duration are a threat to  
12 public health, safety and welfare, and especially a threat to the well-being of the senior  
13 population and persons with disabilities; and

14  
15 **WHEREAS**, During sustained power outages of more than 24 hours, the ability of  
16 Howard County to meet the emergency needs of its citizens, and especially the needs of the  
17 senior population and persons with disabilities, is compromised absent timely information of the  
18 affected locations; and

19  
20 **WHEREAS**, electrical utility providers doing business in Howard County are able to  
21 identify the locations of sustained power outages of more than 24 hours in duration;

22  
23 **NOW, THEREFORE, BE IT RESOLVED** by the County Council of Howard County,  
24 Maryland this \_\_\_\_\_ day of \_\_\_\_\_, 2012, that the Howard County Council  
25 requests that the PSC investigate the reliability of the electric power supply provided by BGE in  
26 the neighborhoods of Braeburn, Burleigh Manor, Columbia, Columbia Hills, Dunloggin,  
27 Hammond Village, Historic Ellicott City, Hollifield, Laurel, Pleasant Chase, Ridgeley's Run,  
28 The Oaks, Turf Valley Legends, Turf Valley Vistas and Worthington.

29



1           **BE IT FURTHER RESOLVED** by the County Council of Howard County, Maryland  
2 that the Howard County Council requests that the PSC direct its staff or an independent  
3 consultant selected by PSC staff and paid for by BGE to conduct an investigation of the  
4 reliability of the feeder systems that serve the neighborhoods of Braeburn, Burleigh Manor,  
5 Columbia, Columbia Hills, Dunloggin, Hammond Village, Historic Ellicott City, Hollifield,  
6 Laurel, Pleasant Chase, Ridgeley's Run, The Oaks, Turf Valley Legends, Turf Valley Vistas and  
7 Worthington.

8  
9           **BE IT FURTHER RESOLVED** by the County Council of Howard County, Maryland,  
10 that the Howard County Council requests that the PSC consolidate the complaint of the County  
11 Council with Case No. 9291 to the extent that consolidation would not unreasonably delay Case  
12 No. 9291.

13  
14           **BE IT FURTHER RESOLVED** by the County Council of Howard County, Maryland,  
15 that the Administrator of the Howard County Council shall send a copy of this Resolution to the  
16 Executive Director of the PSC in order to have an investigation begin promptly.

17  
18           **BE IT FURTHER RESOLVED** by the County Council of Howard County, Maryland,  
19 that the County Solicitor is directed to take all actions necessary to pursue the complaint of the  
20 County Council with the PSC.

21  
22           **BE IT FURTHER RESOLVED** by the County Council of Howard County, Maryland  
23 that the County Council requests that the PSC require utility providers in Howard County to  
24 provide to the County Executive and to the County Council detailed information of power  
25 outages after 24 hours, to include a complete list of addresses reporting outages that have not had  
26 power restored.

27  
28           **BE IT FURTHER RESOLVED** by the County Council of Howard County, Maryland,  
29 that the Administrator of the Howard County Council shall send a copy of this Resolution to the

- 1 President and Chief Executive Officer of BGE and to the Senior Vice President and Chief
- 2 Operating Officer of BGE.