

County Council of Howard County, Maryland

2023 Legislative Session

Legislative Day No. **5**

Resolution No. 72 -2023

Introduced by: The Chairperson at the request of the County Executive

A RESOLUTION approving schedules of fees for the functions regulated by the Department of Public Works.

Introduced and read first time _____, 2023.

By order _____
Michelle Harrod, Administrator

Read for a second time at a public hearing on _____, 2023.

By order _____
Michelle Harrod, Administrator

This Resolution was read the third time and was Adopted___, Adopted with amendments___, Failed___, Withdrawn___, by the County Council on _____, 2023.

Certified By _____
Michelle Harrod, Administrator

NOTE: [[text in brackets]] indicates deletions from existing law; TEXT IN SMALL CAPITALS indicates additions to existing law; ~~Strike-out~~ indicates material deleted by amendment; Underlining indicates material added by amendment

1 **WHEREAS**, Section 14.600 and Section 14.601 of the Howard County Code provide
2 that, upon the recommendation of the Director of Public Works, the County Council shall adopt
3 an annual schedule of permit charges, user fees, special charges and late payment penalties for
4 users of the Howard County Sanitary Landfill; and

5
6 **WHEREAS**, Section 18.700 requires the Director of Public Works to prepare a proposed
7 fee schedule to cover the cost of services performed by the Department of Public Works related
8 to the physical inspection and approval of infrastructure in subdivisions and site development
9 plans as shown on the approved subdivision and site development plans; and

10
11 **WHEREAS**, Section 16.130 of the Howard County Code requires developers to pay for
12 the costs of public improvements (water and sewer facilities) required by Section 16.131, which
13 costs include the costs incurred by the Department of Public Works in reviewing the plans for the
14 facilities; and

15
16 **WHEREAS**, Section 18.204 of the Howard County Code requires that the Council set,
17 by annual resolution, a fee to cover notification costs incurred by the County when a road is
18 petitioned for closing or relocation; and

19
20 **WHEREAS**, Section 18.206 and 18.206A of the Howard County Code requires utility
21 contractors, wireless providers and other persons who excavate in the public roads and rights-of-
22 way or use public street lights to obtain a permit for the work, and further provides for County
23 Council approval of a fee for such a permit; and

24
25 **WHEREAS**, by the passage of Council Resolution No. 15-2022, the fees for Utility
26 Construction permits were amended; and

27
28 **WHEREAS**, Section 18.402 of the Howard County Code provides that abutting property
29 owners shall repair or replace sidewalk that is unsafe for public use and further provides that, at
30 the abutting property owner's request, the Department of Public Works may do the sidewalk
31 repair or replacement and bill the property owner for the cost of the work; and

1
2
3
4
5
6
7
8
9
10
11
12
13
14
15
16
17
18
19
20
21
22
23
24
25
26
27
28
29
30

WHEREAS, even though in certain circumstances it is appropriate to amend or extend developer agreements, the County incurs costs in reviewing the agreement and the development to determine whether appropriate progress has been made in meeting the requirements of the Agreement, and therefore charges a fee for approving the amendment or extension of the developer agreement; and

WHEREAS, Section 21.208 of the Howard County Code authorizes the County Council to establish by resolution an annual service fee and the cost of installation of signs when the Department of Public Works issues a permit to establish a loading zone; and

WHEREAS, Section 3.405 of the Howard County Code requires an applicant to provide surety for grading and constructing sediment control; and

WHEREAS, Section 20.901 of the Howard County Code requires the County Council to establish by Resolution the refuse collection charges for residential and commercial property, and to establish the Ellicott City Refuse Collection Zone; and

WHEREAS, Section 16.511 of the Howard County Code provides that the mobile home park refuse collection charge shall be adopted by Resolution of the County Council; and

WHEREAS, Section 21.206 and Section 21.236 of the Howard County Code authorize the Department of Public Works to establish parking meter zones and prohibit a person from parking in a parking meter zone unless the appropriate fee is paid; and

WHEREAS, fees for functions regulated by the Department of Public Works were last adopted by the passage of Council Resolution No. 63-2022 and there are changes for Fiscal Year 2024 to the residential trash and recycling fees and a correction is made reflect the actual number of commercial trash collections in the Ellicott City Refuse Collection Zone Only.

1 **NOW, THEREFORE, BE IT RESOLVED** by the County Council of Howard County,
2 Maryland this ___ day of _____, 2023 that it adopts the fee schedules attached to this
3 Resolution for the following functions regulated through the Department of Public Works:

- 4 (1) Review and approval of water and sewer facilities for subdivisions and site development;
- 5 and
- 6 (2) Miscellaneous DPW Fees and Charges; and

7
8 **BE IT FURTHER RESOLVED** that the fee schedules shall be effective July 1, 2023
9 and shall continue in effect until changed or repealed by subsequent resolution.

LANDFILL FEES

These fees are adopted pursuant to Section 14.600 and Section 14.601 of the Howard County Code, which provide that the County Council shall adopt an annual schedule of permit charges, user fees, special charges, and late payment penalties for users of the Howard County Sanitary Landfill.

NOTE: No solid waste generated from out-of-County sources will be accepted at the Howard County Alpha Ridge Landfill.

ANNUAL PERMIT CHARGE

Commercial permit (renewable each June)	\$30
Commercial Recycling Permit	No Charge

USER CHARGES

Residential solid waste

No charge for Howard County residents bringing solid waste to the landfill in:

- (1) Vehicles up to 3/4 ton GVW registered in Howard County; or
- (2) Vehicles registered as farm vehicles with the Motor Vehicle Administration hauling qualifying waste.

Residents bringing in household waste must apply for a special exception permit if vehicle is not registered as a farm vehicle, is over 3/4 ton GVW, is not registered to resident, or displays commercial signage.

A maximum of 2 tons of household waste will be accepted from a County resident at no charge during a 1-year period from July through June. Residential users shall be charged for quantities exceeding 2 tons per fiscal year based on the rates below.

Residential construction and demolition debris \$80 per ton

Clean dirt

Clean dirt free of trash and rubble \$100 per ton
(charge may be waived or volume may be limited by the Department of Public Works)

Clean Wood/Yard Trim clean wood trim includes brush, tree branches, unpainted and untreated lumber, grass, leaves and barn cleanings.

Residential	No charge
Commercial (After verification that wood waste is clean)	\$30 per ton

Commercial solid waste (tires must be delivered separately) \$80 per ton

Commercial Auto and truck tires

Auto tires	\$160 per ton
------------	---------------

Truck (oversized) tires	\$220 per ton
Commercial mattresses and box springs (Mixed with Trash- Disposed)	\$100 per ton
Commercial mattresses and box springs (Clean Loads- Recycled)	\$50 per ton
Commercial cardboard (Mixed with trash- Disposed)	\$100 per ton
Commercial appliances with Freon	\$10 each
Broken paving, stone or brick	\$100 per ton
Boats, house trailers and campers All Boats, House Trailers and Campers not to exceed 30 feet in length. Acceptance may be limited by the Department of Public Works.	\$80 per ton

SCHEDULE FOR USE WHEN SCALES ARE INOPERATIVE

Size of Vehicle	Solid Waste	Recyclable Yard/Wood Waste
Pickup trucks & leisure vans (1/2 to 3/4 ton)	\$32	\$8
Pickup trucks with side rails, caps, or dump bed	\$65	\$15
Dump trucks (2 axle)	\$190	\$45
Dump trucks (3 or 4 axle)	\$320	\$75
Closed vans (2 axle)	\$130	\$30
Closed vans (3 or 4 axle)	\$190	\$45
Stake body/open body trucks or trailer dump (2 axle)	\$320	\$75
Stake body/open body trucks or trailer dump (3 axle)	\$380	\$90
Front, rear and side load compactor		
under 16 cu.yd.	\$320	\$75
16-23 cu.yd.	\$500	\$120
24 cu.yd. and over	\$600	\$150
Semi-trailer	Not Accepted	\$300
Roll off bed		
under 25 cu.yd.	\$500	\$90
25 - 34 cu.yd.	\$600	\$150
35 cu.yd. and over	\$800	\$225
Auto and Truck Tires		
Auto tires		
Up to 30 tires	\$90 flat rate	
Over 30 tires	\$3.25 per tire	
Truck (oversized) tires		
Up to 10 tires	\$60 flat rate	
Over 10 tires	\$6.00 per tire	

NOTE: A maximum of four (4) auto tires per visit may be delivered to the Resident's Convenience Area by residents at no charge. Farm vehicles are also limited to four (4) auto tires per visit. Deliveries of greater than 4 tires will be charged the per ton commercial user charge.

SPECIAL LANDFILL CHARGES

Credit account deposit (amount to be paid before credit is initially extended)	\$200.00 minimum
Credit account deposit - maintenance surety (amount for maintaining extension of credit; reviewed and adjusted every 6 months)	1.5 times average monthly statement
Late payment penalty assessed on the last County work day of the month following the month on which charges are billed. All statements will indicate the penalty date.	10% of unpaid balance –every 30 days balance is due
Service charge for failure to weigh out	\$ 25.00, Plus rate per ton calculated using waste type and vehicle's tare weight
Commercial vehicles remaining after closing time Or unloading longer than the 30-minute time limit	\$100 per 30 minutes

REFUSE COLLECTION CHARGES

These charges are adopted pursuant to Section 20.901 of the Howard County Code, which requires the County Council to establish by Resolution the refuse and recycling collection charges for residential and commercial property, and to establish the Ellicott City Refuse Collection Zone.

Refuse Collection Charges	
Residential Property	[[310]]\$350 per year for 1 collection per week of refuse and recyclable materials
Residential Property	\$15 per year for 1 collection per week of yard waste and food scraps, where applicable, during the collection season
Residential Property – Private Roads	[[39]]\$55 per year for 1 collection per week of recyclable materials only. The entire community must “opt out” or charge will be assessed on each individual homeowner.
Commercial Property – Ellicott City Refuse Collection Zone Only	\$310 per year for each collection, [[2 or 4]]5 collections per week
Mobile Home Park	\$17.50 per month for 1 collection per week of refuse and recyclable materials (charge based on the number of occupied, permitted sites)
Mobile Home Park	\$1.25 per month for 1 collection per week of yard waste during the collection season (charge based on the number of occupied, permitted sites)
Mobile Home Park	\$3.25 per month for 1 collection per week of recyclable materials only (charge based on the number of occupied, permitted sites)

The Department of Public Works Refuse and Recyclables Collection Rules shall govern the size and weight of acceptable items, and the composition of containers.

Commercial Property is property in Ellicott City Refuse Collection Zone.

ELLICOTT CITY REFUSE COLLECTION ZONE

The Service area boundary for the Commercial Property for which the County provides refuse collection services is the Ellicott City Refuse Collection Zone. The Zone is defined in Exhibit A which is attached hereto and incorporated herein.

**DEPARTMENT OF PUBLIC WORKS
ENGINEERING REVIEW FEE SCHEDULE
Effective July 1, 2023**

These fees are pursuant to Section 16.130 and Section 16.131 of the Howard County Code, which requires developers to pay for the costs of public improvements (water and sewer facilities), which costs include the costs incurred by the Department of Public Works in reviewing the plans for the facilities:

COMMERCIAL, INDUSTRIAL & MULTI-FAMILY SITE DEVELOPMENT PLANS		
Total Estimated Site Construction Costs	Fee For Private Roads, Parking Lots & Storm Water Management**	Fee For Private Storm Drains, Water & Sewer**
Less than \$ 50,000	2.75%	0.8%
\$ 50,001 - \$150,000	2.50%	0.7%
\$150,001 - \$250,000	2.25%	0.6%
over \$250,000	2.00%	0.5%

**

1. Fees represent half of the total fee charged. The total fee is shared between DPW and DPZ.
2. A partial advance fee is to be paid in full prior to submission of plan for signature approval. This partial fee shall be 50% of the fee based upon the developer's preliminary construction cost estimate. The minimum fee is \$100.
3. The final fee is calculated based on actual construction quantities and the Howard County Department of Planning and Zoning's approved unit prices and item codes, dated July 1, 2023 (see attached exhibit 1).
4. Final fee is to be paid in full prior to submission of plan for signature approval.

FINAL SUBDIVISIONS WITH PUBLIC ROADS AND STORM DRAINAGE STRUCTURES	
Cost of Improvements	Fee*
Less than \$50,000	2.75% but not less than \$100
\$50,001 - \$150,000	2.5%
\$150,001 - \$250,000	2.25%
Over \$250,000	2%

*

1. Fees represent half of the total fee charged. The total fee is shared between DPW and DPZ.
2. A partial advance fee is to be paid in full prior to submission of plan for signature approval. This partial fee shall be 50% of the fee based upon the developer's preliminary construction cost estimate. The minimum fee is \$100.
3. The final fee is calculated based on actual construction quantities and the Howard County Department of Planning and Zoning approved unit prices and item codes, dated July 1, 2023 (see attached exhibit 1).
4. Final fee is to be paid in full prior to submission of plan for signature approval.

REVIEW OF SUBDIVISIONS AND SITE DEVELOPMENT PLANS WATER & SEWER FACILITIES		
Work To Be Done	Partial Advance Fee	Total Fee
Review of water or sewer systems, including engineering, administrative and legal costs associated with the review.	1.75% of DPZ's established unit cost for sewer main and established unit cost for water main and fire hydrant (attached as "Exhibit 1"). Must be deposited with application for preliminary plan approval based on quantities shown on developer's preliminary plan.	3.5% of DPZ's established unit cost for sewer main and established unit cost for water main and fire hydrant (attached as "Exhibit 1"), based on quantities shown on developer's approved construction drawings and paid prior to delivery of developer agreement for execution.

Total fee of 7% is shared fees between DPZ and DPW

**REVIEW AND APPROVAL OF WATER & SEWER FACILITIES
FOR SUBDIVISIONS AND SITE DEVELOPMENT**

These fees are adopted pursuant to Section 16.130 of the Howard County Code which requires developers to pay for the costs of public improvements (water and sewer facilities) required by Section 16.131, which costs include the costs incurred by the Department of Public Works in reviewing the plans for the facilities and in inspecting them during construction.

Construction Inspection of Private and Public Water and Sewer

WORK	CHARGE* (NON-REBATABLE)
Single Family Detached (ex: R-12, R-20, etc.) No Minor Subdivisions	\$600 per lot
Townhome, Cluster Home No Minor Subdivisions	\$250 per lot
Minor Subdivisions, Site Development Plans, etc.	\$800 Lump Sum Administration and Project Coordination Fee, plus \$7 per linear foot Field Inspection Fee.
Inspection of private water & sewer 8" or larger (from the connection to within 5 feet of the building improvement).	\$800 Lump Sum Administration and Project Coordination Fee, plus \$7 per linear foot Field Inspection Fee.
TV Inspection	\$.60 per foot, to be paid prior to delivery of developer agreement for execution.

* These fees cover the costs associated with the inspection of water and sewer facilities during the construction time established in the developer agreement and construction documents. If construction time exceeds the established time, additional inspection fees will be charged in the amount of 1.5% of the total estimated construction costs included in the developer agreement with a minimum fee of \$1,500.

RIGHT-OF-WAY UTILITY CONSTRUCTION PERMITS

These fees are adopted pursuant to Section 18.206 and Section 18.206A of the Howard County Code, which requires utility contractors, wireless providers and other persons who excavate in the public roads and rights-of-way or use public street lights to obtain a permit for the work, and further provides for County Council approval of a fee for such a permit.

These fees apply only to power and communication utility work in existing subdivisions and existing public rights-of-way and easements. The construction permit fees do not apply to utility construction in projects being constructed in accordance with the subdivision regulations.

Annual Fee for Use of Howard County Right-of-Way in accordance with Agreement for Use of Howard County Right-of-Way.

Gas or electric utility	\$36,000 per year, or \$10,000 per year for a gas or electric utility company serving up to and including 3,000 Howard County customers
Communication utility	\$25,000 per year or \$1 per year for a permitted wireless facility that is solely above ground and whose underground cable is provided by a permitted communication utility that paid the \$25,000 per year fee.

Permit Fee for Underground Utility Construction. *Repair, maintenance and/or new utility* construction permit review fee for the processing of the Permit in accordance with an Agreement for Use of Howard County Right-of-Way.

\$300 each permit review

Permit Fee for Underground Utility Construction. *New utility construction* permit review fee for the processing a single Permit for a utility that is not operating under an Agreement for Use of Howard County Right-of-Way.

\$600 each permit review

Permit Fee for Street Light Attachment. Review fee for the processing of a *wireless facility street light attachment* under an Agreement for Use of Howard County Street Lights.

\$3000 each permit review

Reinspection surcharge

A reinspection surcharge shall be imposed for utility installation sites which required more than one reinspection to verify or determine compliance with a notice of violation issued.

2nd reinspection (3rd visit to property) \$100

3rd reinspection (4th visit to property) \$150

4th reinspection (5th visit to property) \$200

Installing utilities without a permit

Charge for new utility construction in existing public rights-of-way without the required permit.

\$500 each occurrence

LOADING ZONE PERMIT/SIGN INSTALLATION FEES

These fees are established pursuant to Section 21.208 of the County Code, which authorizes the County Council to establish an annual service fee and the cost of installation of signs when the Department of Public Works issues a permit to create a loading zone.

Cost of installation of signs indicating the border of a loading zone established under a permit.

\$160 per sign.

Annual service fee for a loading zone permit.

\$25 per year or portion of a year.

GRADING SURETY

These fees are adopted pursuant Section 3.405 of the Howard County Code that requires an applicant to provide surety for grading and constructing sediment control

Surety shall be based on the size of the area to be disturbed and the type of construction. The amount of the surety shall be determined using the following schedule:

Residential/utility grading	\$300 for the 1 st 5000 sq. ft. plus \$.02 for each additional square foot of disturbed area
Commercial/industrial grading	\$2,500 for the 1 st 5000 sq. ft. plus \$.04 for each additional square foot of disturbed area

PARKING METER RATES

These rates are adopted pursuant to Sections 21.206 and 21.236 of the Howard County Code, which authorize the Department of Public Works to establish parking meter zones, and which prohibit a person from parking a vehicle in a parking meter zone unless the applicable rates have been paid.

Location of Parking Meters	Parking Meter Fee
George Howard Complex	Up to \$.25 per hour per space
Ellicott City Post Office Lot	Up to \$.50 per hour per space
Patapsco River Lot in Ellicott City	Up to \$.50 per hour per space
Maryland Ave. Lot in Ellicott City	Up to \$.50 per hour per space
Maryland Ave. (On-street)	Up to \$1.00 per hour per space
Talbot Lot in Ellicott City	Up to \$.50 per hour per space
Main Street, Ellicott City	Up to \$1.00 per hour per space

MISCELLANEOUS DPW FEES AND CHARGES

SERVICE

COST

Sidewalk repair/replacement	Actual cost to the County
Amendment, extension, or revision of Developer Agreements	
Cost for a project with up to 4 agreements	\$400 per agreement
Cost for a project with 5 or more agreements	\$1,600 per project
Petition for road closing/road relocation	\$1,500
Additional recycling containers	
18 gallon	\$7.50 each
35 gallon	\$36.00 each
65 gallon	\$45.00 each

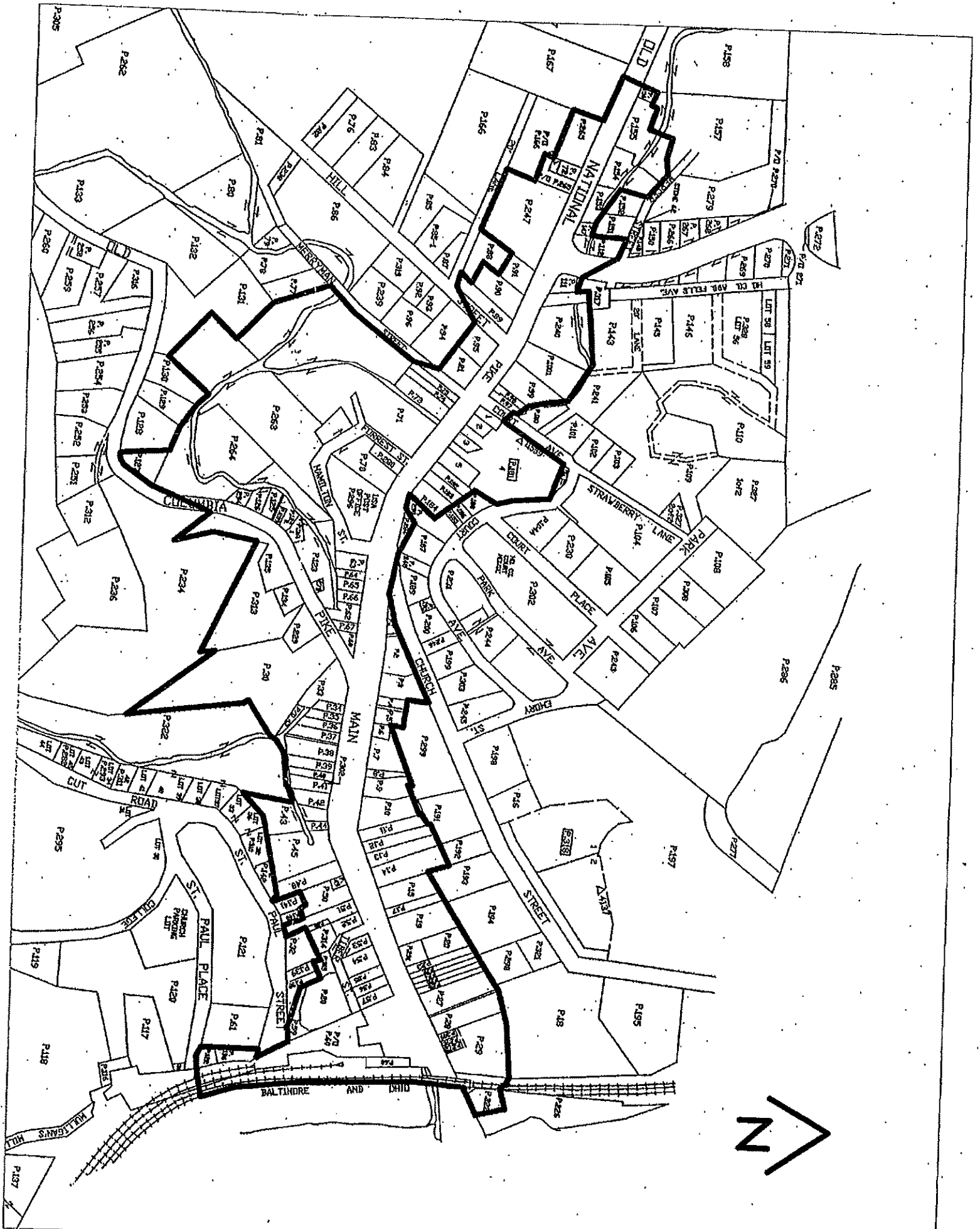

HOWARD COUNTY - DEPARTMENT OF PLANNING AND ZONING
APPROVED UNIT PRICES AND ITEM CODES
(County Council Resolution # -2023)
Effective Date: 7/1/2023

ITEM CODE	DESCRIPTION	UNIT	UNIT COST
GENERAL			
110100	Clearing & Grubbing (based on clearing wooded areas only)	AC	\$5,000.00
110101	Tree Removal - Under 10" Diameter	EA	\$275.00
110102	Tree Removal - 10" to 15" Diameter	EA	\$345.00
110103	Tree Removal - 15" to 30" Diameter	EA	\$690.00
110104	Tree Removal - Greater than 30" Diameter	EA	\$1,625.00
110105	Transplant Street Trees	EA	\$135.00
110106	Abandon Existing Well	LS	\$2,000.00
110200	Removal & Disposal of Existing Buildings (specific based on size & materials)	LS	\$10,300.00
110201	Engineers Office Type A	LS	\$20,000.00
110202	Engineers Office Type B	LS	\$24,000.00
110203	Engineers Office Type C	LS	\$34,000.00
110204	Cellular Telephone	EA	\$19.00
110205	Portable Toilet (Per Month)	MO	\$95.00
110206	Digital Camera	EA	\$1,000.00
MAINTENANCE OF TRAFFIC			
110300	5" Yellow Nontoxic Lead Free Waterborne Pavement Marking Paint	LF	\$0.25
110301	5" White Nontoxic Lead Free Waterborne Pavement Marking Paint	LF	\$0.25
110302	10" Yellow Nontoxic Lead Free Waterborne Pavement Marking Paint	LF	\$0.25
110303	10" White Nontoxic Lead Free Waterborne Pavement Marking Paint	LF	\$0.25
110304	12" White Nontoxic Lead Free Waterborne Pavement Marking Paint	LF	\$1.00
110305	16" White Nontoxic Lead Free Waterborne Pavement Marking Paint	LF	\$2.00
110306	24" White Nontoxic Lead Free Waterborne Pavement Marking Paint	LF	\$4.80
110310	4" Yellow Removable Preformed Pavement Line Markings	LF	\$1.20
110311	4" White Removable Preformed Pavement Line Markings	LF	\$1.50
110312	5" Yellow Removable Preformed Pavement Line Markings	LF	\$1.25
110313	5" White Removable Preformed Pavement Line Markings	LF	\$1.25
110314	10" Yellow Removable Preformed Pavement Line Markings	LF	\$2.50
110315	10" White Removable Preformed Pavement Line Markings	LF	\$2.50
110316	12" White Removable Preformed Pavement Line Markings	LF	\$4.25
110317	16" White Removable Preformed Pavement Line Markings	LF	\$5.30
110318	24" White Removable Preformed Pavement Line Markings	LF	\$7.65
1103320	Removable Preformed Letters	EA	\$70.00
1103321	Removable Preformed Symbols	EA	\$275.00
1103322	Removable Preformed Arrows	EA	\$233.00
1103323	Removable Preformed Numbers	EA	\$233.00
1103324	Removal of Removable Preformed Letters, Symbols, Arrows and Numbers	EA	\$452.00
1103325	Removal of Removable Preformed Pavement Markings - Any Width	LF	\$0.13
110330	8" Removable Patterned Black Line Mask Tape for Maintenance of Traffic	LF	\$3.00
110340	Maintenance of Traffic	LS	\$33,000.00
110341	Bank Run Gravel Subbase for Maintenance of Traffic	TON	\$22.50
110342	Graded Aggregate Subbase for Maintenance of Traffic	TON	\$15.00
110343	Crusher Run Aggregate CR-6 for Maintenance of Traffic	TON	\$22.50
110344	Graded Aggregate Base for Maintenance of Traffic	TON	\$22.50
110345	Hot Mix Asphalt for Maintenance of Traffic	TON	\$95.00
110346	Hot Mix Asphalt Curb for Maintenance of Traffic	LF	\$5.50
110347	Steel Plate 8"x12"x1" max. for Maintenance of Traffic (Per Day)	EA/DY	\$5.00

HOWARD COUNTY - DEPARTMENT OF PLANNING AND ZONING
APPROVED UNIT PRICES AND ITEM CODES
(County Council Resolution # -2022)
Effective Date: 7/1/2022

ITEM CODE	DESCRIPTION	UNIT	UNIT COST
110350	Traffic Manager	DY	\$150.00
110351	Arrow Panel	UD	\$38.75
110352	Portable Flashing Arrow Panel	DY	\$38.75
110353	Temporary Traffic Signs Type III Retro reflective Sheeting	SF	\$12.50
110354	Temporary Traffic Signs High Performance Wide Angle Retro reflective Sheeting	SF	\$22.50
110355	Temporary Raised Pavement Markers	EA	\$6.25
110356	Signs for Maintenance of Traffic (Rental)	DY	\$10.00
110357	Removal of Temporary Raised Pavement Markers	EA	\$0.75
110358	Traffic Cones - 28" with Retro reflective Bands (Rental)	DY	\$43.75
110359	Removal of Existing Painted Stripe Markings - Any Width (Grinding)	LF	\$1.25
110360	4" Temporary Pavement Striping Tape	LF	\$1.30
110361	5" Temporary Pavement Striping Tape	LF	\$1.75
110362	6" Temporary Pavement Striping Tape	LF	\$1.75
110363	8" Temporary Pavement Striping Tape	LF	\$2.35
110364	Removal of Temporary Pavement Striping Tape- Any Width	LF	\$0.19
110365	Removal of Existing Pavement Markings - Any Width	LF	\$18.75
110366	Remove Existing Word Markings (Each Letter)	EA	\$12.50
110367	Remove Existing Stop Bars - 24"	LF	\$5.00
110368	Tubular Markers	EA	\$94.00
110369	Replacement of Tubular Marker Mast	EA	\$55.00
110370	Cones for Maintenance of Traffic	EA	\$20.00
110380	Temporary Concrete Single Face Traffic Barrier for Maintenance of Traffic	LF	\$20.00
110381	Temporary Precast Concrete Traffic Barrier for Maintenance of Traffic	LF	\$16.25
110382	Reset Temporary Concrete Barrier Single Face	LF	\$13.75
110383	Precast Temporary Concrete Traffic Barrier Transition Left Side	EA	\$5,000.00
110384	Precast Temporary Concrete Traffic Barrier Transition Right Side	EA	\$5,000.00
110385	Reset Temporary Precast Concrete Traffic Barrier for Maintenance of Traffic	LF	\$4.00
110386	Reflective Barrier Markers	EA	\$6.75
110387	Removal of Reflective Barrier Markers	EA	\$1.25
110388	Traffic Barrier W Beam for Maintenance of Traffic	LF	\$62.50
110389	Wooden Barricade for Pedestrian Control	LF	\$40.00
110390	Traffic Barrier W Beam Replacement for Maintenance of Traffic	LF	\$50.00
110391	Reset Traffic Barrier W Beam for Maintenance of Traffic	LF	\$37.50
110392	Type I Barricade for Maintenance of Traffic - 6' Length	EA	\$250.00
110393	Type II Barricade for Maintenance of Traffic - 6' Length	EA	\$265.00
110394	Type III Barricade for Maintenance of Traffic - 6' Length	EA	\$280.00
110395	Replace Type III Barricade for Maintenance of Traffic	EA	\$275.00
110400	Flagger	HR	\$15.65
110401	Temporary Crash Cushion Sand Filled Plastic Barrels for Maintenance of Traffic	BBL	\$350.00
110402	Replace Temporary Crash Cushion Sand Filled Plastic Barrels for Maintenance of Traffic	BBL	\$331.25
110403	Vertical Panels	EA	\$61.25
110404	Warning Lights	EA	\$86.25
110405	Remove & Reset Temporary Crash Cushion Sand Filled Plastic Barrels for Maintenance of Traffic	BBL	\$116.25
110406	Relocate Wood Sign Supports	EA	\$31.25
110407	Sign Modifications to Overhead Sign Structures	SF	\$12.50
110408	Relocate Sign	SF	\$31.25
110409	Remove Sign	SF	\$3.75

HOWARD COUNTY - DEPARTMENT OF PLANNING AND ZONING
APPROVED UNIT PRICES AND ITEM CODES
(County Council Resolution # -2022)
Effective Date: 7/1/2022

ITEM CODE	DESCRIPTION	UNIT	UNIT COST
110410	Remove and Relocate Existing Signs	SF	\$13.75
110411	Install or Remove Shield	EA	\$30.00
110412	Cover Sign	SF	\$2.50
110413	Relocate Sign Luminaires	EA	\$31.25
110414	Remove and Salvage Existing Sign	EA	\$125.00
110415	Temporary Orange Construction Fence	LF	\$2.00
110416	Remove & Reset Temporary Orange Construction Fence	LF	\$2.00
110417	Temporary Crash Cushion Telescoping Attenuator	EA	\$17,500.00
110418	Remove and Reset Temporary Crash Cushion Telescoping Attenuator	EA	\$1,875.00
110419	Temporary Crash Cushion Telescoping Attenuator Spare Parts Package	EA	\$8,750.00
110420	Water Filled Barrier for Maintenance of Traffic	LF	\$10.00
110421	Replacement Sections for Movable Type Concrete Barrier	EA	\$825.00
110422	Drums for Maintenance of Traffic	EA	\$62.50
110423	Replacement of Drums for Maintenance of Traffic	EA	\$77.50
110424	Temporary Movable Type Concrete Traffic Barrier	LF	\$16.50
110425	Portable Variable Message Sign	UD	\$135.00
110426	Protection Vehicle w/Truck Mounted Attenuator, Variable Message Sign & Intrusion Alarm	UD	\$750.00
110427	Truck Mounted Attenuator	UD	\$225.00
110440	Temporary Type E Traffic Barrier End Treatment 3 Bays, Any Width	EA	\$5,200.00
110441	Temporary Type E Traffic Barrier End Treatment 4 Bays, Any Width	EA	\$5,800.00
110442	Temporary Type E Traffic Barrier End Treatment 6 Bays, Any Width	EA	\$16,000.00
110443	Temporary Type E Traffic Barrier End Treatment 8 Bays, Any Width	EA	\$20,000.00
110444	Temporary Type E Traffic Barrier End Treatment 9 Bays, Any Width	EA	\$25,000.00
110445	Remove & Reset Temporary Type E Traffic Barrier End Treatment, Any Bays, Any Width	EA	\$1,500.00
110446	Temporary Type E Traffic Barrier End Treatment 12 Bays, Up To 3 Feet Wide	EA	\$20,000.00
110447	Temporary Type J Traffic Barrier End Treatment 4 Cylinders	EA	\$12,000.00
110448	Temporary Type J Traffic Barrier End Treatment 9 Cylinders	EA	\$16,000.00
110449	Precast Temporary 32 inch F Shape Concrete Traffic Barrier Transition Left Side Approach	EA	\$8,000.00
110450	Precast Temporary 32 inch F Shape Concrete Traffic Barrier	LF	\$20.00
EARTHWORK			
201000	Trim Existing Ditches	LF	\$7.00
201001	Class 1 Excavation	CY	\$7.00
201002	Class 1-A Excavation	CY	\$12.50
201003	Class 2 Excavation	CY	\$12.50
201004	Class 3 Excavation	CY	\$15.00
201005	Class 5 Excavation	CY	\$15.00
201006	Geosynthetic Stabilized Subgrade Using Graded Aggregate Base	CY	\$30.00
201007	Unclassified Excavation	CY	\$7.00
201008	Disposal of Petroleum Contaminated material	CY	\$70.00
201010	Select Borrow	CY	\$20.75
201011	Capping Borrow	CY	\$28.75
201012	Modified Borrow	CY	\$11.25
201013	Common Borrow	CY	\$8.75
201014	Tamped Fill	CY	\$30.00
201020	Test Pit Excavation	CY	\$75.00
201030	Settlement Plates (ea)	DY	\$5.00
201040	Dredging	CY	\$30.00

HOWARD COUNTY - DEPARTMENT OF PLANNING AND ZONING
APPROVED UNIT PRICES AND ITEM CODES
(County Council Resolution # -2022)
Effective Date: 7/1/2022

ITEM CODE	DESCRIPTION	UNIT	UNIT COST
PAVEMENT, STORM DRAIN & UTILITY REMOVAL			
210000	Removal of Existing Curb (Any Type)	LF	\$5.00
210001	Removal of Existing Combination Curb & Gutter	LF	\$5.00
210002	Remove Existing Asphalt Curb	LF	\$1.25
210003	Sawcut - 2" Deep	LF	\$2.50
210004	Sawcut - Full Depth	LF	\$5.00
210005	Remove Existing Bituminous Pavement	SY	\$7.50
210006	Remove Existing Sidewalk	SY	\$4.00
210007	Removal of Paved Ditches	SY	\$4.00
210008	Remove Existing Concrete Pavement	SY	\$10.00
210009	Remove Existing Masonry	CY	\$98.00
210010	Remove Existing Concrete Barrier (Any Type)	LF	\$13.75
210011	Remove Existing Manhole	EA	\$925.00
210100	Scarify Existing Asphalt Pavement	SY	\$5.50
210200	Stabilized Construction Entrance	TON	\$28.75
210201	Rehabilitate Stabilized Construction Entrance	TON	\$21.25
210202	Class 3 Excavation for Incidental Construction	CY	\$11.25
210300	Trench Backfill Using Select Borrow	CY	\$31.25
210301	Trench Backfill	CY	\$10.00
210302	Select Backfill Using No. 57 Aggregate	CY	\$28.75
210303	Select Backfill Using Graded Aggregate Subbase	CY	\$28.75
210304	Flowable Backfill for Utility Cuts	CY	\$65.00
210305	Select Backfill Using Crusher Run Aggregate CR-6	CY	\$28.75
210400	Removal of Existing Pipe	LF	\$20.50
210401	Re-laid Old Pipe Culverts (Any Size)	LF	\$33.75
210500	Mix 1 Concrete Miscellaneous Structures	CY	\$390.00
210501	Mix 2 Concrete Miscellaneous Structures	CY	\$485.00
210502	Brick Masonry Miscellaneous Structure	CY	\$500.00
210503	Mix 3 Concrete Miscellaneous Structures	CY	\$845.00
210504	Mix 6 Concrete Miscellaneous Structures	CY	\$235.00
210505	Clean Existing Pipe - Any Size	LF	\$10.00
210506	Clean Existing Inlets	EA	\$260.00
210507	Clean Existing Underdrain Outlets	EA	\$100.00
210508	Remove Existing Catch Basin, Manhole, Headwall	EA	\$687.50
210509	Abandon Existing Catch Basin or Manhole	EA	\$166.25
STORM DRAIN CONSTRUCTION			
302000	12" RCCP Class III	LF	\$25.00
302001	15" RCCP Class III	LF	\$30.00
302002	18" RCCP Class III	LF	\$32.00
302003	21" RCCP Class III	LF	\$38.00
302004	24" RCCP Class III	LF	\$44.00
302005	27" RCCP Class III	LF	\$49.00
302006	30" RCCP Class III	LF	\$65.00
302007	33" RCCP Class III	LF	\$74.00
302008	36" RCCP Class III	LF	\$84.00
302009	42" RCCP Class III	LF	\$99.00
302010	48" RCCP Class III	LF	\$118.00
302011	54" RCCP Class III	LF	\$132.00
302012	60" RCCP Class III	LF	\$176.00
302013	66" RCCP Class III	LF	\$188.00
302014	72" RCCP Class III	LF	\$226.00
302015	78" RCCP Class III	LF	\$264.00
302016	84" RCCP Class III	LF	\$318.00
302017	90" RCCP Class III	LF	\$357.00
302018	96" RCCP Class III	LF	\$402.00

HOWARD COUNTY - DEPARTMENT OF PLANNING AND ZONING
APPROVED UNIT PRICES AND ITEM CODES
(County Council Resolution # -2022)
Effective Date: 7/1/2022

ITEM CODE	DESCRIPTION	UNIT	UNIT COST
302100	12" RCCP Class IV	LF	\$27.00
302101	15" RCCP Class IV	LF	\$32.00
302102	18" RCCP Class IV	LF	\$36.00
302103	21" RCCP Class IV	LF	\$43.00
302104	24" RCCP Class IV	LF	\$48.00
302105	27" RCCP Class IV	LF	\$55.00
302106	30" RCCP Class IV	LF	\$72.00
302107	33" RCCP Class IV	LF	\$83.00
302108	36" RCCP Class IV	LF	\$95.00
302109	42" RCCP Class IV	LF	\$103.00
302110	48" RCCP Class IV	LF	\$122.00
302111	54" RCCP Class IV	LF	\$148.00
302112	60" RCCP Class IV	LF	\$180.00
302113	66" RCCP Class IV	LF	\$209.00
302114	72" RCCP Class IV	LF	\$237.00
302115	78" RCCP Class IV	LF	\$290.00
302116	84" RCCP Class IV	LF	\$348.00
302117	90" RCCP Class IV	LF	\$464.00
302118	96" RCCP Class IV	LF	\$521.00
302300	12" RCCP Class V	LF	\$28.00
302301	15" RCCP Class V	LF	\$34.00
302302	18" RCCP Class V	LF	\$38.00
302303	21" RCCP Class V	LF	\$44.00
302304	24" RCCP Class V	LF	\$52.00
302305	27" RCCP Class V	LF	\$56.00
302306	30" RCCP Class V	LF	\$75.00
302307	33" RCCP Class V	LF	\$86.00
302308	36" RCCP Class V	LF	\$96.00
302309	42" RCCP Class V	LF	\$108.00
302310	48" RCCP Class V	LF	\$129.00
302311	54" RCCP Class V	LF	\$155.00
302312	60" RCCP Class V	LF	\$188.00
302313	66" RCCP Class V	LF	\$264.00
302314	72" RCCP Class V	LF	\$323.00
302315	78" RCCP Class V	LF	\$393.00
302316	84" RCCP Class V	LF	\$464.00
302317	90" RCCP Class V	LF	\$564.00
302318	96" RCCP Class V	LF	\$577.00
303000	6" BCCMP - 16 gauge	LF	\$17.00
303001	12" BCCMP - 16 gauge	LF	\$34.00
303002	15" BCCMP - 16 gauge	LF	\$40.00
303003	18" BCCMP - 16 gauge	LF	\$47.00
303004	21" BCCMP - 16 gauge	LF	\$56.00
303005	24" BCCMP - 16 gauge	LF	\$65.00
303006	27" BCCMP - 16 gauge	LF	\$75.00
303007	30" BCCMP - 16 gauge	LF	\$80.00
303100	6" BCCMP - 14 gauge	LF	\$19.00
303101	12" BCCMP - 14 gauge	LF	\$22.00
303102	15" BCCMP - 14 gauge	LF	\$24.00
303103	18" BCCMP - 14 gauge	LF	\$54.00
303104	21" BCCMP - 14 gauge	LF	\$64.00
303105	24" BCCMP - 14 gauge	LF	\$73.00
303106	27" BCCMP - 14 gauge	LF	\$84.00
303107	30" BCCMP - 14 gauge	LF	\$90.00
303108	36" BCCMP - 14 gauge	LF	\$110.00
303109	42" BCCMP - 14 gauge	LF	\$129.00
303110	48" BCCMP - 14 gauge	LF	\$146.00
303111	54" BCCMP - 14 gauge	LF	\$164.00
303112	60" BCCMP - 14 gauge	LF	\$184.00

HOWARD COUNTY - DEPARTMENT OF PLANNING AND ZONING
APPROVED UNIT PRICES AND ITEM CODES
 (County Council Resolution # -2022)
 Effective Date: 7/1/2022

ITEM CODE	DESCRIPTION	UNIT	UNIT COST
304000	8" CMP Galvanized - 16 gauge	LF	\$12.00
304001	10" CMP Galvanized - 16 gauge	LF	\$13.00
304002	12" CMP Galvanized - 16 gauge	LF	\$17.00
304003	15" CMP Galvanized - 16 gauge	LF	\$20.00
304004	18" CMP Galvanized - 16 gauge	LF	\$25.00
304005	21" CMP Galvanized - 16 gauge	LF	\$27.00
304006	24" CMP Galvanized - 16 gauge	LF	\$45.00
304100	24" CMP Galvanized - 14 gauge	LF	\$32.00
304101	27" CMP Galvanized - 14 gauge	LF	\$38.00
304102	30" CMP Galvanized - 14 gauge	LF	\$45.00
304103	36" CMP Galvanized - 14 gauge	LF	\$75.00
304104	42" CMP Galvanized - 14 gauge	LF	\$90.00
304200	36" CMP Galvanized - 12 gauge	LF	\$72.00
304201	48" CMP Galvanized - 12 gauge	LF	\$101.00
304202	54" CMP Galvanized - 12 gauge	LF	\$110.00
304300	60" CMP Galvanized - 10 gauge	LF	\$155.00
304301	66" CMP Galvanized - 10 gauge	LF	\$164.00
304500	72" CMP Galvanized - 8 gauge	LF	\$172.00
305000	8" CMP Aluminized - 16 gauge	LF	\$14.00
305001	10" CMP Aluminized - 16 gauge	LF	\$18.00
305002	12" CMP Aluminized - 16 gauge	LF	\$22.00
305003	15" CMP Aluminized - 16 gauge	LF	\$25.00
305004	18" CMP Aluminized - 16 gauge	LF	\$30.00
305005	21" CMP Aluminized - 16 gauge	LF	\$33.00
305100	12" CMP Aluminized - 14 gauge	LF	\$28.00
305101	15" CMP Aluminized - 14 gauge	LF	\$30.00
305102	18" CMP Aluminized - 14 gauge	LF	\$35.00
305103	21" CMP Aluminized - 14 gauge	LF	\$38.00
305104	24" CMP Aluminized - 14 gauge	LF	\$40.00
305105	27" CMP Aluminized - 14 gauge	LF	\$45.00
305106	30" CMP Aluminized - 14 gauge	LF	\$55.00
305200	36" CMP Aluminized - 12 gauge	LF	\$63.00
305201	48" CMP Aluminized - 12 gauge	LF	\$93.00
305202	54" CMP Aluminized - 12 gauge	LF	\$108.00
305300	60" CMP Aluminized - 10 gauge	LF	\$125.00
305301	66" CMP Aluminized - 10 gauge	LF	\$140.00
305600	72" CMP Aluminized - 8 gauge	LF	\$160.00
306000	12" HDPE, Smooth Inside, Plastic Rigid Pipe	LF	\$30.00
306001	15" HDPE, Smooth Inside, Plastic Rigid Pipe	LF	\$35.00
306002	18" HDPE, Smooth Inside, Plastic Rigid Pipe	LF	\$40.00
306003	24" HDPE, Smooth Inside, Plastic Rigid Pipe	LF	\$45.00
306004	30" HDPE, Smooth Inside, Plastic Rigid Pipe	LF	\$65.00
306005	36" HDPE, Smooth Inside, Plastic Rigid Pipe	LF	\$85.00
306006	39" HDPE, Smooth Inside, Plastic Rigid Pipe	LF	\$105.00
307000	4" PVC Schedule 40 Rigid Pipe	LF	\$12.00
307001	6" PVC Schedule 40 Rigid Pipe	LF	\$13.00
307002	8" PVC Schedule 40 Rigid Pipe	LF	\$16.00
307003	10" PVC Schedule 40 Rigid Pipe	LF	\$25.00
307004	12" PVC Schedule 40 Rigid Pipe	LF	\$30.00

HOWARD COUNTY - DEPARTMENT OF PLANNING AND ZONING
APPROVED UNIT PRICES AND ITEM CODES
(County Council Resolution # -2022)
Effective Date: 7/1/2022

ITEM CODE	DESCRIPTION	UNIT	UNIT COST
307100	Perforated 4" PVC Schedule 40 Rigid Pipe	LF	\$15.00
307101	Perforated 6" PVC Schedule 40 Rigid Pipe	LF	\$16.00
307102	Perforated 8" PVC Schedule 40 Rigid Pipe	LF	\$19.00
307103	Perforated 10" PVC Schedule 40 Rigid Pipe	LF	\$28.00
307104	Perforated 12" PVC Schedule 40 Rigid Pipe	LF	\$33.00
308000	14"x23" Horiz. Ellipt. RCCP Class HE III	LF	\$52.00
308001	19"x30" Horiz. Ellipt. RCCP Class HE III	LF	\$63.00
308002	22"x34" Horiz. Ellipt. RCCP Class HE III	LF	\$72.00
308003	24"x38" Horiz. Ellipt. RCCP Class HE III	LF	\$82.00
308004	27"x42" Horiz. Ellipt. RCCP Class HE III	LF	\$99.00
308005	29"x45" Horiz. Ellipt. RCCP Class HE III	LF	\$118.00
308006	32"x49" Horiz. Ellipt. RCCP Class HE III	LF	\$122.00
308007	34"x53" Horiz. Ellipt. RCCP Class HE III	LF	\$131.00
308008	38"x60" Horiz. Ellipt. RCCP Class HE III	LF	\$152.00
308009	43"x68" Horiz. Ellipt. RCCP Class HE III	LF	\$183.00
308010	48"x76" Horiz. Ellipt. RCCP Class HE III	LF	\$224.00
308011	53"x85" Horiz. Ellipt. RCCP Class HE III	LF	\$236.00
308012	58"x91" Horiz. Ellipt. RCCP Class HE III	LF	\$311.00
308013	63"x98" Horiz. Ellipt. RCCP Class HE III	LF	\$355.00
308014	68"x106" Horiz. Ellipt. RCCP Class HE III	LF	\$407.00
308015	72"x113" Horiz. Ellipt. RCCP Class HE III	LF	\$502.00
308016	77"x121" Horiz. Ellipt. RCCP Class HE III	LF	\$561.00
308017	82"x128" Horiz. Ellipt. RCCP Class HE III	LF	\$613.00
308018	87"x136" Horiz. Ellipt. RCCP Class HE III	LF	\$673.00
308100	14"x23" Horiz. Ellipt. RCCP Class HE IV	LF	\$57.00
308101	19"x30" Horiz. Ellipt. RCCP Class HE IV	LF	\$67.00
308102	22"x34" Horiz. Ellipt. RCCP Class HE IV	LF	\$77.00
308103	24"x38" Horiz. Ellipt. RCCP Class HE IV	LF	\$87.00
308104	27"x42" Horiz. Ellipt. RCCP Class HE IV	LF	\$105.00
308105	29"x45" Horiz. Ellipt. RCCP Class HE IV	LF	\$131.00
308106	32"x49" Horiz. Ellipt. RCCP Class HE IV	LF	\$134.00
308107	34"x53" Horiz. Ellipt. RCCP Class HE IV	LF	\$143.00
308108	38"x60" Horiz. Ellipt. RCCP Class HE IV	LF	\$162.00
308109	43"x68" Horiz. Ellipt. RCCP Class HE IV	LF	\$196.00
308110	48"x76" Horiz. Ellipt. RCCP Class HE IV	LF	\$241.00
308111	53"x85" Horiz. Ellipt. RCCP Class HE IV	LF	\$308.00
308112	58"x91" Horiz. Ellipt. RCCP Class HE IV	LF	\$362.00
308113	63"x98" Horiz. Ellipt. RCCP Class HE IV	LF	\$418.00
308114	68"x106" Horiz. Ellipt. RCCP Class HE IV	LF	\$477.00
308115	72"x113" Horiz. Ellipt. RCCP Class HE IV	LF	\$584.00
308116	77"x121" Horiz. Ellipt. RCCP Class HE IV	LF	\$653.00
308117	82"x128" Horiz. Ellipt. RCCP Class HE IV	LF	\$713.00
308118	87"x136" Horiz. Ellipt. RCCP Class HE IV	LF	\$782.00
309000	15" RCCP, ASTM C-361, Rubber Gasket Pipe, Class A-25	LF	\$55.00
309001	18" RCCP, ASTM C-361, Rubber Gasket Pipe, Class A-25	LF	\$60.00
309002	21" RCCP, ASTM C-361, Rubber Gasket Pipe, Class A-25	LF	\$65.00
309003	24" RCCP, ASTM C-361, Rubber Gasket Pipe, Class A-25	LF	\$70.00
309004	27" RCCP, ASTM C-361, Rubber Gasket Pipe, Class A-25	LF	\$75.00
309005	30" RCCP, ASTM C-361, Rubber Gasket Pipe, Class A-25	LF	\$85.00
309006	33" RCCP, ASTM C-361, Rubber Gasket Pipe, Class A-25	LF	\$90.00
309007	36" RCCP, ASTM C-361, Rubber Gasket Pipe, Class A-25	LF	\$100.00
309008	42" RCCP, ASTM C-361, Rubber Gasket Pipe, Class A-25	LF	\$130.00
309009	48" RCCP, ASTM C-361, Rubber Gasket Pipe, Class A-25	LF	\$150.00
309010	54" RCCP, ASTM C-361, Rubber Gasket Pipe, Class A-25	LF	\$175.00
309011	60" RCCP, ASTM C-361, Rubber Gasket Pipe, Class A-25	LF	\$245.00
309012	66" RCCP, ASTM C-361, Rubber Gasket Pipe, Class A-25	LF	\$265.00
309013	72" RCCP, ASTM C-361, Rubber Gasket Pipe, Class A-25	LF	\$295.00

HOWARD COUNTY - DEPARTMENT OF PLANNING AND ZONING
APPROVED UNIT PRICES AND ITEM CODES
(County Council Resolution # -2022)
Effective Date: 7/1/2022

ITEM CODE	DESCRIPTION	UNIT	UNIT COST
309100	15" RCCP, ASTM C-361, Rubber Gasket Pipe, Class B-25	LF	\$60.00
309101	18" RCCP, ASTM C-361, Rubber Gasket Pipe, Class B-25	LF	\$65.00
309102	21" RCCP, ASTM C-361, Rubber Gasket Pipe, Class B-25	LF	\$70.00
309103	24" RCCP, ASTM C-361, Rubber Gasket Pipe, Class B-25	LF	\$75.00
309104	27" RCCP, ASTM C-361, Rubber Gasket Pipe, Class B-25	LF	\$80.00
309105	30" RCCP, ASTM C-361, Rubber Gasket Pipe, Class B-25	LF	\$85.00
309106	33" RCCP, ASTM C-361, Rubber Gasket Pipe, Class B-25	LF	\$90.00
309107	36" RCCP, ASTM C-361, Rubber Gasket Pipe, Class B-25	LF	\$105.00
309108	42" RCCP, ASTM C-361, Rubber Gasket Pipe, Class B-25	LF	\$130.00
309109	48" RCCP, ASTM C-361, Rubber Gasket Pipe, Class B-25	LF	\$155.00
309110	54" RCCP, ASTM C-361, Rubber Gasket Pipe, Class B-25	LF	\$175.00
309111	60" RCCP, ASTM C-361, Rubber Gasket Pipe, Class B-25	LF	\$250.00
309112	66" RCCP, ASTM C-361, Rubber Gasket Pipe, Class B-25	LF	\$275.00
309113	72" RCCP, ASTM C-361, Rubber Gasket Pipe, Class B-25	LF	\$300.00
309200	15" RCCP, ASTM C-361, Rubber Gasket Pipe, Class C-25	LF	\$60.00
309201	18" RCCP, ASTM C-361, Rubber Gasket Pipe, Class C-25	LF	\$65.00
309202	21" RCCP, ASTM C-361, Rubber Gasket Pipe, Class C-25	LF	\$70.00
309203	24" RCCP, ASTM C-361, Rubber Gasket Pipe, Class C-25	LF	\$75.00
309204	27" RCCP, ASTM C-361, Rubber Gasket Pipe, Class C-25	LF	\$85.00
309205	30" RCCP, ASTM C-361, Rubber Gasket Pipe, Class C-25	LF	\$90.00
309206	33" RCCP, ASTM C-361, Rubber Gasket Pipe, Class C-25	LF	\$95.00
309207	36" RCCP, ASTM C-361, Rubber Gasket Pipe, Class C-25	LF	\$105.00
309208	42" RCCP, ASTM C-361, Rubber Gasket Pipe, Class C-25	LF	\$140.00
309209	48" RCCP, ASTM C-361, Rubber Gasket Pipe, Class C-25	LF	\$170.00
309210	54" RCCP, ASTM C-361, Rubber Gasket Pipe, Class C-25	LF	\$180.00
309211	60" RCCP, ASTM C-361, Rubber Gasket Pipe, Class C-25	LF	\$265.00
309212	66" RCCP, ASTM C-361, Rubber Gasket Pipe, Class C-25	LF	\$285.00
309213	72" RCCP, ASTM C-361, Rubber Gasket Pipe, Class C-25	LF	\$325.00
309300	15" RCCP, ASTM C-361, Rubber Gasket Pipe, Class D-25	LF	\$60.00
309301	18" RCCP, ASTM C-361, Rubber Gasket Pipe, Class D-25	LF	\$65.00
309302	21" RCCP, ASTM C-361, Rubber Gasket Pipe, Class D-25	LF	\$70.00
309303	24" RCCP, ASTM C-361, Rubber Gasket Pipe, Class D-25	LF	\$80.00
309304	27" RCCP, ASTM C-361, Rubber Gasket Pipe, Class D-25	LF	\$85.00
309305	30" RCCP, ASTM C-361, Rubber Gasket Pipe, Class D-25	LF	\$95.00
309306	33" RCCP, ASTM C-361, Rubber Gasket Pipe, Class D-25	LF	\$100.00
309307	36" RCCP, ASTM C-361, Rubber Gasket Pipe, Class D-25	LF	\$110.00
309308	42" RCCP, ASTM C-361, Rubber Gasket Pipe, Class D-25	LF	\$145.00
309309	48" RCCP, ASTM C-361, Rubber Gasket Pipe, Class D-25	LF	\$175.00
309310	54" RCCP, ASTM C-361, Rubber Gasket Pipe, Class D-25	LF	\$195.00
309311	60" RCCP, ASTM C-361, Rubber Gasket Pipe, Class D-25	LF	\$270.00
309312	66" RCCP, ASTM C-361, Rubber Gasket Pipe, Class D-25	LF	\$300.00
309313	72" RCCP, ASTM C-361, Rubber Gasket Pipe, Class D-25	LF	\$335.00
310000	17" x 13" CSP Pipe Arch - 16 gauge	LF	\$28.00
310001	21" x 15" CSP Pipe Arch - 16 gauge	LF	\$34.00
310002	24" x 18" CSP Pipe Arch - 16 gauge	LF	\$42.00
310100	28" x 20" CSP Pipe Arch - 14 gauge	LF	\$48.00
310101	35" x 24" CSP Pipe Arch - 14 gauge	LF	\$60.00
310200	42" x 29" CSP Pipe Arch - 12 gauge	LF	\$103.00
310201	49" x 33" CSP Pipe Arch - 12 gauge	LF	\$112.00
310300	57" x 38" CSP Pipe Arch - 10 gauge	LF	\$133.00
311000	17" x 13" CAP Pipe Arch - 16 gauge	LF	\$28.00
311001	21" x 15" CAP Pipe Arch - 16 gauge	LF	\$34.00
311002	24" x 18" CAP Pipe Arch - 16 gauge	LF	\$42.00
311100	28" x 20" CAP Pipe Arch - 14 gauge	LF	\$48.00
311101	35" x 24" CAP Pipe Arch - 14 gauge	LF	\$60.00

HOWARD COUNTY - DEPARTMENT OF PLANNING AND ZONING
APPROVED UNIT PRICES AND ITEM CODES
(County Council Resolution # -2022)
Effective Date: 7/1/2022

ITEM CODE	DESCRIPTION	UNIT	UNIT COST
311200	42" x 29" CAP Pipe Arch - 12 gauge	LF	\$103.00
311201	49" x 33" CAP Pipe Arch - 12 gauge	LF	\$112.00
311202	57" x 38" CAP Pipe Arch - 12 gauge	LF	\$133.00
312000	17" x 13" CM Pipe Arch - Coated & Paved - 16 gauge	LF	\$38.00
312001	21" x 15" CM Pipe Arch - Coated & Paved - 16 gauge	LF	\$46.00
312100	28" x 20" CM Pipe Arch - Coated & Paved - 14 gauge	LF	\$64.00
312101	35" x 24" CM Pipe Arch - Coated & Paved - 14 gauge	LF	\$79.00
312200	42" x 29" CM Pipe Arch - Coated & Paved - 12 gauge	LF	\$127.00
312201	49" x 33" CM Pipe Arch - Coated & Paved - 12 gauge	LF	\$145.00
312202	57" x 38" CM Pipe Arch - Coated & Paved - 12 gauge	LF	\$169.00
313000	17" x 13" ALCM Pipe Arch - Coated & Paved - 16 gauge	LF	\$38.00
313001	21" x 15" ALCM Pipe Arch - Coated & Paved - 16 gauge	LF	\$46.00
313100	28" x 20" ALCM Pipe Arch - Coated & Paved - 14 gauge	LF	\$64.00
313101	35" x 24" ALCM Pipe Arch - Coated & Paved - 14 gauge	LF	\$79.00
313200	42" x 29" ALCM Pipe Arch - Coated & Paved - 12 gauge	LF	\$127.00
313201	49" x 33" ALCM Pipe Arch - Coated & Paved - 12 gauge	LF	\$145.00
313202	57" x 38" ALCM Pipe Arch - Coated & Paved - 12 gauge	LF	\$169.00
314000	8" BCMP Galvanized - 16 gauge	LF	\$15.00
314001	10" BCMP Galvanized - 16 gauge	LF	\$19.00
314002	12" BCMP Galvanized - 16 gauge	LF	\$24.00
314003	15" BCMP Galvanized - 16 gauge	LF	\$29.00
314004	18" BCMP Galvanized - 16 gauge	LF	\$34.00
314100	24" BCMP Galvanized - 14 gauge	LF	\$53.00
314101	30" BCMP Galvanized - 14 gauge	LF	\$64.00
214200	36" BCMP Galvanized - 12 gauge	LF	\$100.00
214201	48" BCMP Galvanized - 12 gauge	LF	\$130.00
314300	60" BCMP Galvanized - 10 gauge	LF	\$193.00
314400	72" BCMP Galvanized - 8 gauge	LF	\$302.00
315000	8" BCMP Aluminized - 16 gauge	LF	\$15.00
315001	10" BCMP Aluminized - 16 gauge	LF	\$19.00
315002	12" BCMP Aluminized - 16 gauge	LF	\$24.00
315003	15" BCMP Aluminized - 16 gauge	LF	\$29.00
315004	18" BCMP Aluminized - 16 gauge	LF	\$34.00
315100	24" BCMP Aluminized - 14 gauge	LF	\$53.00
315101	30" BCMP Aluminized - 14 gauge	LF	\$64.00
315200	36" BCMP Aluminized - 12 gauge	LF	\$100.00
315201	48" BCMP Aluminized - 12 gauge	LF	\$130.00
315300	60" BCMP Aluminized - 10 gauge	LF	\$193.00
315400	72" BCMP Aluminized - 8 gauge	LF	\$302.00
320000	Standard A Headwall - 12" Pipe	EA	\$1,000.00
320001	Standard A Headwall - 15" Pipe	EA	\$1,250.00
320002	Standard A Headwall - 18" Pipe	EA	\$1,400.00
320003	Standard A Headwall - 21" Pipe	EA	\$1,500.00
320004	Standard A Headwall - 24" Pipe	EA	\$1,600.00
320005	Standard A Headwall - 27" Pipe	EA	\$1,700.00
320006	Standard A headwall - 30" Pipe	EA	\$2,400.00
320007	Standard A headwall - 33" Pipe	EA	\$3,125.00
320008	Standard A Headwall - 36" Pipe	EA	\$2,600.00
320009	Standard A Headwall - 42" Pipe	EA	\$3,200.00
320010	Standard A Headwall - 48" Pipe	EA	\$4,200.00
320011	Standard A Headwall - 54" Pipe	EA	\$5,400.00

HOWARD COUNTY - DEPARTMENT OF PLANNING AND ZONING
APPROVED UNIT PRICES AND ITEM CODES
(County Council Resolution # -2022)
Effective Date: 7/1/2022

ITEM CODE	DESCRIPTION	UNIT	UNIT COST
320012	Standard A Headwall - 60" Pipe	EA	\$6,600.00
320013	Standard A Headwall - 66" Pipe	EA	\$7,600.00
320014	Standard A Headwall - 72" Pipe	EA	\$9,200.00
321000	Standard C Endwall - 12" Pipe	EA	\$500.00
321001	Standard C Endwall - 15" Pipe	EA	\$700.00
321002	Standard C Endwall - 18" Pipe	EA	\$800.00
321003	Standard C Endwall - 21" Pipe	EA	\$1,100.00
321004	Standard C Endwall - 24" Pipe	EA	\$1,300.00
321005	Standard C Endwall - 27" Pipe	EA	\$1,600.00
321006	Standard C Endwall - 30" Pipe	EA	\$1,800.00
321007	Standard C Endwall - 33" Pipe	EA	\$2,700.00
321008	Standard C Endwall - 36" Pipe	EA	\$3,500.00
321009	Standard C Endwall - 42" Pipe	EA	\$4,300.00
321010	Standard C Endwall - 48" Pipe	EA	\$5,100.00
321011	Standard C Endwall - 54" Pipe	EA	\$6,400.00
321012	Standard C Endwall - 60" Pipe	EA	\$7,400.00
322000	Standard C Headwall - 17" x 13" CMPA	EA	\$500.00
322001	Standard C Headwall - 21" x 15" CMPA	EA	\$700.00
322002	Standard C Headwall - 24" x 18" CMPA	EA	\$800.00
322003	Standard C Headwall - 28" x 20" CMPA	EA	\$900.00
322004	Standard C Headwall - 35" x 24" CMPA	EA	\$1,500.00
322005	Standard C Headwall - 42" x 29" CMPA	EA	\$1,600.00
322006	Standard C Headwall - 49" x 33" CMPA	EA	\$3,600.00
322007	Standard C Headwall - 57" x 38" CMPA	EA	\$3,500.00
322008	Standard C Headwall - 64" x 43" CMPA	EA	\$4,900.00
322009	Standard C Headwall - 71" x 47" CMPA	EA	\$5,000.00
323000	Standard E Headwall - 12" Pipe	EA	\$700.00
323001	Standard E Headwall - 15" Pipe	EA	\$800.00
323002	Standard E Headwall - 18" Pipe	EA	\$1,000.00
323003	Standard E Headwall - 21" Pipe	EA	\$1,300.00
323004	Standard E Headwall - 24" Pipe	EA	\$1,500.00
323005	Standard E Headwall - 27" Pipe	EA	\$1,900.00
323006	Standard E Headwall - 30" Pipe	EA	\$2,200.00
323007	Standard E Headwall - 33" Pipe	EA	\$3,300.00
323008	Standard E Headwall - 36" Pipe	EA	\$4,200.00
323009	Standard E Headwall - 42" Pipe	EA	\$5,200.00
323010	Standard E Headwall - 48" Pipe	EA	\$6,200.00
323011	Standard E Headwall - 54" Pipe	EA	\$7,600.00
323012	Standard E Headwall - 60" Pipe	EA	\$8,900.00
324000	Standard E Headwall - 13" x 11" CMPA	EA	\$590.00
324001	Standard E Headwall - 17" x 13" CMPA	EA	\$600.00
324002	Standard E Headwall - 21" x 15" CMPA	EA	\$1,100.00
324003	Standard E Headwall - 24" x 18" CMPA	EA	\$1,200.00
324004	Standard E Headwall - 28" x 20" CMPA	EA	\$1,300.00
324005	Standard E Headwall - 35" x 24" CMPA	EA	\$2,000.00
324006	Standard E Headwall - 42" x 29" CMPA	EA	\$2,100.00
324007	Standard E Headwall - 49" x 33" CMPA	EA	\$4,700.00
324008	Standard E Headwall - 57" x 38" CMPA	EA	\$4,800.00
324009	Standard E Headwall - 64" x 43" CMPA	EA	\$6,600.00
324010	Standard E Headwall - 71" x 47" CMPA	EA	\$6,700.00

HOWARD COUNTY - DEPARTMENT OF PLANNING AND ZONING
APPROVED UNIT PRICES AND ITEM CODES
(County Council Resolution # -2022)
Effective Date: 7/1/2022

ITEM CODE	DESCRIPTION	UNIT	UNIT COST
325000	Standard O Headwall - 18" Pipe	EA	\$800.00
325001	Standard O Headwall - 21" Pipe	EA	\$1,000.00
325002	Standard O Headwall - 24" Pipe	EA	\$1,200.00
325003	Standard O Headwall - 27" Pipe	EA	\$1,300.00
325004	Standard O Headwall - 30" Pipe	EA	\$1,500.00
325005	Standard O Headwall - 36" Pipe	EA	\$2,200.00
325006	Standard O Headwall - 42" Pipe	EA	\$2,800.00
325007	Standard O Headwall - 48" Pipe	EA	\$3,500.00
325008	Standard O Headwall - 54" Pipe	EA	\$4,100.00
325009	Standard O Headwall - 60" Pipe	EA	\$5,000.00
325010	Standard O Headwall - 66" Pipe	EA	\$5,800.00
325011	Standard O Headwall - 72" Pipe	EA	\$6,800.00
326000	Standard O Headwall - 14" x 23" HERCCP	EA	\$700.00
326001	Standard O Headwall - 19" x 30" HERCCP	EA	\$1,000.00
326002	Standard O Headwall - 22" x 34" HERCCP	EA	\$1,200.00
326003	Standard O Headwall - 24" x 38" HERCCP	EA	\$1,400.00
326004	Standard O headwall - 27" x 42" HERCCP	EA	\$1,600.00
326005	Standard O Headwall - 29" x 45" HERCCP	EA	\$1,800.00
326006	Standard O Headwall - 34" x 53" HERCCP	EA	\$2,300.00
326007	Standard O Headwall - 38" x 60" HERCCP	EA	\$2,800.00
326008	Standard O Headwall - 43" x 68" HERCCP	EA	\$3,500.00
330000	12" HDPE End Section	EA	\$315.00
330001	15" HDPE End Section	EA	\$355.00
330002	18" HDPE End Section	EA	\$405.00
330003	24" HDPE End Section	EA	\$470.00
330004	30" HDPE End Section	EA	\$770.00
330005	36" HDPE End Section	EA	\$1,065.00
330006	39" HDPE End Section	EA	\$1,250.00
340000	Concrete End Section 12" RCCP	EA	\$325.00
340001	Concrete End Section 15" RCCP	EA	\$375.00
340002	Concrete End Section 18" RCCP	EA	\$400.00
340003	Concrete End Section 21" RCCP	EA	\$440.00
340004	Concrete End Section 24" RCCP	EA	\$530.00
340005	Concrete End Section 27" RCCP	EA	\$600.00
340006	Concrete End Section 30" RCCP	EA	\$700.00
340007	Concrete End Section 33" RCCP	EA	\$975.00
340008	Concrete End Section 36" RCCP	EA	\$1,000.00
340009	Concrete End Section 42" RCCP	EA	\$1,300.00
340010	Concrete End Section 48" RCCP	EA	\$1,700.00
340011	Concrete End Section 54" RCCP	EA	\$1,900.00
340012	Concrete End Section 60" RCCP	EA	\$2,300.00
340013	Concrete End Section 66" RCCP	EA	\$2,800.00
340014	Concrete End Section 72" RCCP	EA	\$3,200.00
341000	Concrete End Section - 14" x 23" HERCCP	EA	\$350.00
341001	Concrete End Section - 19" x 30" HERCCP	EA	\$450.00
341002	Concrete End Section - 22" x 34" HERCCP	EA	\$500.00
341003	Concrete End Section - 24" x 38" HERCCP	EA	\$550.00
341004	Concrete End Section - 27" x 42" HERCCP	EA	\$850.00
341005	Concrete End Section - 29" x 45" HERCCP	EA	\$1,200.00
341006	Concrete End Section - 32" x 49" HERCCP	EA	\$1,300.00
341007	Concrete End Section - 34" x 53" HERCCP	EA	\$1,400.00
341008	Concrete End Section - 38" x 60" HERCCP	EA	\$1,700.00
341009	Concrete End Section - 43" x 68" HERCCP	EA	\$2,100.00
341010	Concrete End Section - 48" x 76" HERCCP	EA	\$2,500.00
350000	End Section 12" CMP	EA	\$290.00
350001	End Section 15" CMP	EA	\$375.00
350002	End Section 18" CMP	EA	\$405.00
350003	End Section 21" CMP	EA	\$430.00
350004	End Section 24" CMP	EA	\$475.00
350005	End Section 27" CMP	EA	\$550.00
350006	End Section 30" CMP	EA	\$625.00
350007	End Section 33" CMP	EA	\$740.00
350008	End Section 36" CMP	EA	\$1,100.00

HOWARD COUNTY - DEPARTMENT OF PLANNING AND ZONING
APPROVED UNIT PRICES AND ITEM CODES
(County Council Resolution # -2022)
Effective Date: 7/1/2022

ITEM CODE	DESCRIPTION	UNIT	UNIT COST
350009	End Section 42" CMP	EA	\$1,300.00
350010	End Section 48" CMP	EA	\$1,600.00
350011	End Section 54" CMP	EA	\$2,000.00
350012	End Section 60" CMP	EA	\$2,300.00
350013	End Section 66" CMP	EA	\$2,400.00
350014	End Section 72" CMP	EA	\$2,500.00
350015	End Section 78" CMP	EA	\$3,200.00
350016	End Section 84" CMP	EA	\$3,800.00
351000	End Section 17" x 13" CMPA	EA	\$150.00
351001	End Section 21" x 15" CMPA	EA	\$200.00
351002	End Section 24" x 18" CMPA	EA	\$145.00
351003	End Section 28" x 20" CMPA	EA	\$325.00
351004	End Section 35" x 24" CMPA	EA	\$405.00
351005	End Section 42" x 29" CMPA	EA	\$525.00
351006	End Section 49" x 33" CMPA	EA	\$625.00
351007	End Section 57" x 38" CMPA	EA	\$700.00
351008	End Section 64" x 43" CMPA	EA	\$750.00
351009	End Section 71" x 47" CMPA	EA	\$825.00
351010	End Section 77" x 52" CMPA	EA	\$875.00
351011	End Section 83" x 57" CMPA	EA	\$950.00
360000	Single WR Inlet	EA	\$1,750.00
360001	Single WR Inlet - Vertical Depth Exceeds 4 ft.	VF	\$160.00
360002	Standard WR Inlet	EA	\$2,450.00
360003	Standard WR Inlet - Vertical Depth Exceeds 4 ft.	VF	\$160.00
360004	Precast Single WR Inlet	EA	\$1,700.00
360005	Precast Single WR Inlet - Vertical Depth Exceeds 4 ft.	VF	\$250.00
360006	Precast WR Inlet	EA	\$3,100.00
360007	Precast WR Inlet - Vertical Depth Exceeds 4 ft.	VF	\$175.00
360008	Precast NR Inlet	EA	\$1,750.00
360009	Precast NR Inlet - Vertical Depth Exceeds 4 ft.	VF	\$160.00
360010	Standard WRM Inlet	EA	\$3,750.00
360011	Standard WRM Inlet - Vertical Depth Exceeds 4 ft.	VF	\$200.00
361000	Standard 5' COG Inlet	EA	\$2,750.00
361001	Standard 5' COG - Vertical Depth Exceeds 6 ft.	VF	\$210.00
361002	Standard 10' COG Inlet	EA	\$4,125.00
361003	Standard 10' COG - Vertical Depth Exceeds 6 ft.	VF	\$220.00
361004	Standard 15' COG Inlet	EA	\$5,500.00
361005	Standard 15' COG - Vertical Depth Exceeds 6 ft.	VF	\$250.00
361006	Standard 20' COG Inlet	EA	\$6,200.00
361007	Standard 20' COG - Vertical Depth Exceeds 6 ft.	VF	\$250.00
362000	Standard 5' COS Inlet	EA	\$2,750.00
362001	Standard 5' COS - Vertical Depth Exceeds 6 ft.	VF	\$210.00
362002	Standard 10' COS Inlet	EA	\$4,125.00
362003	Standard 10' COS - Vertical Depth Exceeds 6 ft.	VF	\$220.00
362004	Standard 15' COS Inlet	EA	\$5,500.00
362005	Standard 15' COS - Vertical Depth Exceeds 6 ft.	VF	\$250.00
362006	Standard 20' COS Inlet	EA	\$6,200.00
362007	Standard 20' COS - Vertical Depth Exceeds 6 ft.	VF	\$250.00
363000	A-5	EA	\$2,300.00
363001	Precast Standard A-5 Inlet	EA	\$1,900.00
363002	A-10	EA	\$3,600.00
363003	Precast Standard A-10 Inlet	EA	\$3,200.00

HOWARD COUNTY - DEPARTMENT OF PLANNING AND ZONING
APPROVED UNIT PRICES AND ITEM CODES
(County Council Resolution # -2022)
Effective Date: 7/1/2022

ITEM CODE	DESCRIPTION	UNIT	UNIT COST
364000	Type "C" Inlet	EA	\$2,750.00
364001	Type "C" Inlet - Vertical Depth Exceeds 4 ft.	VF	\$210.00
364002	Type "D" Inlet	EA	\$1,750.00
364003	Type "D" Inlet - Vertical Depth Exceeds 4 ft.	VF	\$160.00
364004	Precast Standard Type "D" Inlet	EA	\$1,150.00
364005	Type "E" Inlet	EA	\$3,000.00
364006	Type "E" Inlet - Vertical Depth Exceeds 4 ft.	VF	\$160.00
364007	Type "E" Combination Inlet	EA	\$3,750.00
364008	Type "E" Combination Inlet - Vertical Depth Exceeds 4 ft.	VF	\$160.00
364009	Type "J" Inlet	EA	\$2,400.00
364010	Type "J" Inlet - Vertical Depth Exceeds 4 ft.	VF	\$310.00
364011	Type "K" Inlet	EA	\$2,200.00
364012	Type "K" Inlet - Vertical Depth Exceeds 4 ft.	VF	\$160.00
364013	Type "S" Combination Inlet	EA	\$1,900.00
364014	Type "S" Combination Inlet - Vertical Depth Exceeds 4 ft.	VF	\$160.00
364015	Type Single - "S"	EA	\$2,600.00
364016	Type Single "S" - Vertical Depth Exceeds 4 ft.	VF	\$160.00
364017	Type Double - "S"	EA	\$3,200.00
364018	Type Double "S" - Vertical Depth Exceeds 4 ft.	VF	\$190.00
364019	Double Type "S" Combination Inlet (Parallel to Curb)	EA	\$2,300.00
364020	Double Type "S" Combination Inlet (Normal to Curb)	EA	\$2,300.00
364021	Double Type "S" Combination - Vertical Depth Exceeds 4 ft.	VF	\$190.00
364022	Yard Inlet	EA	\$1,800.00
364023	Yard Inlet - Vertical Depth Exceeds 4 ft.	VF	\$230.00
364024	Precast Open End Grate	EA	\$1,250.00
365000	Adjust Existing Inlet	EA	\$600.00
365001	Reconstruct Existing Inlet	EA	\$2,000.00
370000	Field Connection - 15" to 27"	EA	\$325.00
370001	Field Connection - 15" to 30"	EA	\$350.00
370002	Field Connection - 15" to 33"	EA	\$375.00
370003	Field Connection - 15" to 36"	EA	\$400.00
370004	Field Connection - 15" to 42"	EA	\$450.00
370005	Field Connection - 15" to 48"	EA	\$500.00
370006	Field Connection - 15" to 54"	EA	\$550.00
370007	Field Connection - 15" to 60"	EA	\$600.00
370008	Field Connection - 18" to 60"	EA	\$650.00
370009	Field Connection - 24" to 60"	EA	\$700.00
370010	Field Connection - 27" to 60"	EA	\$750.00
370011	Field Connection - 30" to 48"	EA	\$750.00
370012	Field Connection - 30" to 60"	EA	\$750.00
380000	Type A-Manhole - (Brick) 4' Diameter	EA	\$2,600.00
380001	Type A-Manhole - (Brick) 5' Diameter	EA	\$2,800.00
380002	Type A-Manhole - (Brick) 6' Diameter	EA	\$3,600.00
380003	Type A-Manhole - (Brick) 4' Diameter Offset	EA	\$3,200.00
380004	Type B-Manhole (Shallow Brick) - 4' Diameter	EA	\$2,300.00
380005	Type C-Manhole (Precast) - 4' Diameter (12" - 24" Pipes)	EA	\$2,000.00
380006	Type C-Manhole (Precast) - 4' Diameter - Vertical Depth Exceeds 8'	VF	\$150.00
380007	Type C-Manhole (Precast) - 5' Diameter (27" - 36" Pipes)	EA	\$3,300.00
380008	Type C-Manhole (Precast) - 5' Diameter - Vertical Depth Exceeds 8'	VF	\$200.00
380009	Type C-Manhole (Precast) - 6' Diameter (42" - 48" Pipes)	EA	\$5,000.00
380010	Type C-Manhole (Precast) - 6' Diameter - Vertical Depth Exceeds 8'	VF	\$300.00
380011	Type C-Manhole (Precast) - 7' Diameter (54" - 60" Pipes)	EA	\$7,200.00
380012	Type C-Manhole (Precast) - 7' Diameter - Vertical Depth Exceeds 8'	VF	\$400.00
380013	Type C-Manhole (Precast) - 8' Diameter (72" - 84" Pipes)	EA	\$9,375.00
380014	Type C-Manhole (Precast) - 8' Diameter - Vertical Depth Exceeds 8'	VF	\$500.00
380015	Type C-Manhole (Precast) - 10' Diameter (90" - 96" Pipes)	EA	\$12,500.00
380016	Type C-Manhole (Precast) - 10' Diameter - Vertical Depth Exceeds 8'	VF	\$600.00
380017	Type C-Manhole (Precast Shallow) - 4' Diameter	EA	\$2,600.00
380018	Type C-Manhole (Precast Shallow) - 5' Diameter	EA	\$3,200.00
380019	Manhole Cover	EA	\$1,000.00
380020	Manhole Steps	EA	\$25.00

HOWARD COUNTY - DEPARTMENT OF PLANNING AND ZONING
APPROVED UNIT PRICES AND ITEM CODES
(County Council Resolution # -2022)
Effective Date: 7/1/2022

ITEM CODE	DESCRIPTION	UNIT	UNIT COST
390000	Subgrade Trench Drains	LF	\$9.00
391000	4" Perforated Circular Pipe Underdrain	LF	\$6.50
391001	6" Perforated Circular Pipe Longitudinal Underdrain	LF	\$7.50
391002	6" Perforated Circular Pipe Underdrain	LF	\$9.00
391003	8" Perforated Circular Pipe Underdrain	LF	\$10.00
391004	4" Circular Pipe Underdrain Outlets	LF	\$9.00
391005	6" Circular Pipe Underdrain Outlets	LF	\$12.50
391006	8" Circular Pipe Underdrain Outlets	LF	\$21.50
391007	Aggregate Backfill for Underdrains	CY	\$28.00
391008	Geotextile for Underdrains	SY	\$5.00
392000	4" PVC Pipe Schedule 80	LF	\$12.50
392001	6" PVC Pipe Schedule 80	LF	\$25.00
392002	4" Perforated PVC Pipe Schedule 80	LF	\$15.00
392003	6" Perforated PVC Pipe Schedule 80	LF	\$45.00
SEDIMENT & EROSION CONTROL			
393000	Temporary Slope Drain - 12" Pipe	LF	\$14.00
393001	Temporary Slope Drain - 18" Pipe	LF	\$18.00
393002	Temporary Slope Drain - 24" Pipe	LF	\$32.00
393003	Temporary Slope Drain - 30" Pipe	LF	\$45.00
393004	Remove & Reset Temporary Slope Drain - 12" Pipe	LF	\$9.00
393005	Remove & Reset Temporary Slope Drain - 18" Pipe	LF	\$8.00
393006	Remove & Reset Temporary Slope Drain - 24" Pipe	LF	\$6.00
393007	Remove & Reset Temporary Slope Drain - 30" Pipe	LF	\$5.00
393008	Erosion & Sediment Control Original Excavation	CY	\$9.00
393009	Erosion & Sediment Control Cleanout Excavation	CY	\$7.00
393010	Earth Dike	LF	\$4.00
393011	Perimeter Dike/Swale	LF	\$4.00
393012	Inlet Protection	EA	\$200.00
393013	Diversion Dike	LF	\$4.00
393014	Straw Bales	LF	\$4.00
393015	Placed Rip-Rap for Sediment Control	TON	\$40.00
STORM DRAIN OUTFALL STABILIZATION			
400000	Gabions - 6' x 3' x 1' Basket (Stone, Basket, Filter Cloth)	EA	\$180.00
400001	Gabions - 6' x 3' x 1.5' Basket (Stone, Basket, Filter Cloth)	EA	\$240.00
400002	Gabions - 6' x 3' x 3' Basket (Stone, Basket, Filter Cloth)	EA	\$360.00
400003	Gabions - 9' x 3' x 3' Basket (Stone, Basket, Filter Cloth)	EA	\$460.00
400004	Gabions - 9' x 6' x .75' Basket (Stone, Basket, Filter Cloth)	EA	\$360.00
400005	Gabions - 12' x 3' x 1' Basket (Stone, Basket, Filter Cloth)	EA	\$310.00
400006	Gabions - 12' x 3' x 3' Basket (Stone, Basket, Filter Cloth)	EA	\$680.00
400007	Gabions - 12' x 6' x .75' Basket (Stone, Basket, Filter Cloth)	EA	\$450.00
400100	MSHA Class 0 Ungrouted Rip-rap	SY	\$60.00
400101	MSHA Class 1 Ungrouted Rip-rap	SY	\$90.00
400102	MSHA Class 2 Ungrouted Rip-rap	SY	\$100.00
400103	MSHA Class 3 Ungrouted Rip-rap	SY	\$120.00
400200	No. 2 Stone (3/4" - 1-1/2")	CY	\$40.00
400300	Geotextile Class "C" - Filter Cloth or Blanket	SY	\$9.00
400301	Geotextile Class "F" - Slope Silt Fence	LF	\$1.50
400302	Geotextile Class "F" - Channel Silt Fence	LF	\$2.00
400303	Remove & Reset Geotextile Class "F" Silt Fence	LF	\$1.50
400304	Super Silt Fence	LF	\$8.00
400305	Orange Safety Fence	LF	\$3.00
RETAINING & NOISE WALLS			
450000	Concrete Retaining Wall - 6' high, 33 deg. surcharge	LF	\$400.00
450001	Concrete Retaining Wall - 8' high, 33 deg. surcharge	LF	\$500.00
450002	Concrete Retaining Wall - 10' high, 33 deg. surcharge	LF	\$600.00
450003	Concrete Retaining Wall - 20' high, 500 lbs. per LF surcharge	LF	\$1,600.00

HOWARD COUNTY - DEPARTMENT OF PLANNING AND ZONING
APPROVED UNIT PRICES AND ITEM CODES
(County Council Resolution # -2022)
Effective Date: 7/1/2022

ITEM CODE	DESCRIPTION	UNIT	UNIT COST
450100	CMU Retaining Wall (6" Thick - Reinforced, Excluding Footing)	SF	\$7.00
450101	CMU Retaining Wall (8" Thick - Reinforced, Excluding Footing)	SF	\$8.00
450102	CMU Retaining Wall (10" Thick - Reinforced, Excluding Footing)	SF	\$10.00
450103	CMU Retaining Wall (12" Thick - Reinforced, Excluding Footing)	SF	\$11.00
450200	Timber Retaining Wall - 3' high	LF	\$45.00
450300	GeoGrid Block Retaining Walls (Excluding Footing)	SF	\$20.00
450400	Noise Barrier System Height Up To 24'	SF	\$14.00
450401	Wooden Noise Wall Height Up To 8'	SF	\$12.50
STREET CONSTRUCTION & PAVEMENT MARKINGS			
500000	Gravel Base Course Graded Aggregate (GAB)	IN/SY	\$2.00
500001	CR-6 Base Course	IN/SY	\$1.50
500002	2" Sawcut	LF	\$4.00
500003	Full Depth Sawcut	LF	\$6.00
500004	Mill Existing Asphalt - 0" to 2" Deep	SY	\$10.00
500005	Rubberized Crack Sealer	GAL	\$28.00
500006	HMA SuperPave Final Surface	IN/SY	\$4.00
500007	HMA SuperPave Intermediate	IN/SY	\$3.50
500008	HMA SuperPave Base	IN/SY	\$3.25
500009	Chip Seal Double Surface Treatment	IN/SY	\$2.00
500100	P-1 Paving Section - CBR 3 to <5 (Min. HMA w/ GAB)	SY	\$29.50
500101	P-2 Paving Section - CBR 3 to <5 (Min. HMA w/ GAB)	SY	\$32.00
500102	P-3 Paving Section - CBR 3 to <5 (Min. HMA w/ GAB)	SY	\$39.25
500103	P-4 Paving Section - CBR 3 to <5 (Min. HMA w/ GAB)	SY	\$54.00
500104	P-5 Paving Section - CBR 3 to <5 (Min. HMA w/ GAB)	SY	\$56.50
500105	P-6 Paving Section - CBR 3 to <5 (Min. HMA w/ GAB)	SY	\$63.75
500106	P-7 Paving Section - CBR 3 to <5 (Min. HMA w/ GAB)	SY	\$36.50
500107	P-8 Paving Section - CBR 3 to <5 (Min. HMA w/ GAB)	SY	\$31.00
500200	P-1 Paving Section - CBR 5 to <7 (Min. HMA w/ GAB)	SY	\$26.50
500201	P-2 Paving Section - CBR 5 to <7 (Min. HMA w/ GAB)	SY	\$24.00
500202	P-3 Paving Section - CBR 5 to <7 (Min. HMA w/ GAB)	SY	\$31.25
500203	P-4 Paving Section - CBR 5 to <7 (Min. HMA w/ GAB)	SY	\$42.00
500204	P-5 Paving Section - CBR 5 to <7 (Min. HMA w/ GAB)	SY	\$44.50
500205	P-6 Paving Section - CBR 5 to <7 (Min. HMA w/ GAB)	SY	\$49.75
500206	P-7 Paving Section - CBR 5 to <7 (Min. HMA w/ GAB)	SY	\$32.50
500207	P-8 Paving Section - CBR 5 to <7 (Min. HMA w/ GAB)	SY	\$28.00
500300	P-1 Paving Section - CBR ≥ 7 (Min. HMA w/ GAB)	SY	\$22.50
500301	P-2 Paving Section - CBR ≥ 7 (Min. HMA w/ GAB)	SY	\$20.00
500302	P-3 Paving Section - CBR ≥ 7 (Min. HMA w/ GAB)	SY	\$25.25
500303	P-4 Paving Section - CBR ≥ 7 (Min. HMA w/ GAB)	SY	\$32.75
500304	P-5 Paving Section - CBR ≥ 7 (Min. HMA w/ GAB)	SY	\$42.50
500305	P-6 Paving Section - CBR ≥ 7 (Min. HMA w/ GAB)	SY	\$45.75
500306	P-7 Paving Section - CBR ≥ 7 (Min. HMA w/ GAB)	SY	\$29.50
500307	P-8 Paving Section - CBR ≥ 7 (Min. HMA w/ GAB)	SY	\$23.00
500400	P-1 Paving Section - CBR 3 to <5 (Min. HMA with Constant GAB)	SY	\$25.38
500401	P-2 Paving Section - CBR 3 to <5 (Min. HMA with Constant GAB)	SY	\$28.88
500402	P-3 Paving Section - CBR 3 to <5 (Min. HMA with Constant GAB)	SY	\$36.13
500403	P-4 Paving Section - CBR 3 to <5 (Min. HMA with Constant GAB)	SY	\$46.50
500404	P-5 Paving Section - CBR 3 to <5 (Min. HMA with Constant GAB)	SY	\$53.75
500405	P-6 Paving Section - CBR 3 to <5 (Min. HMA with Constant GAB)	SY	\$58.63
500406	P-8 Paving Section - CBR 3 to <5 (Min. HMA with Constant GAB)	SY	\$20.00
500500	P-1 Paving Section - CBR 5 to <7 (Min. HMA with Constant GAB)	SY	\$23.75
500501	P-2 Paving Section - CBR 5 to <7 (Min. HMA with Constant GAB)	SY	\$24.00
500502	P-3 Paving Section - CBR 5 to <7 (Min. HMA with Constant GAB)	SY	\$31.25
500503	P-4 Paving Section - CBR 5 to <7 (Min. HMA with Constant GAB)	SY	\$43.25
500504	P-5 Paving Section - CBR 5 to <7 (Min. HMA with Constant GAB)	SY	\$47.25
500505	P-6 Paving Section - CBR 5 to <7 (Min. HMA with Constant GAB)	SY	\$52.13
500506	P-8 Paving Section - CBR 5 to <7 (Min. HMA with Constant GAB)	SY	\$26.00

HOWARD COUNTY - DEPARTMENT OF PLANNING AND ZONING
APPROVED UNIT PRICES AND ITEM CODES
(County Council Resolution # -2022)
Effective Date: 7/1/2022

ITEM CODE	DESCRIPTION	UNIT	UNIT COST
500600	P-1 Paving Section - CBR ≥ 7 (Min. HMA with Constant GAB)	SY	\$22.13
500601	P-2 Paving Section - CBR ≥ 7 (Min. HMA with Constant GAB)	SY	\$24.00
500602	P-3 Paving Section - CBR ≥ 7 (Min. HMA with Constant GAB)	SY	\$28.00
500603	P-4 Paving Section - CBR ≥ 7 (Min. HMA with Constant GAB)	SY	\$36.75
500604	P-5 Paving Section - CBR ≥ 7 (Min. HMA with Constant GAB)	SY	\$44.00
500605	P-6 Paving Section - CBR ≥ 7 (Min. HMA with Constant GAB)	SY	\$47.25
500606	P-8 Paving Section - CBR ≥ 7 (Min. HMA with Constant GAB)	SY	\$26.00
500700	Concrete Pavement	IN/SY	\$10.00
501000	HMA - Bituminous Curb	LF	\$6.00
501001	Standard Barrier Curb	LF	\$17.00
501002	Concrete Curb & Gutter Transition	LF	\$25.00
501003	Concrete Curb & Gutter	LF	\$14.00
501004	Modified Curb & Gutter	LF	\$14.00
501005	Precast Concrete Wheel Stops - Fixed	EA	\$45.00
501006	Monolithic Concrete Median	SF	\$49.00
502000	Concrete Sidewalk - 4" Thick	SY	\$32.00
502001	Monolithic Concrete Curb & Sidewalk	SY	\$45.00
502002	Brick Pavers	SF	\$15.00
502003	Macadam Path or Sidewalk	IN/SY	\$5.50
502100	Sidewalk Ramp Type "A"	EA	\$575.00
502101	Sidewalk Ramp Type "B"	EA	\$925.00
502102	Sidewalk Ramp Type "C"	EA	\$575.00
502200	Residential Driveway w/Sidewalk Setback from Curb	EA	\$950.00
502201	Residential Driveway w/Sidewalk Adjacent to Curb	EA	\$950.00
502202	Residential Driveway w/Modified Curb	EA	\$950.00
502203	Residential Driveway w/Bit. Curb & Sidewalk	EA	\$625.00
502204	Residential Driveway w/o Sidewalk	EA	\$625.00
502205	Residential Driveway, Open Section Road	EA	\$325.00
502206	Commercial Driveway on Closed Section Road	EA	\$4,400.00
502207	Commercial Driveway on Open Section Road	EA	\$4,400.00
502208	Commercial Driveway - High Volume	EA	\$4,400.00
503000	Guard Rail W Beam	LF	\$17.50
503001	Dead End Type "A" Barricade	LF	\$30.00
503002	Dead End Type "C" Barricade	LF	\$40.00
503003	Guard Rail w/Beam Anchor	LF	\$22.00
503004	Type 1 - End Flare	EA	\$625.00
503005	Type 2 - End Flare	EA	\$675.00
503006	Guard Rail Remove & Reset	LF	\$17.00
503007	Guard Rail Removal and Disposal	LF	\$7.25
504000	Chain Link Fence - 6'	LF	\$20.00
504001	Chain Link Fence - 8'	LF	\$25.00
504002	Terminal Post 6' Chain Link fence	EA	\$12.50
504003	Terminal Post 8' Chain Link Fence	EA	\$18.75
504004	Gate - 6' for 6' Chain Link Fence	EA	\$140.00
504005	Gate - 12' for 6' Chain Link Fence	EA	\$275.00
504006	Gate - 12' for 8' Chain Link Fence	EA	\$325.00
504007	Chain Link Fence Remove & Reset	LF	\$12.50
504008	Chain Link Fence Removal and Disposal	LF	\$2.00
504009	Wood Stock Fence	LF	\$16.50
504010	Wood Fence Removal and Disposal	LF	\$2.00

HOWARD COUNTY - DEPARTMENT OF PLANNING AND ZONING
APPROVED UNIT PRICES AND ITEM CODES
(County Council Resolution # -2022)
Effective Date: 7/1/2022

ITEM CODE	DESCRIPTION	UNIT	UNIT COST
FINE GRADING AND LANDSCAPING			
505000	Placing Salvaged Topsoil (2" depth)	SY	\$2.75
505001	Top Soil - Furnished & Placed (2" depth)	SY	\$3.25
505002	Temporary Seeding & Mulching	SY	\$0.40
505003	Straw Mulching	SY	\$0.25
505004	Solid Sodding	SY	\$3.00
505005	Seeding	SY	\$0.40
505006	Seeding & Mulching	SY	\$0.80
505007	Soil Stabilization Matting (Miramat, Curlex, etc.)	SY	\$2.75
506000	Selective Tree Trimming	EA	\$120.00
506001	Street Trees	EA	\$375.00
506002	Furnish & Plant Acer Rubrum (Red Maple) - 2" C BB	EA	\$190.00
506003	Furnish & Plant Crataegus (Flowering Hawthorne) - 2" C BB	EA	\$190.00
506004	Furnish & Plant Gleditsia Triacanthos Inermis (Thorny Honey Locust) - 2" C BB	EA	\$190.00
506005	Furnish & Plant Quercus Palustris (Pin Oak) - 2" C BB	EA	\$190.00
SIGNAGE			
750000	Install New Signs Supplied by County	SF	\$10.00
750001	Stop signs	EA	\$110.00
750002	Street Signs	EA	\$125.00
RAILROAD TRACK INSTALLATION			
760000	Railroad Ties	LF	\$30.00
760001	Railroad Track Installation	LF	\$105.00
UTILITY ADJUSTMENTS & HANDRAILS			
770000	Adjust Existing Utility Appurtenances to Finished Grade - LT 12" Circ.	EA	\$170.00
770001	Adjust Existing Utility Appurtenances to Finished Grade - 12" to 29" Circ.	EA	\$250.00
770002	Adjust Existing Utility Appurtenances to Finished Grade - GT 29" Circ.	EA	\$340.00
770003	Galvanized Handrails (3 rails)	LF	\$37.50
770004	Wood Handrails (3 rails)	LF	\$25.00
STORMWATER MANAGEMENT FACILITIES			
800000	Corrugated Metal Riser Structure	EA	\$3,750.00
800001	Corrugated Metal Trash Rack for CM Riser	EA	\$2,250.00
800002	Corrugated Metal Anti-Seep Collar	EA	\$750.00
800100	Reinforced Concrete Riser Structure	CY	\$825.00
800101	A-2 Concrete Cradle	CY	\$825.00
800102	Reinforced Concrete Anti-Seep Collar	CY	\$825.00
800103	Sand Filter Diaphragm	CY	\$33.25
800104	Reinforced Concrete	CY	\$825.00
800200	Rock Vane	EA	\$5,500.00
800201	Log Vane	EA	\$2,100.00
800202	Flush Cut	EA	\$900.00
800203	Root Wad Revetment	EA	\$2,400.00
800204	Rock J-Hook Vane	EA	\$6,100.00
800205	Rock Cross Vane	EA	\$6,800.00
800206	Boulder Bank Stabilization	LF	\$100.00
800207	Live Stakes	EA	\$4.00
800208	Live Branch Layering	LF	\$15.00
800209	Coir Fiber Erosion Control Matting	SY	\$5.00
800210	Stream Diversion and Dewatering	LS	\$50,000.00
800300	Sand (washed) for Bioretention	CY	\$30.00
800301	Pea Gravel (washed) for Bioretention	CY	\$30.00
800302	Planting Soil for Bioretention	CY	\$25.00
800303	Mulch for Bioretention	CY	\$28.00
800304	Trees for Bioretention	EA	\$300.00
800305	Shrubs for Bioretention	EA	\$150.00
800306	Grasses for Bioretention	SY	\$1.00

HOWARD COUNTY - DEPARTMENT OF PLANNING AND ZONING
APPROVED UNIT PRICES AND ITEM CODES
 (County Council Resolution # -2022)
 Effective Date: 7/1/2022

ITEM CODE	DESCRIPTION	UNIT	UNIT COST
800400	Rain Garden/Biorentention Facility (complete)	EA	\$6,500.00
800401	Infiltration Trench (Stone Only)	CY	\$60.00
800402	Dry Well (Complete)	EA	\$6,500.00
800403	Pervious Concrete (w/12" of #57 stone)	SY	\$80.00
800500	Clay Backfill for Core Trench	CY	\$20.00
UNDERGROUND UTILITIES			
Boring & Jacking			
820000	Boring & Jacking Water	LF	\$263.00
820001	Boring & Jacking Sewer	LF	\$488.00
820002	36" Steel Casing Pipe (Boring/Jacking)	LF	\$125.00
Water			
820100	4" DIP	LF	\$50.00
820101	6" DIP	LF	\$56.00
820102	8" DIP	LF	\$60.00
820103	12" DIP	LF	\$76.00
820104	16" DIP	LF	\$80.00
820110	4" C-900 PVC	LF	\$26.00
820111	6" C-900 PVC	LF	\$30.00
820112	8" C-900 PVC	LF	\$36.00
820113	10" C-900 PVC	LF	\$46.00
820114	12" C-900 PVC	LF	\$52.00
820120	3/4" Copper WHC	LF	\$30.00
820121	1" Copper WHC	LF	\$31.00
820122	1-1/2" Copper WHC	LF	\$35.00
820123	2" Copper WHC	LF	\$36.00
820124	3" PVC Schedule 40 WHC	LF	\$40.00
820125	4" PVC Schedule 40 WHC	LF	\$44.00
820130	1-1/2" Drains	EA	\$1,000.00
820131	Blow off valve	EA	\$9,000.00
820132	Air Release valve & Vault	EA	\$5,700.00
820140	8" x 4" Tapping Sleeve & Valve	EA	\$1,500.00
820141	8" x 6" Tapping Sleeve & Valve	EA	\$1,875.00
820142	8" x 8" Tapping Sleeve & Valve	EA	\$3,125.00
820143	8" x 12" Tapping Sleeve & Valve	EA	\$6,250.00
820150	4" Gate Valve & Box	EA	\$600.00
820151	6" Gate Valve & Box	EA	\$700.00
820152	8" Gate Valve & Box	EA	\$800.00
820153	10" Gate Valve & Box	EA	\$1,000.00
820154	12" Gate Valve & Box	EA	\$1,200.00
820155	16" Gate Valve & Vault (Precast)	EA	\$6,000.00
820160	3/4" Meter Vault for outside metering	EA	\$438.00
820161	1" Meter Vault for outside metering	EA	\$500.00
820162	1-1/2" Meter Vault for outside metering	EA	\$625.00
820163	2" Meter Vault for outside metering	EA	\$1,063.00
820164	3" Meter Vault for outside metering	EA	\$3,750.00
820165	4" Meter Vault for outside metering	EA	\$4,375.00
820166	6" Meter Vault for outside metering	EA	\$8,750.00
820170	Fire Hydrants, FH Tee and Valve	EA	\$2,500.00
820171	Fire Suppression Tank (5,000 gal) and Concrete Slab	EA	\$6,850.00
820172	Removal of abandoned 6" or 8" water mains	LF	\$30.00
Sewer			
820200	4" PVC Schedule 40 (less than 12' deep)	LF	\$55.00
820201	6" PVC Schedule 40 (less than 12' deep)	LF	\$60.00
820202	8" PVC Schedule 40 (less than 12' deep)	LF	\$65.00
820203	10" PVC Schedule 40 (less than 12' deep)	LF	\$70.00
820204	12" PVC Schedule 40 (less than 12' deep)	LF	\$75.00
820205	8" PVC Schedule 40 (12' - 16' deep)	LF	\$69.00
820206	8" PVC Schedule 40 (greater than 16' deep)	LF	\$83.00

HOWARD COUNTY - DEPARTMENT OF PLANNING AND ZONING
APPROVED UNIT PRICES AND ITEM CODES
 (County Council Resolution # -2022)
 Effective Date: 7/1/2022

ITEM CODE	DESCRIPTION	UNIT	UNIT COST
820210	8" DIP Sewer (all depths)	LF	\$75.00
820211	10" DIP Sewer (all depths)	LF	\$85.00
820212	12" DIP Sewer (all depths)	LF	\$95.00
820220	4" C-900 PVC Sewer Pipe	LF	\$70.00
820221	6" C-900 PVC Sewer Pipe	LF	\$75.00
820222	8" C-900 PVC Sewer Pipe	LF	\$80.00
820223	10" C-900 PVC Sewer Pipe	LF	\$90.00
820224	12" C-900 PVC Sewer Pipe	LF	\$93.00
820230	4' Sewer Manhole	EA	\$2,500.00
820231	Sewer Cleanouts	EA	\$1,000.00
820232	Type A Drop Connection	EA	\$1,060.00
820233	Type B Drop Connection	EA	\$1,185.00
820234	Oil/Grease Interceptors	EA	\$6,250.00
Shared Septic			
Piping and Drain Fields			
820300	1-1/4" SDP 11 PVC (Low Pressure Sewer)	LF	\$15.00
820301	1-1/2" SDP 11 PVC SHC (Low Pressure Sewer)	LF	\$20.00
820302	2" Sewer Force Main	LF	\$25.00
820303	4" Sewer Force Main	LF	\$35.00
820304	Drain Field Trenches, gravity, 4" PVC, 3' depth including tile	LF	\$8.00
Pumps/Distribution System Controls/Buildings			
820310	Simplex Grinder Pump	EA	\$4,000.00
820311	Duplex Grinder Pump	EA	\$8,000.00
820312	Duplex Submersible Pumps	EA	\$8,000.00
820313	Flushing Connections	EA	\$1,500.00
820314	Concrete Settling Tank	EA	\$2,500.00
820315	Monitoring Well	EA	\$1,500.00
820316	Distribution Box	EA	\$1,000.00
820317	Electrical Controls and Telemetry	EA	\$15,000.00
820318	Blower/Distribution Pumpsets/Controls	EA	\$20,000.00
820319	Septic Tanks	Per 1000 Gal	\$1,500.00
820320	Treatment/Chemical/Storage Building	EA	\$30,000.00
SIGNAGE & ELECTRICAL WORK			
870000	3/4" Electrical Conduit-PVC Schedule 80-Riser	LF	\$1.00
870001	3/4" Electrical Conduit-PVC Schedule 80-Pushed	LF	\$2.00
870002	3/4" Electrical Conduit-PVC Schedule 80-Trenched	LF	\$3.00
870003	3/4" Electrical Conduit-PVC Schedule 80-Slotted	LF	\$2.00
870004	3/4" Electrical Conduit-PVC Schedule 80-Elbow	EA	\$5.00
870005	1" Electrical Conduit-PVC Schedule 80-Riser	LF	\$2.50
870006	1" Electrical Conduit-PVC Schedule 80-Pushed	LF	\$5.00
870007	1" Electrical Conduit-PVC Schedule 80-Trenched	LF	\$2.00
870008	1" Electrical Conduit-PVC Schedule 80-Slotted	LF	\$5.00
870009	1" Electrical Conduit-PVC Schedule 80-Elbow	EA	\$7.50
870010	2" Electrical Conduit-PVC Schedule 80-Riser	LF	\$5.00
870011	2" Electrical Conduit-PVC Schedule 80-Pushed	LF	\$18.50
870012	2" Electrical Conduit-PVC Schedule 80-Trenched	LF	\$5.00
870013	2" Electrical Conduit-PVC Schedule 80-Slotted	LF	\$18.50
870014	2" Electrical Conduit-PVC Schedule 80-Elbow	EA	\$9.00
870015	3" Electrical Conduit-PVC Schedule 80-Riser	LF	\$10.00
870016	3" Electrical Conduit-PVC Schedule 80-Pushed	LF	\$20.00
870017	3" Electrical Conduit-PVC Schedule 80-Trenched	LF	\$6.50
870018	3" Electrical Conduit-PVC Schedule 80-Slotted	LF	\$7.00
870019	3" Electrical Conduit-PVC Schedule 80-Elbow	EA	\$15.00
870020	4" Electrical Conduit-PVC Schedule 80-Riser	LF	\$15.00
870021	4" Electrical Conduit-PVC Schedule 80-Pushed	LF	\$20.00
870022	4" Electrical Conduit-PVC Schedule 80-Trenched	LF	\$6.50
870023	4" Electrical Conduit-PVC Schedule 80-Slotted	LF	\$21.00
870024	4" Electrical Conduit-PVC Schedule 80-Elbow	EA	\$45.00

HOWARD COUNTY - DEPARTMENT OF PLANNING AND ZONING
APPROVED UNIT PRICES AND ITEM CODES
(County Council Resolution # -2022)
Effective Date: 7/1/2022

ITEM CODE	DESCRIPTION	UNIT	UNIT COST
870200	2" U-guard	LF	\$11.00
870201	3" U-guard	LF	\$15.00
870202	Trenching & Backfill	LF	\$7.00
870203	Meter Socket	EA	\$50.00
870204	Disconnect Switch NEMA Type 3R-30 Amp	EA	\$135.00
870205	Disconnect Switch NEMA Type 3R-60 Amp	EA	\$150.00
870206	Disconnect Switch NEMA Type 4-30 Amp Stainless Steel	EA	\$1,100.00
870207	Disconnect Switch NEMA Type 4-60 Amp Stainless Steel	EA	\$1,200.00
870208	Ground Rod w/Clamp	EA	\$20.00
870209	Breakaway Connector Kit-Bussman #HEBAWRLC-J or Approved Equal	EA	\$50.00
870210	Install County Supplied Telemetry Cable-Self Supporting (Overhead)(Any Size)	LF	\$0.60
870211	Install County Supplied Telemetry Cable-Jelly Filled (Underground)(Up to 12 Pairs)	LF	\$0.60
870212	Install County Supplied Telemetry Cable-Jelly Filled (Underground)(Over 12 Pairs)	LF	\$1.10
870213	Install LDF4 Coaxial Cable	LF	\$0.50
870214	Install Opticom Detector Cable	LF	\$5.00
870215	Loop Wire - 14 THWN in 1/4" Flexible Tubing-For Loop Detector Work Independent of Other S	LF	\$1.00
870216	Loop Wire - 14 AWG THWN in 1/4" Flexible Tubing	LF	\$1.00
870217	Belden 8281 Coaxial Cable	LF	\$1.25
870218	Install County Supplied Video Camera Cable (Traficam)	LF	\$0.50
870219	Install County Supplied Autoscope Video Cable	LF	\$5.00
870300	Electrical Cable-1 Conductor-14 AWG Aluminum Shielded (Loop Lead in Wire)	LF	\$0.25
870301	Electrical Cable-2 Conductor-14 AWG Aluminum Shielded (Loop Lead in Wire)	LF	\$1.25
870302	Electrical Cable-2 Conductor-14 AWG-ISMA 19-1	LF	\$0.40
870303	Electrical Cable-3 Conductor-14 AWG-ISMA 19-1	LF	\$0.60
870304	Electrical Cable-5 Conductor-14 AWG-ISMA 19-1	LF	\$1.35
870305	Electrical Cable-7 Conductor-14 AWG-ISMA 19-1	LF	\$1.45
870306	Electrical Cable-10 Conductor-14 AWG-ISMA 19-1	LF	\$1.25
870307	Electrical Cable-15 Conductor-14 AWG-ISMA 19-1	LF	\$1.35
870308	Electrical Cable-20 Conductor-14 AWG-ISMA 19-1	LF	\$1.60
870309	Electrical Cable-2 Conductor-12 AWG Copper Type TC	LF	\$1.25
870310	Electrical Cable-2 Conductor-10 AWG Copper Type TC	LF	\$1.25
870311	Electrical Cable-1 Conductor-10 AWG-THWN Copper	LF	\$0.30
870312	Electrical Cable-1 Conductor-8 AWG-THWN Copper	LF	\$0.85
870313	Electrical Cable-1 Conductor-8 AWG-Solid Bare Copper	LF	\$0.55
870314	Electrical Cable-1 Conductor-6 AWG-Stranded Bare Copper	LF	\$0.65
870315	Electrical Cable-1 Conductor-6 AWG-THWN-Copper	LF	\$0.65
870316	Electrical Cable-1 Conductor-4 AWG-THWN-Copper	LF	\$0.70
870400	Ground mount sign supports	LF	\$15.00
870401	Install sign 0 to ≤ 5SF (Overhead Post)	EA	\$5.50
870402	Install sign > 5 SF to ≤ 25SF (Overhead Post)	EA	\$100.00
870403	Install sign > 25 SF to ≤ 50SF (Overhead Post)	EA	\$50.00
870404	Install sign > 50 SF to ≤ 100SF (Overhead Post)	EA	\$55.00
870410	Install Lighting Pole With Arm (Includes T-Base)	EA	\$350.00
870411	Install Lighting Arm on Strain Pole or Mast Arm Pole	EA	\$350.00
870412	Install Cobra Style Luminaire	EA	\$5.50
870413	Wood Pole - Class II (40')	EA	\$55.00
870414	Install Wood Pole	EA	\$11.00
870415	Install Strain Pole	EA	\$55.00
870416	Install Mast Arm Pole	EA	\$275.00
870417	Install Mast Arm	EA	\$275.00
870418	Install Pedestal Pole-Any Size-With Breakaway Base	EA	\$250.00
870419	Install Pedestal Pole-Any Size-on Existing Breakaway Base	EA	\$150.00
870420	Install 12' Washington Style Cast Iron Lamp Post	EA	\$2.25
870421	Install 14' Aluminum Pole with Solar or AC Powered Flashing School Zone Beacon/Sign Assem	EA	\$220.00
870422	Up to 2" Weather Head	EA	\$10.00
870423	3" Weather Head	EA	\$45.00
870424	Fuenish & Install Elbow in Existing Concrete Base-Includes Concrete	EA	\$165.00
870425	Grout Existing/New Pole Base	EA	\$25.00
870426	3/8" Span Wire	LF	\$0.25
870427	1/4" Span Wire	LF	\$0.20
870428	Adjust Span or Tether	EA	\$0.80
870429	Bull Ring	EA	\$1.25
870430	Black Guy	EA	\$1.00
870431	Adjust Black Guy	EA	\$1.00
870432	Install Signal Head	EA	\$105.00

HOWARD COUNTY - DEPARTMENT OF PLANNING AND ZONING
APPROVED UNIT PRICES AND ITEM CODES
(County Council Resolution # -2022)
Effective Date: 7/1/2022

ITEM CODE	DESCRIPTION	UNIT	UNIT COST
870433	Install Optically Programmed Signal Head	EA	\$3.50
870434	Install Pedestrian Signal Head	EA	\$94.00
870435	Install Pedestrian Pushbutton and Sign	EA	\$25.00
870436	Install Mast Arm Mounted Video Camera Detector w/County Supplied Astro-bracket Clamps	EA	\$225.00
870437	Photo Cell	EA	\$11.00
870438	Install Pole Mounted Radio Antenna w/County Supplied Astro Bracket Clamps	EA	\$72.00
870439	Install Opticom Detector w/County Supplied Astro Bracket Clamps	EA	\$50.00
870440	Install Flasher Cabinet	EA	\$55.00
870441	Install Terminal Cabinet (Splice Cabinet)	EA	\$28.00
870442	Install Control Cabinet-Base or Pole Mounted	EA	\$500.00
870443	Adjust Elevation of Existing Handbox-Frame and Cover	EA	\$50.00
870444	Traffic Signal Handbox (Pullbox)	EA	\$700.00
870445	Traffic Signal Handbox-Over Existing Conduits and Cable	EA	\$22.00
870446	Remove and Reinstall Existing Conduit Cable (Any Number)	LF	\$5.00
870447	Saw Cut 4-1/2" depth	LF	\$7.50
870448	Saw Cut 4-1/2" depth-For Loop Detector Work Independent of other Signal Work	LF	\$7.50
870449	Install Micro Loop Detector	EA	\$50.00
870500	Clean and Paint Strain Pole	EA	\$28.00
870501	Clean and Paint Pedestal Pole	EA	\$300.00
870502	Clean and Paint Mast Arm Pole	EA	\$350.00
870503	Clean and Paint Mast Arm	EA	\$350.00
870504	Clean and Paint Streetlight Arm	EA	\$275.00
870510	Relocate Any Existing Signal Head (Including Aiming and Adjusting)	EA	\$75.00
870511	Removal and Salvage of Signs Less Than 50 SF	EA	\$6.00
870512	Removal and Salvage of Signs Greater Than 50 SF	EA	\$11.00
870513	Removal and Salvage of Lighting Pole with Arm	EA	\$140.00
870514	Removal and Salvage of Lighting Arm on Pole	EA	\$13.00
870515	Removal and Salvage of Luminaire	EA	\$1.25
870516	Removal and Salvage of Span & Associated Wiring	EA	\$12.00
870517	Removal and Salvage Wood Pole	EA	\$1.25
870518	Removal and Salvage Strain Pole	EA	\$6.00
870519	Removal and Salvage Traffic Signal Mast Arm Pole	EA	\$165.00
870520	Remove Foundation 12" Below Grade	CY	\$450.00
870521	Removal and Salvage Mast Arm	EA	\$55.00
870522	Removal and Salvage Pedestal Pole	EA	\$30.00
870523	Removal and Salvage Pedestal Pole and Breakaway Base	EA	\$50.00
870524	Removal and Salvage Cabinet	EA	\$55.00
870525	Removal Signal Handbox	EA	\$5.00
870526	Relocate Existing Handbox	EA	\$13.00
870527	Removal and Salvage Any Signal Head	EA	\$35.00
870528	Removal and Salvage Pedestrian Signal Head	EA	\$20.00
870529	Removal and Salvage Pedestrian Pushbutton & Sign	EA	\$20.00
Developer Street Lights*			
Energy and Maintenance (For 2 years)			
870600	100-WATT HPS Vapor Fixture	EA	\$84.00
870601	150-WATT HPS Vapor Fixture	EA	\$90.00
870602	250-WATT HPS Vapor Fixture	EA	\$100.00
870603	400-WATT HPS Vapor Fixture	EA	\$120.00
870604	100-WATT MH Fixture	EA	\$138.00
870605	150-WATT MH Fixture	EA	\$145.00
Energy (For 2 years)			
870620	LED-100 Post-Top Fixture	EA	\$10.00
870621	LED-150 Post-Top Fixture	EA	\$12.00
870622	LED-100 COBRA Fixture	EA	\$10.00
870623	LED-150 COBRA Fixture	EA	\$15.00
870624	LED-200 COBRA Fixture	EA	\$19.00
870625	LED-250 COBRA Fixture	EA	\$30.00

*PASS-THROUGH FEES BASED ON RATES SET BY BGE