

# County Council Of Howard County, Maryland

2013 Legislative Session

Legislative Day No. 14

## Resolution No. 167-2013

Introduced by: The Chairperson at the request of the County Executive

A RESOLUTION pursuant to Sections 16.301 and 16.200(a) of the Howard County Code, granting a variance for government uses from the structure and use setback for an addition to the front of Deep Run Elementary School.

---

Introduced and read first time \_\_\_\_\_, 2013.

By order \_\_\_\_\_  
Sheila M. Tolliver, Administrator

Read for a second time at a public hearing on \_\_\_\_\_, 2013.

By order \_\_\_\_\_  
Sheila M. Tolliver, Administrator

This Resolution was read the third time and was Adopted\_\_\_, Adopted with amendments\_\_\_, Failed\_\_\_, Withdrawn\_\_\_, by the County Council on \_\_\_\_\_, 2014.

Certified By \_\_\_\_\_  
Sheila M. Tolliver, Administrator

NOTE: [[text in brackets]] indicates deletions from existing law; TEXT IN SMALL CAPITALS indicates additions to existing law; Strike-out indicates material deleted by amendment; Underlining indicates material added by amendment

1           **WHEREAS**, Section 16.200(a) and Section 16.301 of the Howard County Code provides  
2 that variances for governmental uses from the strict application of the zoning regulations are  
3 granted by the County Council by Resolution following a public hearing; and  
4

5           **WHEREAS**, the County has proposed an administration addition to the front of Deep  
6 Run Elementary School as shown in the attached Exhibit A; and  
7

8           **WHEREAS**, the site is zoned R-SA-8 (Residential: Single Attached), a category that  
9 imposes a 20 foot structure and use setback (building restriction line) from Old Waterloo Road, a  
10 public street right of way; and  
11

12           **WHEREAS**, Old Waterloo Road used to be known as Maryland Route 175 and was  
13 classified as an arterial highway; and  
14

15           **WHEREAS**, Old Waterloo Road now functions as a local road and requires a 20-foot  
16 building restriction line; and  
17

18           **WHEREAS**, the County proposes to encroach approximately 9 feet into the front 20-foot  
19 building restriction line for an addition to Deep Run Elementary School which will allow the  
20 implementation of a vestibule area for security measures along with the relocation of school  
21 administrative offices; and  
22

23           **WHEREAS**, the County requests a variance from the strict application of the 20-foot  
24 building restriction line in order to construct the school addition approximately 9 feet into the  
25 setback area; and  
26

27           **WHEREAS**, the County Council finds that the proposed variance from the setback  
28 (building restriction line) requirements of the R-SA-8 district for this governmental purpose is  
29 within the spirit and intent of the Zoning Regulations and is in the public interest.  
30

1           **NOW, THEREFORE, BE IT RESOLVED** by the County Council of Howard County,  
2 Maryland, this \_\_\_ day of \_\_\_\_\_, 2014 that, for the construction of the addition at Deep  
3 Run Elementary School, it grants a variance from the required 20-foot structure and use setback  
4 to be 11 feet in the R-SA-8 zoning district, as shown in the attached Exhibit A.

Exhibit A

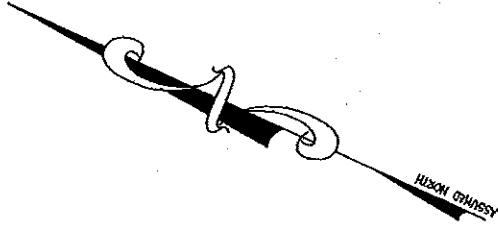

# DEEP RUN ELEMENTARY SCHOOL

▶ DENOTES BUILDING INGRESS/EGRESS POINTS

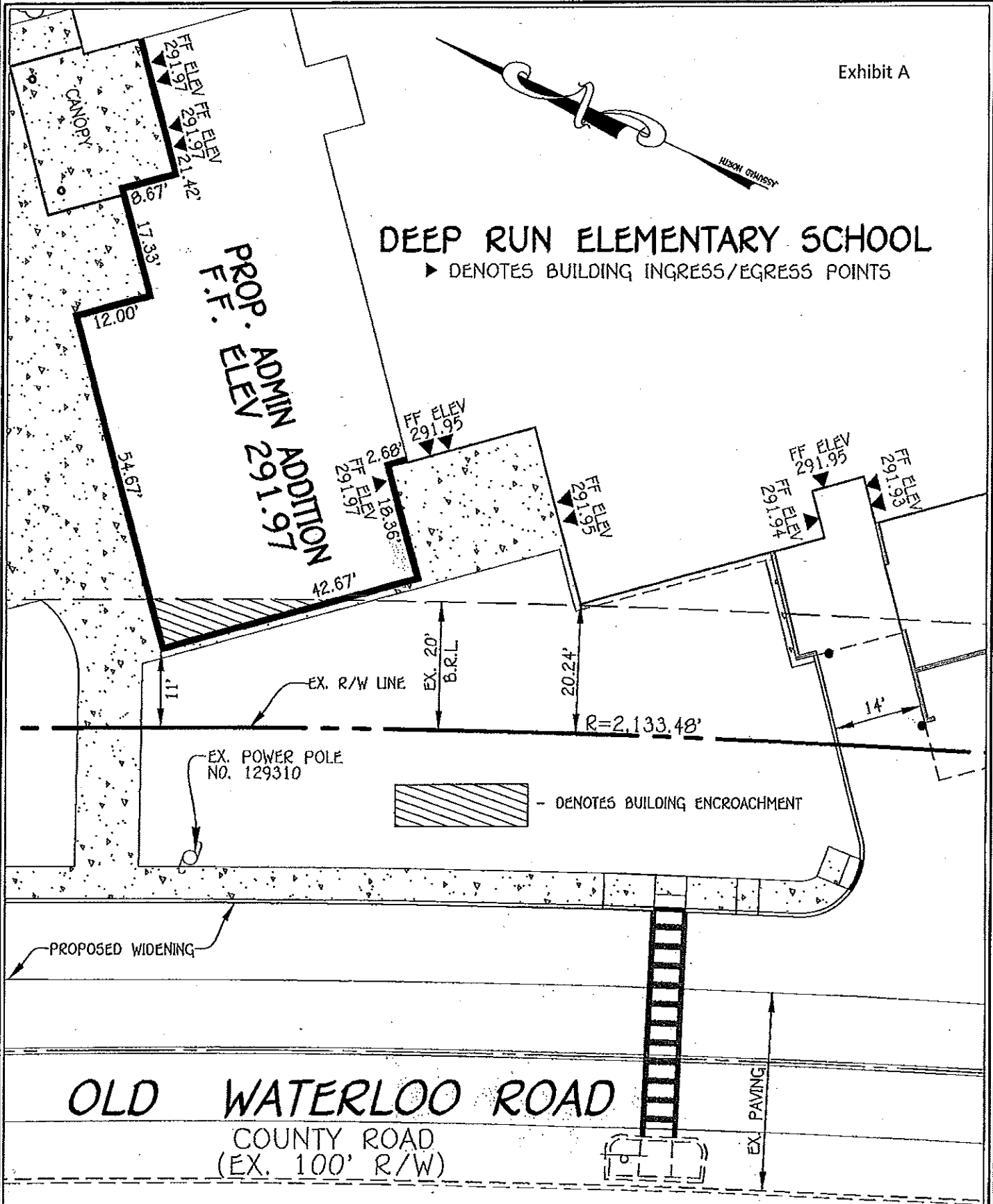

**FISHER, COLLINS & CARTER, INC.**  
 CIVIL ENGINEERING CONSULTANTS & LAND SURVEYORS  
 CENTENAL SQUARE OFFICE PARK - 10272 BALTIMORE NATIONAL PECE  
 ELlicOTT CITY, MARYLAND 21012  
 (410) 461 - 2655

**DEEP RUN ELEMENTARY SCHOOL**  
**BUILDING ENCROACHMENT EXHIBIT**

ZONED RSA-8  
 TAX MAP No.: 37  
 1st ELECTION DISTRICT  
 SCALE: 1" = 20'  
 DATE: SEPT. 30, 2013