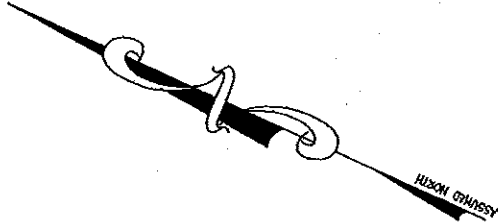
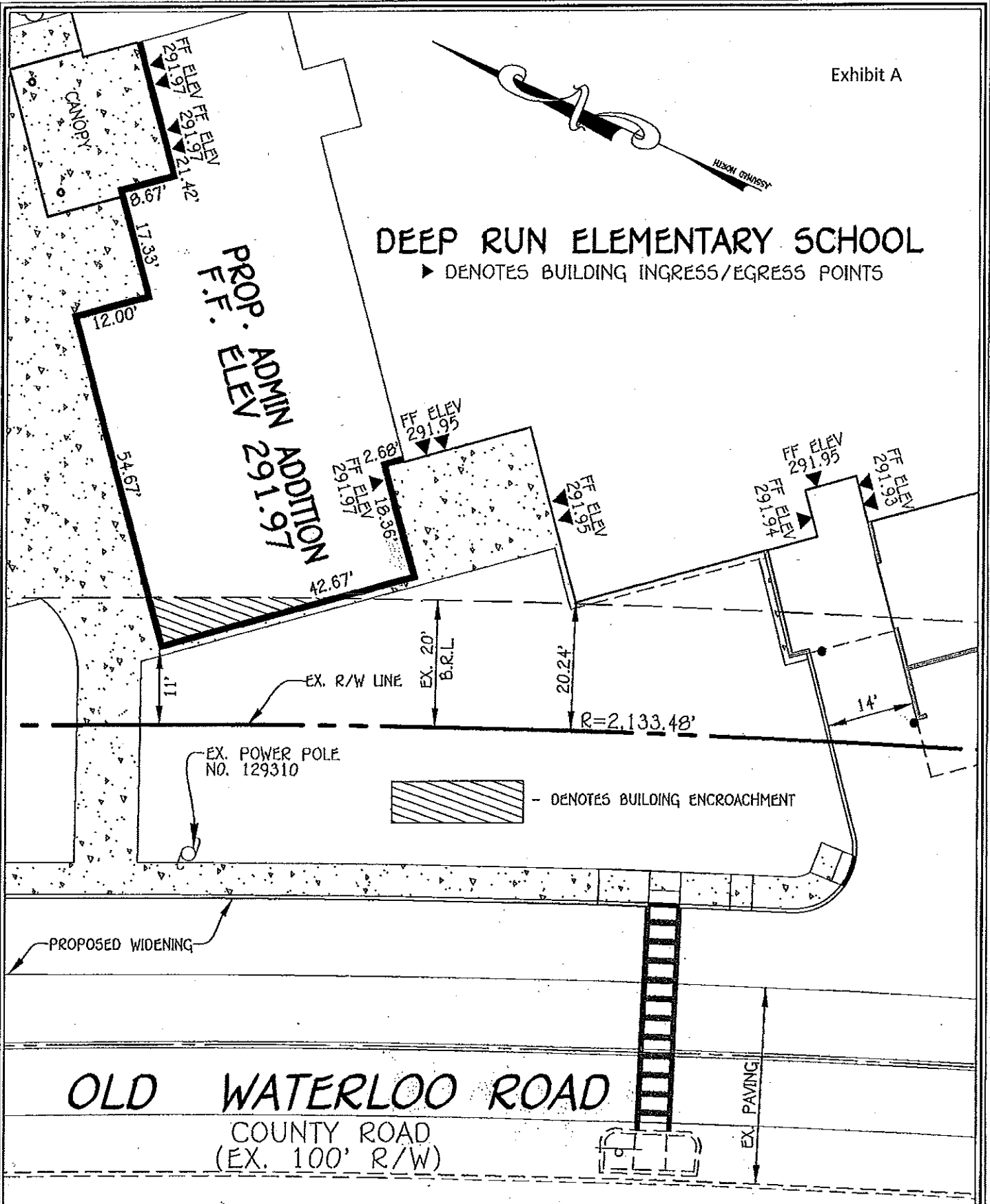

Exhibit A



DEEP RUN ELEMENTARY SCHOOL

▶ DENOTES BUILDING INGRESS/EGRESS POINTS



FISHER, COLLINS & CARTER, INC.
 CIVIL ENGINEERING CONSULTANTS & LAND SURVEYORS
 CENTENAL SQUARE OFFICE PARK - 10272 BALTIMORE NATIONAL PECE
 ELICOTT CITY, MARYLAND 21012
 (410) 461 - 2652

DEEP RUN ELEMENTARY SCHOOL
BUILDING ENCROACHMENT EXHIBIT

ZONED RSA-8
 TAX MAP No.: 37
 1st ELECTION DISTRICT
 SCALE: 1" = 20'
 DATE: SEPT. 30, 2013