

County Council Of Howard County, Maryland

2015 Legislative Session

Legislative Day No. 5

Resolution No. 76-2015

Introduced by: The Chairperson at the request of the County Executive

A RESOLUTION approving schedules of fees for the functions regulated by the Department of Public Works.

Introduced and read first time May 4, 2015.

By order

Jessica Feldmark
Jessica Feldmark, Administrator

Read for a second time at a public hearing on May 18, 2015.

By order

Jessica Feldmark
Jessica Feldmark, Administrator

This Resolution was read the third time and was Adopted ☒, Adopted with amendments ☒, Failed ☐, Withdrawn ☐, by the County Council on May 22, 2015.

Certified By

Jessica Feldmark
Jessica Feldmark, Administrator

NOTE: [[text in brackets]] indicates deletions from existing law; TEXT IN SMALL CAPITALS indicates additions to existing law; Strike-out indicates material deleted by amendment; Underlining indicates material added by amendment

1 **WHEREAS**, Section 14.600 and Section 14.601 of the Howard County Code provide
2 that, upon the recommendation of the Director of Public Works, the County Council shall adopt
3 an annual schedule of permit charges, user fees, special charges and late payment penalties for
4 users of the Howard County Sanitary Landfill; and

5
6 **WHEREAS**, Section 18.700 requires the Director of Public Works to prepare a proposed
7 fee schedule to cover the cost of services performed by the Department of Public Works related
8 to the physical inspection and approval of infrastructure in subdivisions and site development
9 plans as shown on the approved subdivision and site development plans; and

10
11 **WHEREAS**, Section 16.130 of the Howard County Code requires developers to pay for
12 the costs of public improvements (water and sewer facilities) required by Section 16.131, which
13 costs include the costs incurred by the Department of Public Works in reviewing the plans for the
14 facilities; and

15
16 **WHEREAS**, Section 18.204 of the Howard County Code requires that the Council set,
17 by annual resolution, a fee to cover notification costs incurred by the County when a road is
18 petitioned for closing or relocation; and

19
20 **WHEREAS**, Section 18.206 of the Howard County Code requires utility contractors and
21 other persons who excavate on public property to obtain a permit for the work, and further
22 provides for County Council approval of a fee for such a permit; and

23
24 **WHEREAS**, Section 18.402 of the Howard County Code provides that abutting property
25 owners shall repair or replace sidewalk that is unsafe for public use and further provides that, at
26 the abutting property owner's request, the Department of Public Works may do the sidewalk
27 repair or replacement and bill the property owner for the cost of the work; and

28
29 **WHEREAS**, even though in certain circumstances it is appropriate to amend or extend
30 developer agreements, the County incurs costs in reviewing the agreement and the development
31 to determine whether appropriate progress has been made in meeting the requirements of the

1 Agreement, and therefore charges a fee for approving the amendment or extension of the
2 developer agreement; and
3

4 **WHEREAS**, Section 21.208 of the Howard County Code authorizes the County Council
5 to establish by resolution an annual service fee and the cost of installation of signs when the
6 Department of Public Works issues a permit to establish a loading zone; and
7

8 **WHEREAS**, Section 3.405 of the Howard County Code requires an applicant to provide
9 surety for grading and constructing sediment control; and
10

11 **WHEREAS**, Section 20.901 of the Howard County Code requires the County Council to
12 establish by Resolution the refuse collection charges for residential and commercial property;
13 and to establish the Ellicott City Refuse Collection Zone; and
14

15 **WHEREAS**, Section 16.511 of the Howard County Code provides that the mobile home
16 park refuse collection charge shall be adopted by Resolution of the County Council; and
17

18 **WHEREAS**, the County Executive, upon the recommendation of the Director of Public
19 Works has proposed certain changes in the fees and charges for functions regulated through the
20 Department of Public Works.
21

22 **NOW, THEREFORE, BE IT RESOLVED** by the County Council of Howard County,
23 Maryland this 22nd day of May, 2015 that it adopts the fee schedules attached to this
24 Resolution for the following functions regulated through the Department of Public Works:

- 25 (1) Review and approval of water and sewer facilities for subdivisions and site development;
26 and
27 (2) Miscellaneous DPW Fees and Charges; and
28

29 **BE IT FURTHER RESOLVED** that the fee schedules shall be effective July 1, 2015
30 and shall continue in effect until changed or repealed by subsequent resolution.

LANDFILL FEES

These fees are adopted pursuant to Section 14.600 and Section 14.601 of the Howard County Code, which provide that the County Council shall adopt an annual schedule of permit charges, user fees, special charges, and late payment penalties for users of the Howard County Sanitary Landfill.

NOTE: No solid waste generated from out-of-County sources will be accepted at the Howard County Alpha Ridge Landfill.

ANNUAL PERMIT CHARGE

| | |
|---|-----------|
| Commercial permit (renewable each June) | \$30 |
| Commercial Recycling Permit | No Charge |

USER CHARGES

Residential solid waste

No charge for Howard County residents bringing solid waste to the landfill in:

- (1) Vehicles up to 3/4 ton GVW registered in Howard County; or
- (2) Vehicles registered as farm vehicles with the Motor Vehicle Administration hauling qualifying waste.

Residents bringing in household waste must apply for a special exception permit if vehicle is not registered as a farm vehicle, is over 3/4 ton GVW, is not registered to resident, or displays commercial signage.

A maximum of 1 ton of household waste will be accepted from a County resident at no charge during a 1-year period from July through June. Commercial user charges shall be charged for quantities exceeding 1 ton per year.

| | |
|---------------|--------------|
| Carpet | \$55 per ton |
|---------------|--------------|

Clean dirt

| | |
|---|---------------|
| Clean dirt free of trash and rubble (charge may be waived or volume may be limited by the Department of Public Works) | \$100 per ton |
|---|---------------|

Clean Wood/Yard Trim clean wood trim includes brush, tree branches, unpainted and untreated lumber, grass, leaves and barn cleanings.

| | |
|--|--------------|
| Residential | No charge |
| Commercial (After verification that wood waste is clean) | \$25 per ton |

| | |
|--|---|
| Commercial solid waste (tires must be delivered separately) | \$65 per ton <u>\$80 per ton</u> |
|--|---|

Commercial Auto and truck tires

| | |
|------------|---------------|
| Auto tires | \$130 per ton |
|------------|---------------|

| | |
|---|---------------|
| Truck (oversized) tires | \$190 per ton |
| Commercial mattresses and box springs (Mixed with Trash-Trash) | \$85 per ton |
| Commercial mattresses and box springs (Clean Loads- Recycled) | \$50 per ton |
| Commercial cardboard (75% or more of load, delivered a waste) | \$85 per ton |
| Commercial appliances with Freon | \$10 each |
| Broken paving, stone or brick | \$100 per ton |
| Shingles | \$55 per ton |
| Boats, house trailers and campers | \$65 per ton |
| All Boats, House Trailers and Campers not to exceed 30 feet in length. Acceptance may be limited by the Department of Public Works. | |

SCHEDULE FOR USE WHEN SCALES ARE INOPERATIVE

| Size of Vehicle | Solid Waste | Recyclable Yard/Wood Waste |
|--|--------------------|-----------------------------------|
| Pickup trucks & leisure vans (½ to ¾ ton) | \$20 | \$4 |
| Pickup trucks with side rails, caps, or dump bed | \$27 | \$7 |
| Dump trucks (2 axle) | \$146 | \$39 |
| Dump trucks (3 or 4 axle) | \$249 | \$66 |
| Closed vans (2 axle) | \$89 | \$23 |
| Closed vans (3 or 4 axle) | \$130 | \$35 |
| Stake body/open body trucks or trailer dump (2 axle) | \$249 | \$66 |
| Stake body/open body trucks or trailer dump (3 axle) | \$303 | \$80 |
| Front, rear and side load compactor | | |
| under 16 cu.yd. | \$184 | \$49 |
| 16-23 cu.yd. | \$249 | \$66 |
| 24 cu.yd. and over | \$374 | \$100 |
| Semi-trailer | Not Accepted | \$80 |
| Roll off bed | | |
| under 25 cu.yd. | \$249 | \$66 |
| 25 - 34 cu.yd. | \$303 | \$80 |
| 35 cu.yd. and over | \$374 | \$100 |
| Auto and Truck Tires | | |
| Auto tires | | |
| Up to 30 tires | \$30 flat rate | |
| Over 30 tires | \$1.50 per tire | |
| Truck (oversized) tires | | |
| Up to 10 tires | \$30 flat rate | |
| Over 10 tires | \$3.50 per tire | |

NOTE: A maximum of four (4) auto tires per visit may be delivered to the Resident's Convenience Area by residents at no charge. Farm vehicles are also limited to four (4) auto tires per visit. Deliveries of greater than 4 tires will be charged the per ton commercial user charge.

SPECIAL LANDFILL CHARGES

| | |
|--|---|
| Credit account deposit (amount to be paid before credit is initially extended) | \$200.00 minimum |
| Credit account deposit - maintenance surety (amount for maintaining extension of credit; reviewed and adjusted every 6 months) | 1.5 times average monthly statement |
| Late payment penalty assessed on the last County work day of the month following the month on which charges are billed. All statements will indicate the penalty date. | 10% of unpaid balance –every 30 days balance is due |
| Service charge for failure to weigh out | \$ 25.00, Plus rate per ton calculated using waste type and vehicle's tare weight |
| Commercial vehicles remaining after closing time Or unloading longer than the 30-minute time limit | \$100 per 30 minutes |

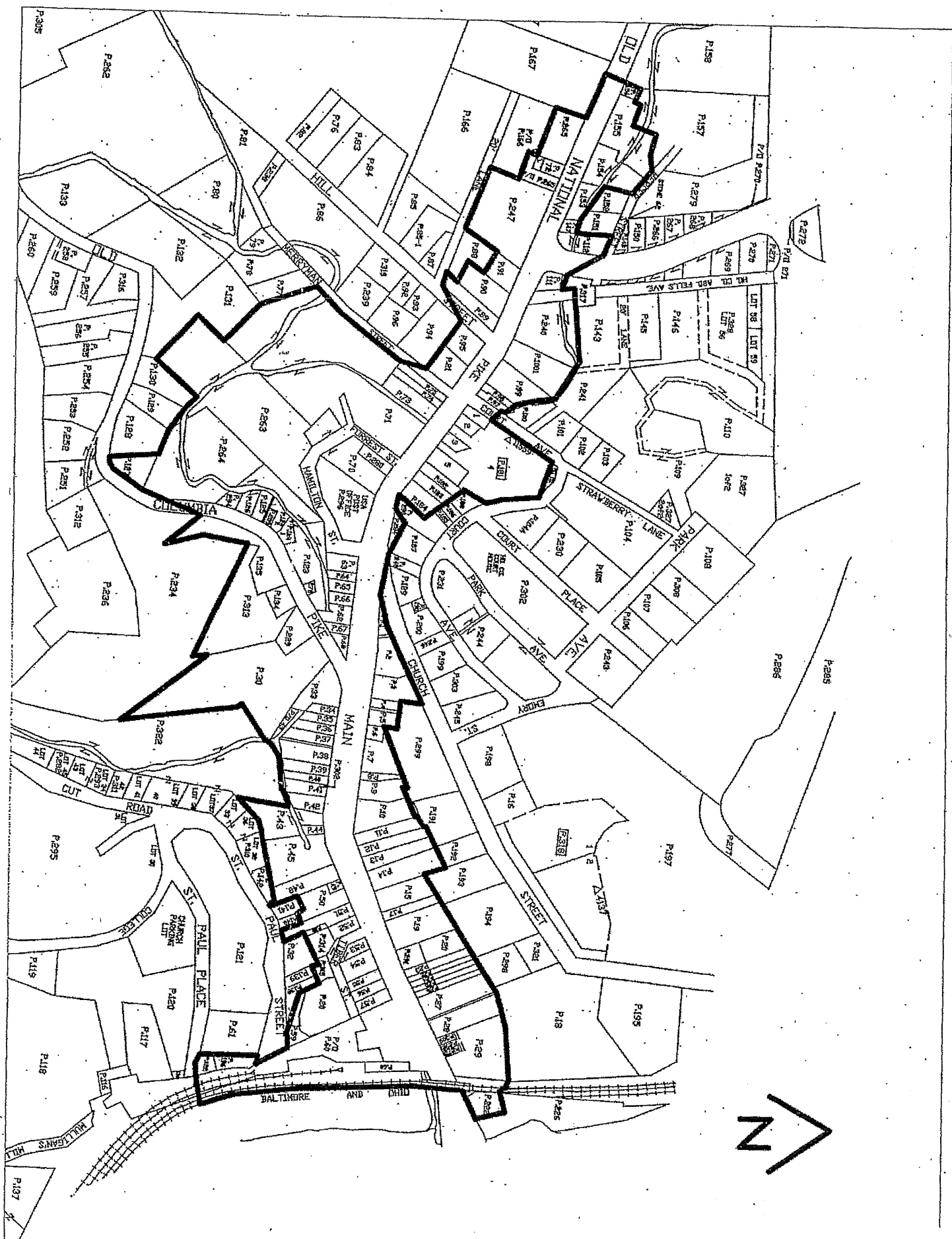

REFUSE COLLECTION CHARGES

These charges are adopted pursuant to Section 20.901 of the Howard County Code, which requires the County Council to establish by Resolution the refuse and recycling collection charges for residential and commercial property, and to establish the Ellicott City Refuse Collection Zone.

| Refuse Collection Charges | |
|---|--|
| Residential Property | \$210 per year for 1 collection per week of refuse and recyclable materials |
| Residential Property | \$15 per year for 1 collection per week of yard waste during the collection season |
| Residential Property – Private Roads | \$39 per year for 1 collection per week of recyclable materials only. The entire community must “opt out” or charge will be assessed on each individual homeowner. |
| Commercial Property – Ellicott City Refuse Collection Zone Only | \$210 per year for each collection, 2 or 4 collections per week |
| Mobile Home Park | \$17.50 per month for 1 collection per week of refuse and recyclable materials (charge based on the number of occupied, permitted sites) |
| Mobile Home Park | \$1.25 per month for 1 collection per week of yard waste during the collection season (charge based on the number of occupied, permitted sites) |
| Mobile Home Park | \$3.25 per month for 1 collection per week of recyclable materials only (charge based on the number of occupied, permitted sites) |

The Department of Public Works Refuse and Recyclables Collection Rules shall govern the size and weight of acceptable items, and the composition of containers.

Commercial Property is property in Ellicott City Refuse Collection Zone.

ELLICOTT CITY REFUSE COLLECTION ZONE

The Service area boundary for the Commercial Property for which the County provides refuse collection services is the Ellicott City Refuse Collection Zone. The Zone is defined in Exhibit A which is attached hereto and incorporated herein.

**DEPARTMENT OF PUBLIC WORKS
ENGINEERING REVIEW FEE SCHEDULE
Effective July 1, 2015**

These fees are pursuant to Section 16.130 and Section 16.131 of the Howard County Code, which requires developers to pay for the costs of public improvements (water and sewer facilities), which costs include the costs incurred by the Department of Public Works in reviewing the plans for the facilities:

| COMMERCIAL, INDUSTRIAL & MULTI-FAMILY SITE DEVELOPMENT PLANS | | |
|---|---|--|
| Total Estimated Site Construction Costs | Fee For Private Roads, Parking Lots & Storm Water Management** | Fee For Private Storm Drains, Water & Sewer** |
| Less than \$ 50,000 | 2.75% | 0.8% |
| \$ 50,001 - \$150,000 | 2.50% | 0.7% |
| \$150,001 - \$250,000 | 2.25% | 0.6% |
| over \$250,000 | 2.00% | 0.5% |

**

- [[1. The final fee is calculated based on actual construction quantities and the Howard County Department of Planning and Zoning Approved Unit Prices and Item Codes, dated July 1, 2015 (See attached Exhibit 1)
2. Final fee is to be paid in full prior to submission of plan for signature approval.
3. A partial advance fee is to be paid with the initial submission of the site development plan for review. This partial fee shall be 50% of the fee based upon the developer's preliminary construction cost estimate.
4. Minimum fee \$100
5. Red-line changes to approved plans are \$200 per submittal
6. Fees represent half of the total fee charged. The total fee is shared between DPW and DPZ.]]
1. FEES REPRESENT HALF OF THE TOTAL FEE CHARGED. THE TOTAL FEE IS SHARED BETWEEN DPW AND DPZ.
2. A PARTIAL ADVANCE FEE IS TO BE PAID IN FULL PRIOR TO SUBMISSION OF PLAN FOR SIGNATURE APPROVAL. THIS PARTIAL FEE SHALL BE 50% OF THE FEE BASED UPON THE DEVELOPER'S PRELIMINARY CONSTRUCTION COST ESTIMATE. THE MINIMUM FEE IS \$100.
3. THE FINAL FEE IS CALCULATED BASED ON ACTUAL CONSTRUCTION QUANTITIES AND THE HOWARD COUNTY DEPARTMENT OF PLANNING AND ZONING'S APPROVED UNIT PRICES AND ITEM CODES, DATED JULY 1, 2015 (SEE ATTACHED EXHIBIT 1).
4. FINAL FEE IS TO BE PAID IN FULL PRIOR TO SUBMISSION OF PLAN FOR SIGNATURE APPROVAL.

| FINAL SUBDIVISIONS WITH PUBLIC ROADS AND STORM DRAINAGE STRUCTURES | |
|---|-------------------------------|
| Cost of Improvements | Fee* |
| Less than \$50,000 | 2.75% but not less than \$100 |
| \$50,001 - \$150,000 | 2.5% |
| \$150,001 - \$250,000 | 2.25% |
| Over \$250,000 | 2% |

- [[*1. The final fee is calculated based on actual construction quantities and the Howard County Department of Planning and Zoning Approved Unit Prices and Item Codes, dated July 1, 2015 (See attached Exhibit 1)
- Final fee is to be paid in full prior to submission of plat for signature approval.
 - A partial advance fee is to be paid when the Preliminary Plan or Preliminary Equivalent Sketch Plan original is submitted for signature. This partial fee shall be 50% of the fee based upon the developer's preliminary construction cost estimate.
 - Minimum fee \$100
 - Red-line changes to approved plans are \$200 per submittal.
 - Fees represent half of the total fee charged. The total fee is shared between DPW and DPZ.]]

*

- FEES REPRESENT HALF OF THE TOTAL FEE CHARGED. THE TOTAL FEE IS SHARED BETWEEN DPW AND DPZ.
- A PARTIAL ADVANCE FEE IS TO BE PAID IN FULL PRIOR TO SUBMISSION OF PLAN FOR SIGNATURE APPROVAL. THIS PARTIAL FEE SHALL BE 50% OF THE FEE BASED UPON THE DEVELOPER'S PRELIMINARY CONSTRUCTION COST ESTIMATE. THE MINIMUM FEE IS \$100.
- THE FINAL FEE IS CALCULATED BASED ON ACTUAL CONSTRUCTION QUANTITIES AND THE HOWARD COUNTY DEPARTMENT OF PLANNING AND ZONING APPROVED UNIT PRICES AND ITEM CODES, DATED JULY 1, 2015 (SEE ATTACHED EXHIBIT 1).
- FINAL FEE IS TO BE PAID IN FULL PRIOR TO SUBMISSION OF PLAN FOR SIGNATURE APPROVAL.

| REVIEW OF SUBDIVISIONS AND SITE DEVELOPMENT PLANS WATER & SEWER FACILITIES | | |
|---|--|--|
| Work To Be Done | Partial Advance Fee | Total Fee |
| Review of water or sewer systems, including engineering, administrative and legal costs associated with the review. | 1.75% of DPZ's established unit cost for sewer main and established unit cost for water main and fire hydrant (attached as "Exhibit 1"). Must be deposited with application for preliminary plan approval based on quantities shown on developer's preliminary plan. | 3.5% of DPZ's established unit cost for sewer main and established unit cost for water main and fire hydrant (attached as "Exhibit 1"), based on quantities shown on developer's approved construction drawings and paid prior to delivery of developer agreement for execution. |

Total fee of 7% is shared fees between DPZ and DPW

**REVIEW AND APPROVAL OF WATER & SEWER FACILITIES
FOR SUBDIVISIONS AND SITE DEVELOPMENT**

These fees are adopted pursuant to Section 16.130 of the Howard County Code which requires developers to pay for the costs of public improvements (water and sewer facilities) required by Section 16.131, which costs include the costs incurred by the Department of Public Works in reviewing the plans for the facilities and in inspecting them during construction.

Construction Inspection of Private and Public Water and Sewer

| WORK | CHARGE* (NON-REBATABLE) |
|--|--|
| Single Family Detached (ex: R-12, R-20, etc.) No Minor Subdivisions | \$600 per lot |
| Townhome, Cluster Home No Minor Subdivisions | \$250 per lot |
| Minor Subdivisions, Site Development Plans, etc. | \$800 Lump Sum Administration and Project Coordination Fee, plus \$7 per linear foot Field Inspection Fee. |
| Inspection of private water & sewer 8" or larger (from the connection to within 5 feet of the building improvement). | \$800 Lump Sum Administration and Project Coordination Fee, plus \$7 per linear foot Field Inspection Fee. |
| TV Inspection | \$.60 per foot, to be paid prior to delivery of developer agreement for execution. |

* These fees cover the costs associated with the inspection of water and sewer facilities during the construction time established in the developer agreement and construction documents. If construction time exceeds the established time, additional inspection fees will be charged in the amount of 1.5% of the total estimated construction costs included in the developer agreement with a minimum fee of \$1,500.

UTILITY CONSTRUCTION PERMITS

This fee is adopted pursuant to Section 18.206 of the Howard County Code, which requires utility contractors and other persons who excavate in the public roads and rights-of-way to obtain a permit for the work, and further provides for County Council approval of a fee for such a permit.

This fee applies only to work in existing subdivisions and existing public rights-of-way and easements. The fee does not apply to utility construction in projects being constructed in accordance with the subdivision regulations.

Annual Blanket Utility Permit for repair and maintenance

| | |
|-------------------------------------|-----------------------------|
| Gas or electric utility | \$[[12,000]]36,000 per year |
| [[Telephone]] COMMUNICATION utility | \$[[3,600]]10,000 per year |
| [[Cable TV utility]] | [[\$ 1,200 per year]] |

Utility Construction Permit for *repair and maintenance* by a utility that *is not operating* under a blanket utility permit \$[[100]]300 each permit

Utility Construction Permit for *new utility construction* work by a utility that *is operating* under a Blanket Utility Permit \$[[100]] 300 each permit

Utility Construction Permit for *new utility construction* work by a utility that *is not operating* a Blanket Utility Permit \$[[200]]600 each permit

REINSPECTION SURCHARGE

A REINSPECTION SURCHARGE SHALL BE IMPOSED FOR UTILITY INSTALLATION SITES WHICH REQUIRED MORE THAN ONE REINSPECTION TO VERIFY OR DETERMINE COMPLIANCE WITH A NOTICE OF VIOLATION ISSUED.

| | |
|--|-------|
| 2 ND REINSPECTION (3 RD VISIT TO PROPERTY) | \$100 |
| 3 RD REINSPECTION (4 TH VISIT TO PROPERTY) | \$150 |
| 4 TH REINSPECTION (5 TH VISIT TO PROPERTY) | \$200 |

LOADING ZONE PERMIT/SIGN INSTALLATION FEES

These fees are established pursuant to Section 21.208 of the County Code, which authorizes the County Council to establish an annual service fee and the cost of installation of signs when the Department of Public Works issues a permit to create a loading zone.

Cost of installation of signs indicating the border of a loading zone established under a permit.

\$160 per sign.

Annual service fee for a loading zone permit.

\$25 per year or portion of a year.

GRADING SURETY

These fees are adopted pursuant Section 3.405 of the Howard County Code that requires an applicant to provide surety for grading and constructing sediment control

Surety shall be based on the size of the area to be disturbed and the type of construction. The amount of the surety shall be determined using the following schedule:

| | |
|-------------------------------|---|
| Residential/utility grading | \$300 for the 1 st 5000 sq. ft. plus \$.02 for each additional square foot of disturbed area |
| Commercial/industrial grading | \$2,500 for the 1 st 5000 sq. ft. plus \$.04 for each additional square foot of disturbed area |

MISCELLANEOUS DPW FEES AND CHARGES

SERVICE

COST

Sidewalk repair/replacement

Actual cost to the County

Amendment, extension, or revision of Developer Agreements

Cost for a project with up to 4 agreements

\$400 per agreement

Cost for a project with 5 or more agreements

\$1,600 per project

Petition for road closing/road relocation

\$1,500

Additional recycling containers

18 gallon

\$7.50 each

35 gallon

\$36.00 each

65 gallon

\$45.00 each

HOWARD COUNTY - DEPARTMENT OF PLANNING AND ZONING
APPROVED UNIT PRICES AND ITEM CODES
 (County Council Resolution # -2015)
 Effective Date: 7/1/2015

| ITEM CODE | DESCRIPTION | UNIT | UNIT COST |
|-------------------------------|---|-------|-------------|
| GENERAL | | | |
| 110100 | Clearing & Grubbing (based on clearing wooded areas only) | AC | \$5,000.00 |
| 110101 | Tree Removal - Under 10" Diameter | EA | \$275.00 |
| 110102 | Tree Removal - 10" to 15" Diameter | EA | \$345.00 |
| 110103 | Tree Removal - 15" to 30" Diameter | EA | \$690.00 |
| 110104 | Tree Removal - Greater than 30" Diameter | EA | \$1,625.00 |
| 110105 | Transplant Street Trees | EA | \$135.00 |
| 110106 | Abandon Existing Well | LS | \$2,000.00 |
| 110200 | Removal & Disposal of Existing Buildings (specific based on size & materials) | LS | \$10,300.00 |
| 110201 | Engineers Office Type A | LS | \$20,000.00 |
| 110202 | Engineers Office Type B | LS | \$24,000.00 |
| 110203 | Engineers Office Type C | LS | \$34,000.00 |
| 110204 | Cellular Telephone | EA | \$19.00 |
| 110205 | Portable Toilet (Per Month) | MO | \$95.00 |
| 110206 | Digital Camera | EA | \$1,000.00 |
| MAINTENANCE OF TRAFFIC | | | |
| 110300 | 5" Yellow Nontoxic Lead Free Waterborne Pavement Marking Paint | LF | \$0.25 |
| 110301 | 5" White Nontoxic Lead Free Waterborne Pavement Marking Paint | LF | \$0.25 |
| 110302 | 10" Yellow Nontoxic Lead Free Waterborne Pavement Marking Paint | LF | \$0.25 |
| 110303 | 10" White Nontoxic Lead Free Waterborne Pavement Marking Paint | LF | \$0.25 |
| 110304 | 12" White Nontoxic Lead Free Waterborne Pavement Marking Paint | LF | \$1.00 |
| 110305 | 16" White Nontoxic Lead Free Waterborne Pavement Marking Paint | LF | \$2.00 |
| 110306 | 24" White Nontoxic Lead Free Waterborne Pavement Marking Paint | LF | \$4.80 |
| 110310 | 4" Yellow Removable Preformed Pavement Line Markings | LF | \$1.20 |
| 110311 | 4" White Removable Preformed Pavement Line Markings | LF | \$1.50 |
| 110312 | 5" Yellow Removable Preformed Pavement Line Markings | LF | \$1.25 |
| 110313 | 5" White Removable Preformed Pavement Line Markings | LF | \$1.25 |
| 110314 | 10" Yellow Removable Preformed Pavement Line Markings | LF | \$2.50 |
| 110315 | 10" White Removable Preformed Pavement Line Markings | LF | \$2.50 |
| 110316 | 12" White Removable Preformed Pavement Line Markings | LF | \$4.25 |
| 110317 | 16" White Removable Preformed Pavement Line Markings | LF | \$5.30 |
| 110318 | 24" White Removable Preformed Pavement Line Markings | LF | \$7.65 |
| 1103320 | Removable Preformed Letters | EA | \$70.00 |
| 1103321 | Removable Preformed Symbols | EA | \$275.00 |
| 1103322 | Removable Preformed Arrows | EA | \$233.00 |
| 1103323 | Removable Preformed Numbers | EA | \$233.00 |
| 1103324 | Removal of Removable Preformed Letters, Symbols, Arrows and Numbers | EA | \$452.00 |
| 1103325 | Removal of Removable Preformed Pavement Markings - Any Width | LF | \$0.13 |
| 110330 | 8" Removable Patterned Black Line Mask Tape for Maintenance of Traffic | LF | \$3.00 |
| 110340 | Maintenance of Traffic | LS | \$33,000.00 |
| 110341 | Bank Run Gravel Subbase for Maintenance of Traffic | TON | \$22.50 |
| 110342 | Graded Aggregate Subbase for Maintenance of Traffic | TON | \$15.00 |
| 110343 | Crusher Run Aggregate CR-6 for Maintenance of Traffic | TON | \$22.50 |
| 110344 | Graded Aggregate Base for Maintenance of Traffic | TON | \$22.50 |
| 110345 | Hot Mix Asphalt for Maintenance of Traffic | TON | \$95.00 |
| 110346 | Hot Mix Asphalt Curb for Maintenance of Traffic | LF | \$5.50 |
| 110347 | Steel Plate 8'x12'x1" max. for Maintenance of Traffic (Per Day) | EA/DY | \$5.00 |

HOWARD COUNTY - DEPARTMENT OF PLANNING AND ZONING
APPROVED UNIT PRICES AND ITEM CODES
(County Council Resolution # -2015)
Effective Date: 7/1/2015

| ITEM CODE | DESCRIPTION | UNIT | UNIT COST |
|-----------|--|------|------------|
| 110350 | Traffic Manager | DY | \$150.00 |
| 110351 | Arrow Panel | UD | \$38.75 |
| 110352 | Portable Flashing Arrow Panel | DY | \$38.75 |
| 110353 | Temporary Traffic Signs Type III Retro reflective Sheeting | SF | \$12.50 |
| 110354 | Temporary Traffic Signs High Performance Wide Angle Retro reflective Sheeting | SF | \$22.50 |
| 110355 | Temporary Raised Pavement Markers | EA | \$6.25 |
| 110356 | Signs for Maintenance of Traffic (Rental) | DY | \$10.00 |
| 110357 | Removal of Temporary Raised Pavement Markers | EA | \$0.75 |
| 110358 | Traffic Cones - 28" with Retro reflective Bands (Rental) | DY | \$43.75 |
| 110359 | Removal of Existing Painted Stripe Markings - Any Width (Grinding) | LF | \$1.25 |
| 110360 | 4" Temporary Pavement Striping Tape | LF | \$1.30 |
| 110361 | 5" Temporary Pavement Striping Tape | LF | \$1.75 |
| 110362 | 6" Temporary Pavement Striping Tape | LF | \$1.75 |
| 110363 | 8" Temporary Pavement Striping Tape | LF | \$2.35 |
| 110364 | Removal of Temporary Pavement Striping Tape- Any Width | LF | \$0.19 |
| 110365 | Removal of Existing Pavement Markings - Any Width | LF | \$18.75 |
| 110366 | Remove Existing Word Markings (Each Letter) | EA | \$12.50 |
| 110367 | Remove Existing Stop Bars - 24" | LF | \$5.00 |
| 110368 | Tubular Markers | EA | \$94.00 |
| 110369 | Replacement of Tubular Marker Mast | EA | \$55.00 |
| 110370 | Cones for Maintenance of Traffic | EA | \$20.00 |
| 110380 | Temporary Concrete Single Face Traffic Barrier for Maintenance of Traffic | LF | \$20.00 |
| 110381 | Temporary Precast Concrete Traffic Barrier for Maintenance of Traffic | LF | \$16.25 |
| 110382 | Reset Temporary Concrete Barrier Single Face | LF | \$13.75 |
| 110383 | Precast Temporary Concrete Traffic Barrier Transition Left Side | EA | \$5,000.00 |
| 110384 | Precast Temporary Concrete Traffic Barrier Transition Right Side | EA | \$5,000.00 |
| 110385 | Reset Temporary Precast Concrete Traffic Barrier for Maintenance of Traffic | LF | \$4.00 |
| 110386 | Reflective Barrier Markers | EA | \$6.75 |
| 110387 | Removal of Reflective Barrier Markers | EA | \$1.25 |
| 110388 | Traffic Barrier W Beam for Maintenance of Traffic | LF | \$62.50 |
| 110389 | Wooden Barricade for Pedestrian Control | LF | \$40.00 |
| 110390 | Traffic Barrier W Beam Replacement for Maintenance of Traffic | LF | \$50.00 |
| 110391 | Reset Traffic Barrier W Beam for Maintenance of Traffic | LF | \$37.50 |
| 110392 | Type I Barricade for Maintenance of Traffic - 6' Length | EA | \$250.00 |
| 110393 | Type II Barricade for Maintenance of Traffic - 6' Length | EA | \$265.00 |
| 110394 | Type III Barricade for Maintenance of Traffic - 6' Length | EA | \$280.00 |
| 110395 | Replace Type III Barricade for Maintenance of Traffic | EA | \$275.00 |
| 110400 | Flagger | HR | \$15.65 |
| 110401 | Temporary Crash Cushion Sand Filled Plastic Barrels for Maintenance of Traffic | BBL | \$350.00 |
| 110402 | Replace Temporary Crash Cushion Sand Filled Plastic Barrels for Maintenance of Traffic | BBL | \$331.25 |
| 110403 | Vertical Panels | EA | \$61.25 |
| 110404 | Warning Lights | EA | \$86.25 |
| 110405 | Remove & Reset Temporary Crash Cushion Sand Filled Plastic Barrels for Maintenance of Traf | BBL | \$116.25 |
| 110406 | Relocate Wood Sign Supports | EA | \$31.25 |
| 110407 | Sign Modifications to Overhead Sign Structures | SF | \$12.50 |
| 110408 | Relocate Sign | SF | \$31.25 |
| 110409 | Remove Sign | SF | \$3.75 |

HOWARD COUNTY - DEPARTMENT OF PLANNING AND ZONING
APPROVED UNIT PRICES AND ITEM CODES
 (County Council Resolution # -2015)
 Effective Date: 7/1/2015

| ITEM CODE | DESCRIPTION | UNIT | UNIT COST |
|------------------|--|------|-------------|
| 110410 | Remove and Relocate Existing Signs | SF | \$13.75 |
| 110411 | Install or Remove Shield | EA | \$30.00 |
| 110412 | Cover Sign | SF | \$2.50 |
| 110413 | Relocate Sign Luminaires | EA | \$31.25 |
| 110414 | Remove and Salvage Existing Sign | EA | \$125.00 |
| 110415 | Temporary Orange Construction Fence | LF | \$2.00 |
| 110416 | Remove & Reset Temporary Orange Construction Fence | LF | \$2.00 |
| 110417 | Temporary Crash Cushion Telescoping Attenuator | EA | \$17,500.00 |
| 110418 | Remove and Reset Temporary Crash Cushion Telescoping Attenuator | EA | \$1,875.00 |
| 110419 | Temporary Crash Cushion Telescoping Attenuator Spare Parts Package | EA | \$8,750.00 |
| 110420 | Water Filled Barrier for Maintenance of Traffic | LF | \$10.00 |
| 110421 | Replacement Sections for Movable Type Concrete Barrier | EA | \$825.00 |
| 110422 | Drums for Maintenance of Traffic | EA | \$62.50 |
| 110423 | Replacement of Drums for Maintenance of Traffic | EA | \$77.50 |
| 110424 | Temporary Movable Type Concrete Traffic Barrier | LF | \$16.50 |
| 110425 | Portable Variable Message Sign | UD | \$135.00 |
| 110426 | Protection Vehicle w/Truck Mounted Attenuator, Variable Message Sign & Intrusion Alarm | UD | \$750.00 |
| 110427 | Truck Mounted Attenuator | UD | \$225.00 |
| 110440 | Temporary Type E Traffic Barrier End Treatment 3 Bays, Any Width | EA | \$5,200.00 |
| 110441 | Temporary Type E Traffic Barrier End Treatment 4 Bays, Any Width | EA | \$5,800.00 |
| 110442 | Temporary Type E Traffic Barrier End Treatment 6 Bays, Any Width | EA | \$16,000.00 |
| 110443 | Temporary Type E Traffic Barrier End Treatment 8 Bays, Any Width | EA | \$20,000.00 |
| 110444 | Temporary Type E Traffic Barrier End Treatment 9 Bays, Any Width | EA | \$25,000.00 |
| 110445 | Remove & Reset Temporary Type E Traffic Barrier End Treatment, Any Bays, Any Width | EA | \$1,500.00 |
| 110446 | Temporary Type E Traffic Barrier End Treatment 12 Bays, Up To 3 Feet Wide | EA | \$20,000.00 |
| 110447 | Temporary Type J Traffic Barrier End Treatment 4 Cylinders | EA | \$12,000.00 |
| 110448 | Temporary Type J Traffic Barrier End Treatment 9 Cylinders | EA | \$16,000.00 |
| 110449 | Precast Temporary 32 inch F Shape Concrete Traffic Barrier Transition Left Side Approach | EA | \$8,000.00 |
| 110450 | Precast Temporary 32 inch F Shape Concrete Traffic Barrier | LF | \$20.00 |
| EARTHWORK | | | |
| 201000 | Trim Existing Ditches | LF | \$7.00 |
| 201001 | Class 1 Excavation | CY | \$7.00 |
| 201002 | Class 1-A Excavation | CY | \$12.50 |
| 201003 | Class 2 Excavation | CY | \$12.50 |
| 201004 | Class 3 Excavation | CY | \$15.00 |
| 201005 | Class 5 Excavation | CY | \$15.00 |
| 201006 | Geosynthetic Stabilized Subgrade Using Graded Aggregate Base | CY | \$30.00 |
| 201007 | Unclassified Excavation | CY | \$7.00 |
| 201008 | Disposal of Petroleum Contaminated material | CY | \$70.00 |
| 201010 | Select Borrow | CY | \$20.75 |
| 201011 | Capping Borrow | CY | \$28.75 |
| 201012 | Modified Borrow | CY | \$11.25 |
| 201013 | Common Borrow | CY | \$8.75 |
| 201014 | Tamped Fill | CY | \$30.00 |
| 201020 | Test Pit Excavation | CY | \$75.00 |
| 201030 | Settlement Plates (ea) | DY | \$5.00 |
| 201040 | Dredging | CY | \$30.00 |

HOWARD COUNTY - DEPARTMENT OF PLANNING AND ZONING
APPROVED UNIT PRICES AND ITEM CODES
(County Council Resolution # -2015)
Effective Date: 7/1/2015

| ITEM CODE | DESCRIPTION | UNIT | UNIT COST |
|--|--|------|-----------|
| PAVEMENT, STORM DRAIN & UTILITY REMOVAL | | | |
| 210000 | Removal of Existing Curb (Any Type) | LF | \$5.00 |
| 210001 | Removal of Existing Combination Curb & Gutter | LF | \$5.00 |
| 210002 | Remove Existing Asphalt Curb | LF | \$1.25 |
| 210003 | Sawcut - 2" Deep | LF | \$2.50 |
| 210004 | Sawcut - Full Depth | LF | \$5.00 |
| 210005 | Remove Existing Bituminous Pavement | SY | \$7.50 |
| 210006 | Remove Existing Sidewalk | SY | \$4.00 |
| 210007 | Removal of Paved Ditches | SY | \$4.00 |
| 210008 | Remove Existing Concrete Pavement | SY | \$10.00 |
| 210009 | Remove Existing Masonry | CY | \$98.00 |
| 210010 | Remove Existing Concrete Barrier (Any Type) | LF | \$13.75 |
| 210011 | Remove Existing Manhole | EA | \$925.00 |
| 210100 | Scarify Existing Asphalt Pavement | SY | \$5.50 |
| 210200 | Stabilized Construction Entrance | TON | \$28.75 |
| 210201 | Rehabilitate Stabilized Construction Entrance | TON | \$21.25 |
| 210202 | Class 3 Excavation for Incidental Construction | CY | \$11.25 |
| 210300 | Trench Backfill Using Select Borrow | CY | \$31.25 |
| 210301 | Trench Backfill | CY | \$10.00 |
| 210302 | Select Backfill Using No. 57 Aggregate | CY | \$28.75 |
| 210303 | Select Backfill Using Graded Aggregate Subbase | CY | \$28.75 |
| 210304 | Flowable Backfill for Utility Cuts | CY | \$65.00 |
| 210305 | Select Backfill Using Crusher Run Aggregate CR-6 | CY | \$28.75 |
| 210400 | Removal of Existing Pipe | LF | \$20.50 |
| 210401 | Re-laid Old Pipe Culverts (Any Size) | LF | \$33.75 |
| 210500 | Mix 1 Concrete Miscellaneous Structures | CY | \$390.00 |
| 210501 | Mix 2 Concrete Miscellaneous Structures | CY | \$485.00 |
| 210502 | Brick Masonry Miscellaneous Structure | CY | \$500.00 |
| 210503 | Mix 3 Concrete Miscellaneous Structures | CY | \$845.00 |
| 210504 | Mix 6 Concrete Miscellaneous Structures | CY | \$235.00 |
| 210505 | Clean Existing Pipe - Any Size | LF | \$10.00 |
| 210506 | Clean Existing Inlets | EA | \$260.00 |
| 210507 | Clean Existing Underdrain Outlets | EA | \$100.00 |
| 210508 | Remove Existing Catch Basin, Manhole, Headwall | EA | \$687.50 |
| 210509 | Abandon Existing Catch Basin or Manhole | EA | \$166.25 |
| STORM DRAIN CONSTRUCTION | | | |
| 302000 | 12" RCCP Class III | LF | \$25.00 |
| 302001 | 15" RCCP Class III | LF | \$30.00 |
| 302002 | 18" RCCP Class III | LF | \$32.00 |
| 302003 | 21" RCCP Class III | LF | \$38.00 |
| 302004 | 24" RCCP Class III | LF | \$44.00 |
| 302005 | 27" RCCP Class III | LF | \$49.00 |
| 302006 | 30" RCCP Class III | LF | \$65.00 |
| 302007 | 33" RCCP Class III | LF | \$74.00 |
| 302008 | 36" RCCP Class III | LF | \$84.00 |
| 302009 | 42" RCCP Class III | LF | \$99.00 |
| 302010 | 48" RCCP Class III | LF | \$118.00 |
| 302011 | 54" RCCP Class III | LF | \$132.00 |
| 302012 | 60" RCCP Class III | LF | \$176.00 |
| 302013 | 66" RCCP Class III | LF | \$188.00 |
| 302014 | 72" RCCP Class III | LF | \$226.00 |
| 302015 | 78" RCCP Class III | LF | \$264.00 |
| 302016 | 84" RCCP Class III | LF | \$318.00 |
| 302017 | 90" RCCP Class III | LF | \$357.00 |
| 302018 | 96" RCCP Class III | LF | \$402.00 |

HOWARD COUNTY - DEPARTMENT OF PLANNING AND ZONING
APPROVED UNIT PRICES AND ITEM CODES
(County Council Resolution # -2015)
Effective Date: 7/1/2015

| ITEM CODE | DESCRIPTION | UNIT | UNIT COST |
|-----------|----------------------|------|-----------|
| 302100 | 12" RCCP Class IV | LF | \$27.00 |
| 302101 | 15" RCCP Class IV | LF | \$32.00 |
| 302102 | 18" RCCP Class IV | LF | \$36.00 |
| 302103 | 21" RCCP Class IV | LF | \$43.00 |
| 302104 | 24" RCCP Class IV | LF | \$48.00 |
| 302105 | 27" RCCP Class IV | LF | \$55.00 |
| 302106 | 30" RCCP Class IV | LF | \$72.00 |
| 302107 | 33" RCCP Class IV | LF | \$83.00 |
| 302108 | 36" RCCP Class IV | LF | \$95.00 |
| 302109 | 42" RCCP Class IV | LF | \$103.00 |
| 302110 | 48" RCCP Class IV | LF | \$122.00 |
| 302111 | 54" RCCP Class IV | LF | \$148.00 |
| 302112 | 60" RCCP Class IV | LF | \$180.00 |
| 302113 | 66" RCCP Class IV | LF | \$209.00 |
| 302114 | 72" RCCP Class IV | LF | \$237.00 |
| 302115 | 78" RCCP Class IV | LF | \$290.00 |
| 302116 | 84" RCCP Class IV | LF | \$348.00 |
| 302117 | 90" RCCP Class IV | LF | \$464.00 |
| 302118 | 96" RCCP Class IV | LF | \$521.00 |
| 302300 | 12" RCCP Class V | LF | \$28.00 |
| 302301 | 15" RCCP Class V | LF | \$34.00 |
| 302302 | 18" RCCP Class V | LF | \$38.00 |
| 302303 | 21" RCCP Class V | LF | \$44.00 |
| 302304 | 24" RCCP Class V | LF | \$52.00 |
| 302305 | 27" RCCP Class V | LF | \$56.00 |
| 302306 | 30" RCCP Class V | LF | \$75.00 |
| 302307 | 33" RCCP Class V | LF | \$86.00 |
| 302308 | 36" RCCP Class V | LF | \$96.00 |
| 302309 | 42" RCCP Class V | LF | \$108.00 |
| 302310 | 48" RCCP Class V | LF | \$129.00 |
| 302311 | 54" RCCP Class V | LF | \$155.00 |
| 302312 | 60" RCCP Class V | LF | \$188.00 |
| 302313 | 66" RCCP Class V | LF | \$264.00 |
| 302314 | 72" RCCP Class V | LF | \$323.00 |
| 302315 | 78" RCCP Class V | LF | \$393.00 |
| 302316 | 84" RCCP Class V | LF | \$464.00 |
| 302317 | 90" RCCP Class V | LF | \$564.00 |
| 302318 | 96" RCCP Class V | LF | \$577.00 |
| 303000 | 6" BCCMP - 16 gauge | LF | \$17.00 |
| 303001 | 12" BCCMP - 16 gauge | LF | \$34.00 |
| 303002 | 15" BCCMP - 16 gauge | LF | \$40.00 |
| 303003 | 18" BCCMP - 16 gauge | LF | \$47.00 |
| 303004 | 21" BCCMP - 16 gauge | LF | \$56.00 |
| 303005 | 24" BCCMP - 16 gauge | LF | \$65.00 |
| 303006 | 27" BCCMP - 16 gauge | LF | \$75.00 |
| 303007 | 30" BCCMP - 16 gauge | LF | \$80.00 |
| 303100 | 6" BCCMP - 14 gauge | LF | \$19.00 |
| 303101 | 12" BCCMP - 14 gauge | LF | \$22.00 |
| 303102 | 15" BCCMP - 14 gauge | LF | \$24.00 |
| 303103 | 18" BCCMP - 14 gauge | LF | \$54.00 |
| 303104 | 21" BCCMP - 14 gauge | LF | \$64.00 |
| 303105 | 24" BCCMP - 14 gauge | LF | \$73.00 |
| 303106 | 27" BCCMP - 14 gauge | LF | \$84.00 |
| 303107 | 30" BCCMP - 14 gauge | LF | \$90.00 |
| 303108 | 36" BCCMP - 14 gauge | LF | \$110.00 |
| 303109 | 42" BCCMP - 14 gauge | LF | \$129.00 |
| 303110 | 48" BCCMP - 14 gauge | LF | \$146.00 |
| 303111 | 54" BCCMP - 14 gauge | LF | \$164.00 |
| 303112 | 60" BCCMP - 14 gauge | LF | \$184.00 |

HOWARD COUNTY - DEPARTMENT OF PLANNING AND ZONING
APPROVED UNIT PRICES AND ITEM CODES
(County Council Resolution # -2015)
Effective Date: 7/1/2015

| ITEM CODE | DESCRIPTION | UNIT | UNIT COST |
|-----------|---|------|-----------|
| 304000 | 8" CMP Galvanized - 16 gauge | LF | \$12.00 |
| 304001 | 10" CMP Galvanized - 16 gauge | LF | \$13.00 |
| 304002 | 12" CMP Galvanized - 16 gauge | LF | \$17.00 |
| 304003 | 15" CMP Galvanized - 16 gauge | LF | \$20.00 |
| 304004 | 18" CMP Galvanized - 16 gauge | LF | \$25.00 |
| 304005 | 21" CMP Galvanized - 16 gauge | LF | \$27.00 |
| 304006 | 24" CMP Galvanized - 16 gauge | LF | \$45.00 |
| 304100 | 24" CMP Galvanized - 14 gauge | LF | \$32.00 |
| 304101 | 27" CMP Galvanized - 14 gauge | LF | \$38.00 |
| 304102 | 30" CMP Galvanized - 14 gauge | LF | \$45.00 |
| 304103 | 36" CMP Galvanized - 14 gauge | LF | \$75.00 |
| 304104 | 42" CMP Galvanized - 14 gauge | LF | \$90.00 |
| 304200 | 36" CMP Galvanized - 12 gauge | LF | \$72.00 |
| 304201 | 48" CMP Galvanized - 12 gauge | LF | \$101.00 |
| 304202 | 54" CMP Galvanized - 12 gauge | LF | \$110.00 |
| 304300 | 60" CMP Galvanized - 10 gauge | LF | \$155.00 |
| 304301 | 66" CMP Galvanized - 10 gauge | LF | \$164.00 |
| 304500 | 72" CMP Galvanized - 8 gauge | LF | \$172.00 |
| 305000 | 8" CMP Aluminized - 16 gauge | LF | \$14.00 |
| 305001 | 10" CMP Aluminized - 16 gauge | LF | \$18.00 |
| 305002 | 12" CMP Aluminized - 16 gauge | LF | \$22.00 |
| 305003 | 15" CMP Aluminized - 16 gauge | LF | \$25.00 |
| 305004 | 18" CMP Aluminized - 16 gauge | LF | \$30.00 |
| 305005 | 21" CMP Aluminized - 16 gauge | LF | \$33.00 |
| 305100 | 12" CMP Aluminized - 14 gauge | LF | \$28.00 |
| 305101 | 15" CMP Aluminized - 14 gauge | LF | \$30.00 |
| 305102 | 18" CMP Aluminized - 14 gauge | LF | \$35.00 |
| 305103 | 21" CMP Aluminized - 14 gauge | LF | \$38.00 |
| 305104 | 24" CMP Aluminized - 14 gauge | LF | \$40.00 |
| 305105 | 27" CMP Aluminized - 14 gauge | LF | \$45.00 |
| 305106 | 30" CMP Aluminized - 14 gauge | LF | \$55.00 |
| 305200 | 36" CMP Aluminized - 12 gauge | LF | \$63.00 |
| 305201 | 48" CMP Aluminized - 12 gauge | LF | \$93.00 |
| 305202 | 54" CMP Aluminized - 12 gauge | LF | \$108.00 |
| 305300 | 60" CMP Aluminized - 10 gauge | LF | \$125.00 |
| 305301 | 66" CMP Aluminized - 10 gauge | LF | \$140.00 |
| 305600 | 72" CMP Aluminized - 8 gauge | LF | \$160.00 |
| 306000 | 12" HDPE, Smooth Inside, Plastic Rigid Pipe | LF | \$30.00 |
| 306001 | 15" HDPE, Smooth Inside, Plastic Rigid Pipe | LF | \$35.00 |
| 306002 | 18" HDPE, Smooth Inside, Plastic Rigid Pipe | LF | \$40.00 |
| 306003 | 24" HDPE, Smooth Inside, Plastic Rigid Pipe | LF | \$45.00 |
| 306004 | 30" HDPE, Smooth Inside, Plastic Rigid Pipe | LF | \$65.00 |
| 306005 | 36" HDPE, Smooth Inside, Plastic Rigid Pipe | LF | \$85.00 |
| 306006 | 39" HDPE, Smooth Inside, Plastic Rigid Pipe | LF | \$105.00 |
| 307000 | 4" PVC Schedule 40 Rigid Pipe | LF | \$12.00 |
| 307001 | 6" PVC Schedule 40 Rigid Pipe | LF | \$13.00 |
| 307002 | 8" PVC Schedule 40 Rigid Pipe | LF | \$16.00 |
| 307003 | 10" PVC Schedule 40 Rigid Pipe | LF | \$25.00 |
| 307004 | 12" PVC Schedule 40 Rigid Pipe | LF | \$30.00 |

HOWARD COUNTY - DEPARTMENT OF PLANNING AND ZONING
APPROVED UNIT PRICES AND ITEM CODES
(County Council Resolution # -2015)
Effective Date: 7/1/2015

| ITEM CODE | DESCRIPTION | UNIT | UNIT COST |
|-----------|--|------|-----------|
| 307100 | Perforated 4" PVC Schedule 40 Rigid Pipe | LF | \$15.00 |
| 307101 | Perforated 6" PVC Schedule 40 Rigid Pipe | LF | \$16.00 |
| 307102 | Perforated 8" PVC Schedule 40 Rigid Pipe | LF | \$19.00 |
| 307103 | Perforated 10" PVC Schedule 40 Rigid Pipe | LF | \$28.00 |
| 307104 | Perforated 12" PVC Schedule 40 Rigid Pipe | LF | \$33.00 |
| 308000 | 14"x23" Horiz. Ellipt. RCCP Class HE III | LF | \$52.00 |
| 308001 | 19"x30" Horiz. Ellipt. RCCP Class HE III | LF | \$63.00 |
| 308002 | 22"x34" Horiz. Ellipt. RCCP Class HE III | LF | \$72.00 |
| 308003 | 24"x38" Horiz. Ellipt. RCCP Class HE III | LF | \$82.00 |
| 308004 | 27"x42" Horiz. Ellipt. RCCP Class HE III | LF | \$99.00 |
| 308005 | 29"x45" Horiz. Ellipt. RCCP Class HE III | LF | \$118.00 |
| 308006 | 32"x49" Horiz. Ellipt. RCCP Class HE III | LF | \$122.00 |
| 308007 | 34"x53" Horiz. Ellipt. RCCP Class HE III | LF | \$131.00 |
| 308008 | 38"x60" Horiz. Ellipt. RCCP Class HE III | LF | \$152.00 |
| 308009 | 43"x68" Horiz. Ellipt. RCCP Class HE III | LF | \$183.00 |
| 308010 | 48"x76" Horiz. Ellipt. RCCP Class HE III | LF | \$224.00 |
| 308011 | 53"x85" Horiz. Ellipt. RCCP Class HE III | LF | \$236.00 |
| 308012 | 58"x91" Horiz. Ellipt. RCCP Class HE III | LF | \$311.00 |
| 308013 | 63"x98" Horiz. Ellipt. RCCP Class HE III | LF | \$355.00 |
| 308014 | 68"x106" Horiz. Ellipt. RCCP Class HE III | LF | \$407.00 |
| 308015 | 72"x113" Horiz. Ellipt. RCCP Class HE III | LF | \$502.00 |
| 308016 | 77"x121" Horiz. Ellipt. RCCP Class HE III | LF | \$561.00 |
| 308017 | 82"x128" Horiz. Ellipt. RCCP Class HE III | LF | \$613.00 |
| 308018 | 87"x136" Horiz. Ellipt. RCCP Class HE III | LF | \$673.00 |
| 308100 | 14"x23" Horiz. Ellipt. RCCP Class HE IV | LF | \$57.00 |
| 308101 | 19"x30" Horiz. Ellipt. RCCP Class HE IV | LF | \$67.00 |
| 308102 | 22"x34" Horiz. Ellipt. RCCP Class HE IV | LF | \$77.00 |
| 308103 | 24"x38" Horiz. Ellipt. RCCP Class HE IV | LF | \$87.00 |
| 308104 | 27"x42" Horiz. Ellipt. RCCP Class HE IV | LF | \$105.00 |
| 308105 | 29"x45" Horiz. Ellipt. RCCP Class HE IV | LF | \$131.00 |
| 308106 | 32"x49" Horiz. Ellipt. RCCP Class HE IV | LF | \$134.00 |
| 308107 | 34"x53" Horiz. Ellipt. RCCP Class HE IV | LF | \$143.00 |
| 308108 | 38"x60" Horiz. Ellipt. RCCP Class HE IV | LF | \$162.00 |
| 308109 | 43"x68" Horiz. Ellipt. RCCP Class HE IV | LF | \$196.00 |
| 308110 | 48"x76" Horiz. Ellipt. RCCP Class HE IV | LF | \$241.00 |
| 308111 | 53"x85" Horiz. Ellipt. RCCP Class HE IV | LF | \$308.00 |
| 308112 | 58"x91" Horiz. Ellipt. RCCP Class HE IV | LF | \$362.00 |
| 308113 | 63"x98" Horiz. Ellipt. RCCP Class HE IV | LF | \$418.00 |
| 308114 | 68"x106" Horiz. Ellipt. RCCP Class HE IV | LF | \$477.00 |
| 308115 | 72"x113" Horiz. Ellipt. RCCP Class HE IV | LF | \$584.00 |
| 308116 | 77"x121" Horiz. Ellipt. RCCP Class HE IV | LF | \$653.00 |
| 308117 | 82"x128" Horiz. Ellipt. RCCP Class HE IV | LF | \$713.00 |
| 308118 | 87"x136" Horiz. Ellipt. RCCP Class HE IV | LF | \$782.00 |
| 309000 | 15" RCCP, ASTM C-361, Rubber Gasket Pipe, Class A-25 | LF | \$55.00 |
| 309001 | 18" RCCP, ASTM C-361, Rubber Gasket Pipe, Class A-25 | LF | \$60.00 |
| 309002 | 21" RCCP, ASTM C-361, Rubber Gasket Pipe, Class A-25 | LF | \$65.00 |
| 309003 | 24" RCCP, ASTM C-361, Rubber Gasket Pipe, Class A-25 | LF | \$70.00 |
| 309004 | 27" RCCP, ASTM C-361, Rubber Gasket Pipe, Class A-25 | LF | \$75.00 |
| 309005 | 30" RCCP, ASTM C-361, Rubber Gasket Pipe, Class A-25 | LF | \$85.00 |
| 309006 | 33" RCCP, ASTM C-361, Rubber Gasket Pipe, Class A-25 | LF | \$90.00 |
| 309007 | 36" RCCP, ASTM C-361, Rubber Gasket Pipe, Class A-25 | LF | \$100.00 |
| 309008 | 42" RCCP, ASTM C-361, Rubber Gasket Pipe, Class A-25 | LF | \$130.00 |
| 309009 | 48" RCCP, ASTM C-361, Rubber Gasket Pipe, Class A-25 | LF | \$150.00 |
| 309010 | 54" RCCP, ASTM C-361, Rubber Gasket Pipe, Class A-25 | LF | \$175.00 |
| 309011 | 60" RCCP, ASTM C-361, Rubber Gasket Pipe, Class A-25 | LF | \$245.00 |
| 309012 | 66" RCCP, ASTM C-361, Rubber Gasket Pipe, Class A-25 | LF | \$265.00 |
| 309013 | 72" RCCP, ASTM C-361, Rubber Gasket Pipe, Class A-25 | LF | \$295.00 |

HOWARD COUNTY - DEPARTMENT OF PLANNING AND ZONING
APPROVED UNIT PRICES AND ITEM CODES
(County Council Resolution # -2015)
Effective Date: 7/1/2015

| ITEM CODE | DESCRIPTION | UNIT | UNIT COST |
|-----------|--|------|-----------|
| 309100 | 15" RCCP, ASTM C-361, Rubber Gasket Pipe, Class B-25 | LF | \$60.00 |
| 309101 | 18" RCCP, ASTM C-361, Rubber Gasket Pipe, Class B-25 | LF | \$65.00 |
| 309102 | 21" RCCP, ASTM C-361, Rubber Gasket Pipe, Class B-25 | LF | \$70.00 |
| 309103 | 24" RCCP, ASTM C-361, Rubber Gasket Pipe, Class B-25 | LF | \$75.00 |
| 309104 | 27" RCCP, ASTM C-361, Rubber Gasket Pipe, Class B-25 | LF | \$80.00 |
| 309105 | 30" RCCP, ASTM C-361, Rubber Gasket Pipe, Class B-25 | LF | \$85.00 |
| 309106 | 33" RCCP, ASTM C-361, Rubber Gasket Pipe, Class B-25 | LF | \$90.00 |
| 309107 | 36" RCCP, ASTM C-361, Rubber Gasket Pipe, Class B-25 | LF | \$105.00 |
| 309108 | 42" RCCP, ASTM C-361, Rubber Gasket Pipe, Class B-25 | LF | \$130.00 |
| 309109 | 48" RCCP, ASTM C-361, Rubber Gasket Pipe, Class B-25 | LF | \$155.00 |
| 309110 | 54" RCCP, ASTM C-361, Rubber Gasket Pipe, Class B-25 | LF | \$175.00 |
| 309111 | 60" RCCP, ASTM C-361, Rubber Gasket Pipe, Class B-25 | LF | \$250.00 |
| 309112 | 66" RCCP, ASTM C-361, Rubber Gasket Pipe, Class B-25 | LF | \$275.00 |
| 309113 | 72" RCCP, ASTM C-361, Rubber Gasket Pipe, Class B-25 | LF | \$300.00 |
| 309200 | 15" RCCP, ASTM C-361, Rubber Gasket Pipe, Class C-25 | LF | \$60.00 |
| 309201 | 18" RCCP, ASTM C-361, Rubber Gasket Pipe, Class C-25 | LF | \$65.00 |
| 309202 | 21" RCCP, ASTM C-361, Rubber Gasket Pipe, Class C-25 | LF | \$70.00 |
| 309203 | 24" RCCP, ASTM C-361, Rubber Gasket Pipe, Class C-25 | LF | \$75.00 |
| 309204 | 27" RCCP, ASTM C-361, Rubber Gasket Pipe, Class C-25 | LF | \$85.00 |
| 309205 | 30" RCCP, ASTM C-361, Rubber Gasket Pipe, Class C-25 | LF | \$90.00 |
| 309206 | 33" RCCP, ASTM C-361, Rubber Gasket Pipe, Class C-25 | LF | \$95.00 |
| 309207 | 36" RCCP, ASTM C-361, Rubber Gasket Pipe, Class C-25 | LF | \$105.00 |
| 309208 | 42" RCCP, ASTM C-361, Rubber Gasket Pipe, Class C-25 | LF | \$140.00 |
| 309209 | 48" RCCP, ASTM C-361, Rubber Gasket Pipe, Class C-25 | LF | \$170.00 |
| 309210 | 54" RCCP, ASTM C-361, Rubber Gasket Pipe, Class C-25 | LF | \$180.00 |
| 309211 | 60" RCCP, ASTM C-361, Rubber Gasket Pipe, Class C-25 | LF | \$265.00 |
| 309212 | 66" RCCP, ASTM C-361, Rubber Gasket Pipe, Class C-25 | LF | \$285.00 |
| 309213 | 72" RCCP, ASTM C-361, Rubber Gasket Pipe, Class C-25 | LF | \$325.00 |
| 309300 | 15" RCCP, ASTM C-361, Rubber Gasket Pipe, Class D-25 | LF | \$60.00 |
| 309301 | 18" RCCP, ASTM C-361, Rubber Gasket Pipe, Class D-25 | LF | \$65.00 |
| 309302 | 21" RCCP, ASTM C-361, Rubber Gasket Pipe, Class D-25 | LF | \$70.00 |
| 309303 | 24" RCCP, ASTM C-361, Rubber Gasket Pipe, Class D-25 | LF | \$80.00 |
| 309304 | 27" RCCP, ASTM C-361, Rubber Gasket Pipe, Class D-25 | LF | \$85.00 |
| 309305 | 30" RCCP, ASTM C-361, Rubber Gasket Pipe, Class D-25 | LF | \$95.00 |
| 309306 | 33" RCCP, ASTM C-361, Rubber Gasket Pipe, Class D-25 | LF | \$100.00 |
| 309307 | 36" RCCP, ASTM C-361, Rubber Gasket Pipe, Class D-25 | LF | \$110.00 |
| 309308 | 42" RCCP, ASTM C-361, Rubber Gasket Pipe, Class D-25 | LF | \$145.00 |
| 309309 | 48" RCCP, ASTM C-361, Rubber Gasket Pipe, Class D-25 | LF | \$175.00 |
| 309310 | 54" RCCP, ASTM C-361, Rubber Gasket Pipe, Class D-25 | LF | \$195.00 |
| 309311 | 60" RCCP, ASTM C-361, Rubber Gasket Pipe, Class D-25 | LF | \$270.00 |
| 309312 | 66" RCCP, ASTM C-361, Rubber Gasket Pipe, Class D-25 | LF | \$300.00 |
| 309313 | 72" RCCP, ASTM C-361, Rubber Gasket Pipe, Class D-25 | LF | \$335.00 |
| 310000 | 17" x 13" CSP Pipe Arch - 16 gauge | LF | \$28.00 |
| 310001 | 21" x 15" CSP Pipe Arch - 16 gauge | LF | \$34.00 |
| 310002 | 24" x 18" CSP Pipe Arch - 16 gauge | LF | \$42.00 |
| 310100 | 28" x 20" CSP Pipe Arch - 14 gauge | LF | \$48.00 |
| 310101 | 35" x 24" CSP Pipe Arch - 14 gauge | LF | \$60.00 |
| 310200 | 42" x 29" CSP Pipe Arch - 12 gauge | LF | \$103.00 |
| 310201 | 49" x 33" CSP Pipe Arch - 12 gauge | LF | \$112.00 |
| 310300 | 57" x 38" CSP Pipe Arch - 10 gauge | LF | \$133.00 |
| 311000 | 17" x 13" CAP Pipe Arch - 16 gauge | LF | \$28.00 |
| 311001 | 21" x 15" CAP Pipe Arch - 16 gauge | LF | \$34.00 |
| 311002 | 24" x 18" CAP Pipe Arch - 16 gauge | LF | \$42.00 |
| 311100 | 28" x 20" CAP Pipe Arch - 14 gauge | LF | \$48.00 |
| 311101 | 35" x 24" CAP Pipe Arch - 14 gauge | LF | \$60.00 |

HOWARD COUNTY - DEPARTMENT OF PLANNING AND ZONING
APPROVED UNIT PRICES AND ITEM CODES
(County Council Resolution # -2015)
Effective Date: 7/1/2015

| ITEM CODE | DESCRIPTION | UNIT | UNIT COST |
|-----------|--|------|------------|
| 311200 | 42" x 29" CAP Pipe Arch - 12 gauge | LF | \$103.00 |
| 311201 | 49" x 33" CAP Pipe Arch - 12 gauge | LF | \$112.00 |
| 311202 | 57" x 38" CAP Pipe Arch - 12 gauge | LF | \$133.00 |
| 312000 | 17" x 13" CM Pipe Arch - Coated & Paved - 16 gauge | LF | \$38.00 |
| 312001 | 21" x 15" CM Pipe Arch - Coated & Paved - 16 gauge | LF | \$46.00 |
| 312100 | 28" x 20" CM Pipe Arch - Coated & Paved - 14 gauge | LF | \$64.00 |
| 312101 | 35" x 24" CM Pipe Arch - Coated & Paved - 14 gauge | LF | \$79.00 |
| 312200 | 42" x 29" CM Pipe Arch - Coated & Paved - 12 gauge | LF | \$127.00 |
| 312201 | 49" x 33" CM Pipe Arch - Coated & Paved - 12 gauge | LF | \$145.00 |
| 312202 | 57" x 38" CM Pipe Arch - Coated & Paved - 12 gauge | LF | \$169.00 |
| 313000 | 17" x 13" ALCM Pipe Arch - Coated & Paved - 16 gauge | LF | \$38.00 |
| 313001 | 21" x 15" ALCM Pipe Arch - Coated & Paved - 16 gauge | LF | \$46.00 |
| 313100 | 28" x 20" ALCM Pipe Arch - Coated & Paved - 14 gauge | LF | \$64.00 |
| 313101 | 35" x 24" ALCM Pipe Arch - Coated & Paved - 14 gauge | LF | \$79.00 |
| 313200 | 42" x 29" ALCM Pipe Arch - Coated & Paved - 12 gauge | LF | \$127.00 |
| 313201 | 49" x 33" ALCM Pipe Arch - Coated & Paved - 12 gauge | LF | \$145.00 |
| 313202 | 57" x 38" ALCM Pipe Arch - Coated & Paved - 12 gauge | LF | \$169.00 |
| 314000 | 8" BCMP Galvanized - 16 gauge | LF | \$15.00 |
| 314001 | 10" BCMP Galvanized - 16 gauge | LF | \$19.00 |
| 314002 | 12" BCMP Galvanized - 16 gauge | LF | \$24.00 |
| 314003 | 15" BCMP Galvanized - 16 gauge | LF | \$29.00 |
| 314004 | 18" BCMP Galvanized - 16 gauge | LF | \$34.00 |
| 314100 | 24" BCMP Galvanized - 14 gauge | LF | \$53.00 |
| 314101 | 30" BCMP Galvanized - 14 gauge | LF | \$64.00 |
| 214200 | 36" BCMP Galvanized - 12 gauge | LF | \$100.00 |
| 214201 | 48" BCMP Galvanized - 12 gauge | LF | \$130.00 |
| 314300 | 60" BCMP Galvanized - 10 gauge | LF | \$193.00 |
| 314400 | 72" BCMP Galvanized - 8 gauge | LF | \$302.00 |
| 315000 | 8" BCMP Aluminized - 16 gauge | LF | \$15.00 |
| 315001 | 10" BCMP Aluminized - 16 gauge | LF | \$19.00 |
| 315002 | 12" BCMP Aluminized - 16 gauge | LF | \$24.00 |
| 315003 | 15" BCMP Aluminized - 16 gauge | LF | \$29.00 |
| 315004 | 18" BCMP Aluminized - 16 gauge | LF | \$34.00 |
| 315100 | 24" BCMP Aluminized - 14 gauge | LF | \$53.00 |
| 315101 | 30" BCMP Aluminized - 14 gauge | LF | \$64.00 |
| 315200 | 36" BCMP Aluminized - 12 gauge | LF | \$100.00 |
| 315201 | 48" BCMP Aluminized - 12 gauge | LF | \$130.00 |
| 315300 | 60" BCMP Aluminized - 10 gauge | LF | \$193.00 |
| 315400 | 72" BCMP Aluminized - 8 gauge | LF | \$302.00 |
| 320000 | Standard A Headwall - 12" Pipe | EA | \$1,000.00 |
| 320001 | Standard A Headwall - 15" Pipe | EA | \$1,250.00 |
| 320002 | Standard A Headwall - 18" Pipe | EA | \$1,400.00 |
| 320003 | Standard A Headwall - 21" Pipe | EA | \$1,500.00 |
| 320004 | Standard A Headwall - 24" Pipe | EA | \$1,600.00 |
| 320005 | Standard A Headwall - 27" Pipe | EA | \$1,700.00 |
| 320006 | Standard A headwall - 30" Pipe | EA | \$2,400.00 |
| 320007 | Standard A headwall - 33" Pipe | EA | \$3,125.00 |
| 320008 | Standard A Headwall - 36" Pipe | EA | \$2,600.00 |
| 320009 | Standard A Headwall - 42" Pipe | EA | \$3,200.00 |
| 320010 | Standard A Headwall - 48" Pipe | EA | \$4,200.00 |
| 320011 | Standard A Headwall - 54" Pipe | EA | \$5,400.00 |

HOWARD COUNTY - DEPARTMENT OF PLANNING AND ZONING
APPROVED UNIT PRICES AND ITEM CODES
(County Council Resolution # -2015)
Effective Date: 7/1/2015

| ITEM CODE | DESCRIPTION | UNIT | UNIT COST |
|-----------|--------------------------------------|------|------------|
| 320012 | Standard A Headwall - 60" Pipe | EA | \$6,600.00 |
| 320013 | Standard A Headwall - 66" Pipe | EA | \$7,600.00 |
| 320014 | Standard A Headwall - 72" Pipe | EA | \$9,200.00 |
| 321000 | Standard C Endwall - 12" Pipe | EA | \$500.00 |
| 321001 | Standard C Endwall - 15" Pipe | EA | \$700.00 |
| 321002 | Standard C Endwall - 18" Pipe | EA | \$800.00 |
| 321003 | Standard C Endwall - 21" Pipe | EA | \$1,100.00 |
| 321004 | Standard C Endwall - 24" Pipe | EA | \$1,300.00 |
| 321005 | Standard C Endwall - 27" Pipe | EA | \$1,600.00 |
| 321006 | Standard C Endwall - 30" Pipe | EA | \$1,800.00 |
| 321007 | Standard C Endwall - 33" Pipe | EA | \$2,700.00 |
| 321008 | Standard C Endwall - 36" Pipe | EA | \$3,500.00 |
| 321009 | Standard C Endwall - 42" Pipe | EA | \$4,300.00 |
| 321010 | Standard C Endwall - 48" Pipe | EA | \$5,100.00 |
| 321011 | Standard C Endwall - 54" Pipe | EA | \$6,400.00 |
| 321012 | Standard C Endwall - 60" Pipe | EA | \$7,400.00 |
| 322000 | Standard C Headwall - 17" x 13" CMPA | EA | \$500.00 |
| 322001 | Standard C Headwall - 21" x 15" CMPA | EA | \$700.00 |
| 322002 | Standard C Headwall - 24" x 18" CMPA | EA | \$800.00 |
| 322003 | Standard C Headwall - 28" x 20" CMPA | EA | \$900.00 |
| 322004 | Standard C Headwall - 35" x 24" CMPA | EA | \$1,500.00 |
| 322005 | Standard C Headwall - 42" x 29" CMPA | EA | \$1,600.00 |
| 322006 | Standard C Headwall - 49" x 33" CMPA | EA | \$3,600.00 |
| 322007 | Standard C Headwall - 57" x 38" CMPA | EA | \$3,500.00 |
| 322008 | Standard C Headwall - 64" x 43" CMPA | EA | \$4,900.00 |
| 322009 | Standard C Headwall - 71" x 47" CMPA | EA | \$5,000.00 |
| 323000 | Standard E Headwall - 12" Pipe | EA | \$700.00 |
| 323001 | Standard E Headwall - 15" Pipe | EA | \$800.00 |
| 323002 | Standard E Headwall - 18" Pipe | EA | \$1,000.00 |
| 323003 | Standard E Headwall - 21" Pipe | EA | \$1,300.00 |
| 323004 | Standard E Headwall - 24" Pipe | EA | \$1,500.00 |
| 323005 | Standard E Headwall - 27" Pipe | EA | \$1,900.00 |
| 323006 | Standard E Headwall - 30" Pipe | EA | \$2,200.00 |
| 323007 | Standard E Headwall - 33" Pipe | EA | \$3,300.00 |
| 323008 | Standard E Headwall - 36" Pipe | EA | \$4,200.00 |
| 323009 | Standard E Headwall - 42" Pipe | EA | \$5,200.00 |
| 323010 | Standard E Headwall - 48" Pipe | EA | \$6,200.00 |
| 323011 | Standard E Headwall - 54" Pipe | EA | \$7,600.00 |
| 323012 | Standard E Headwall - 60" Pipe | EA | \$8,900.00 |
| 324000 | Standard E Headwall - 13" x 11" CMPA | EA | \$590.00 |
| 324001 | Standard E Headwall - 17" x 13" CMPA | EA | \$600.00 |
| 324002 | Standard E Headwall - 21" x 15" CMPA | EA | \$1,100.00 |
| 324003 | Standard E Headwall - 24" x 18" CMPA | EA | \$1,200.00 |
| 324004 | Standard E Headwall - 28" x 20" CMPA | EA | \$1,300.00 |
| 324005 | Standard E Headwall - 35" x 24" CMPA | EA | \$2,000.00 |
| 324006 | Standard E Headwall - 42" x 29" CMPA | EA | \$2,100.00 |
| 324007 | Standard E Headwall - 49" x 33" CMPA | EA | \$4,700.00 |
| 324008 | Standard E Headwall - 57" x 38" CMPA | EA | \$4,800.00 |
| 324009 | Standard E Headwall - 64" x 43" CMPA | EA | \$6,600.00 |
| 324010 | Standard E Headwall - 71" x 47" CMPA | EA | \$6,700.00 |

HOWARD COUNTY - DEPARTMENT OF PLANNING AND ZONING
APPROVED UNIT PRICES AND ITEM CODES
(County Council Resolution # -2015)
Effective Date: 7/1/2015

| ITEM CODE | DESCRIPTION | UNIT | UNIT COST |
|-----------|---|------|------------|
| 325000 | Standard O Headwall - 18" Pipe | EA | \$800.00 |
| 325001 | Standard O Headwall - 21" Pipe | EA | \$1,000.00 |
| 325002 | Standard O Headwall - 24" Pipe | EA | \$1,200.00 |
| 325003 | Standard O Headwall - 27" Pipe | EA | \$1,300.00 |
| 325004 | Standard O Headwall - 30" Pipe | EA | \$1,500.00 |
| 325005 | Standard O Headwall - 36" Pipe | EA | \$2,200.00 |
| 325006 | Standard O Headwall - 42" Pipe | EA | \$2,800.00 |
| 325007 | Standard O Headwall - 48" Pipe | EA | \$3,500.00 |
| 325008 | Standard O Headwall - 54" Pipe | EA | \$4,100.00 |
| 325009 | Standard O Headwall - 60" Pipe | EA | \$5,000.00 |
| 325010 | Standard O Headwall - 66" Pipe | EA | \$5,800.00 |
| 325011 | Standard O Headwall - 72" Pipe | EA | \$6,800.00 |
| | | | |
| 326000 | Standard O Headwall - 14" x 23" HERCCP | EA | \$700.00 |
| 326001 | Standard O Headwall - 19" x 30" HERCCP | EA | \$1,000.00 |
| 326002 | Standard O Headwall - 22" x 34" HERCCP | EA | \$1,200.00 |
| 326003 | Standard O Headwall - 24" x 38" HERCCP | EA | \$1,400.00 |
| 326004 | Standard O headwall - 27" x 42" HERCCP | EA | \$1,600.00 |
| 326005 | Standard O Headwall - 29" x 45" HERCCP | EA | \$1,800.00 |
| 326006 | Standard O Headwall - 34" x 53" HERCCP | EA | \$2,300.00 |
| 326007 | Standard O Headwall - 38" x 60" HERCCP | EA | \$2,800.00 |
| 326008 | Standard O Headwall - 43" x 68" HERCCP | EA | \$3,500.00 |
| | | | |
| 330000 | 12" HDPE End Section | EA | \$315.00 |
| 330001 | 15" HDPE End Section | EA | \$355.00 |
| 330002 | 18" HDPE End Section | EA | \$405.00 |
| 330003 | 24" HDPE End Section | EA | \$470.00 |
| 330004 | 30" HDPE End Section | EA | \$770.00 |
| 330005 | 36" HDPE End Section | EA | \$1,065.00 |
| 330006 | 39" HDPE End Section | EA | \$1,250.00 |
| | | | |
| 340000 | Concrete End Section 12" RCCP | EA | \$325.00 |
| 340001 | Concrete End Section 15" RCCP | EA | \$375.00 |
| 340002 | Concrete End Section 18" RCCP | EA | \$400.00 |
| 340003 | Concrete End Section 21" RCCP | EA | \$440.00 |
| 340004 | Concrete End Section 24" RCCP | EA | \$530.00 |
| 340005 | Concrete End Section 27" RCCP | EA | \$600.00 |
| 340006 | Concrete End Section 30" RCCP | EA | \$700.00 |
| 340007 | Concrete End Section 33" RCCP | EA | \$975.00 |
| 340008 | Concrete End Section 36" RCCP | EA | \$1,000.00 |
| 340009 | Concrete End Section 42" RCCP | EA | \$1,300.00 |
| 340010 | Concrete End Section 48" RCCP | EA | \$1,700.00 |
| 340011 | Concrete End Section 54" RCCP | EA | \$1,900.00 |
| 340012 | Concrete End Section 60" RCCP | EA | \$2,300.00 |
| 340013 | Concrete End Section 66" RCCP | EA | \$2,800.00 |
| 340014 | Concrete End Section 72" RCCP | EA | \$3,200.00 |
| | | | |
| 341000 | Concrete End Section - 14" x 23" HERCCP | EA | \$350.00 |
| 341001 | Concrete End Section - 19" x 30" HERCCP | EA | \$450.00 |
| 341002 | Concrete End Section - 22" x 34" HERCCP | EA | \$500.00 |
| 341003 | Concrete End Section - 24" x 38" HERCCP | EA | \$550.00 |
| 341004 | Concrete End Section - 27" x 42" HERCCP | EA | \$850.00 |
| 341005 | Concrete End Section - 29" x 45" HERCCP | EA | \$1,200.00 |
| 341006 | Concrete End Section - 32" x 49" HERCCP | EA | \$1,300.00 |
| 341007 | Concrete End Section - 34" x 53" HERCCP | EA | \$1,400.00 |
| 341008 | Concrete End Section - 38" x 60" HERCCP | EA | \$1,700.00 |
| 341009 | Concrete End Section - 43" x 68" HERCCP | EA | \$2,100.00 |
| 341010 | Concrete End Section - 48" x 76" HERCCP | EA | \$2,500.00 |
| | | | |
| 350000 | End Section 12" CMP | EA | \$290.00 |
| 350001 | End Section 15" CMP | EA | \$375.00 |
| 350002 | End Section 18" CMP | EA | \$405.00 |
| 350003 | End Section 21" CMP | EA | \$430.00 |
| 350004 | End Section 24" CMP | EA | \$475.00 |
| 350005 | End Section 27" CMP | EA | \$550.00 |
| 350006 | End Section 30" CMP | EA | \$625.00 |
| 350007 | End Section 33" CMP | EA | \$740.00 |
| 350008 | End Section 36" CMP | EA | \$1,100.00 |

HOWARD COUNTY - DEPARTMENT OF PLANNING AND ZONING
APPROVED UNIT PRICES AND ITEM CODES
(County Council Resolution # -2015)
Effective Date: 7/1/2015

| ITEM CODE | DESCRIPTION | UNIT | UNIT COST |
|-----------|--|------|------------|
| 350009 | End Section 42" CMP | EA | \$1,300.00 |
| 350010 | End Section 48" CMP | EA | \$1,600.00 |
| 350011 | End Section 54" CMP | EA | \$2,000.00 |
| 350012 | End Section 60" CMP | EA | \$2,300.00 |
| 350013 | End Section 66" CMP | EA | \$2,400.00 |
| 350014 | End Section 72" CMP | EA | \$2,500.00 |
| 350015 | End Section 78" CMP | EA | \$3,200.00 |
| 350016 | End Section 84" CMP | EA | \$3,800.00 |
| 351000 | End Section 17" x 13" CMPA | EA | \$150.00 |
| 351001 | End Section 21" x 15" CMPA | EA | \$200.00 |
| 351002 | End Section 24" x 18" CMPA | EA | \$145.00 |
| 351003 | End Section 28" x 20" CMPA | EA | \$325.00 |
| 351004 | End Section 35" x 24" CMPA | EA | \$405.00 |
| 351005 | End Section 42" x 29" CMPA | EA | \$525.00 |
| 351006 | End Section 49" x 33" CMPA | EA | \$625.00 |
| 351007 | End Section 57" x 38" CMPA | EA | \$700.00 |
| 351008 | End Section 64" x 43" CMPA | EA | \$750.00 |
| 351009 | End Section 71" x 47" CMPA | EA | \$825.00 |
| 351010 | End Section 77" x 52" CMPA | EA | \$875.00 |
| 351011 | End Section 83" x 57" CMPA | EA | \$950.00 |
| 360000 | Single WR Inlet | EA | \$1,750.00 |
| 360001 | Single WR Inlet - Vertical Depth Exceeds 4 ft. | VF | \$160.00 |
| 360002 | Standard WR Inlet | EA | \$2,450.00 |
| 360003 | Standard WR Inlet - Vertical Depth Exceeds 4 ft. | VF | \$160.00 |
| 360004 | Precast Single WR Inlet | EA | \$1,700.00 |
| 360005 | Precast Single WR Inlet - Vertical Depth Exceeds 4 ft. | VF | \$250.00 |
| 360006 | Precast WR Inlet | EA | \$3,100.00 |
| 360007 | Precast WR Inlet - Vertical Depth Exceeds 4 ft. | VF | \$175.00 |
| 360008 | Precast NR Inlet | EA | \$1,750.00 |
| 360009 | Precast NR Inlet - Vertical Depth Exceeds 4 ft. | VF | \$160.00 |
| 360010 | Standard WRM Inlet | EA | \$3,750.00 |
| 360011 | Standard WRM Inlet - Vertical Depth Exceeds 4 ft. | VF | \$200.00 |
| 361000 | Standard 5' COG Inlet | EA | \$2,750.00 |
| 361001 | Standard 5' COG - Vertical Depth Exceeds 6 ft. | VF | \$210.00 |
| 361002 | Standard 10' COG Inlet | EA | \$4,125.00 |
| 361003 | Standard 10' COG - Vertical Depth Exceeds 6 ft. | VF | \$220.00 |
| 361004 | Standard 15' COG Inlet | EA | \$5,500.00 |
| 361005 | Standard 15' COG - Vertical Depth Exceeds 6 ft. | VF | \$250.00 |
| 361006 | Standard 20' COG Inlet | EA | \$6,200.00 |
| 361007 | Standard 20' COG - Vertical Depth Exceeds 6 ft. | VF | \$250.00 |
| 362000 | Standard 5' COS Inlet | EA | \$2,750.00 |
| 362001 | Standard 5' COS - Vertical Depth Exceeds 6 ft. | VF | \$210.00 |
| 362002 | Standard 10' COS Inlet | EA | \$4,125.00 |
| 362003 | Standard 10' COS - Vertical Depth Exceeds 6 ft. | VF | \$220.00 |
| 362004 | Standard 15' COS Inlet | EA | \$5,500.00 |
| 362005 | Standard 15' COS - Vertical Depth Exceeds 6 ft. | VF | \$250.00 |
| 362006 | Standard 20' COS Inlet | EA | \$6,200.00 |
| 362007 | Standard 20' COS - Vertical Depth Exceeds 6 ft. | VF | \$250.00 |
| 363000 | A-5 | EA | \$2,300.00 |
| 363001 | Precast Standard A-5 Inlet | EA | \$1,900.00 |
| 363002 | A-10 | EA | \$3,600.00 |
| 363003 | Precast Standard A-10 Inlet | EA | \$3,200.00 |

HOWARD COUNTY - DEPARTMENT OF PLANNING AND ZONING
APPROVED UNIT PRICES AND ITEM CODES
(County Council Resolution # -2015)
Effective Date: 7/1/2015

| ITEM CODE | DESCRIPTION | UNIT | UNIT COST |
|-----------|---|------|-------------|
| 364000 | Type "C" Inlet | EA | \$2,750.00 |
| 364001 | Type "C" Inlet - Vertical Depth Exceeds 4 ft. | VF | \$210.00 |
| 364002 | Type "D" Inlet | EA | \$1,750.00 |
| 364003 | Type "D" Inlet - Vertical Depth Exceeds 4 ft. | VF | \$160.00 |
| 364004 | Precast Standard Type "D" Inlet | EA | \$1,150.00 |
| 364005 | Type "E" Inlet | EA | \$3,000.00 |
| 364006 | Type "E" Inlet - Vertical Depth Exceeds 4 ft. | VF | \$160.00 |
| 364007 | Type "E" Combination Inlet | EA | \$3,750.00 |
| 364008 | Type "E" Combination Inlet - Vertical Depth Exceeds 4 ft. | VF | \$160.00 |
| 364009 | Type "J" Inlet | EA | \$2,400.00 |
| 364010 | Type "J" Inlet - Vertical Depth Exceeds 4 ft. | VF | \$310.00 |
| 364011 | Type "K" Inlet | EA | \$2,200.00 |
| 364012 | Type "K" Inlet - Vertical Depth Exceeds 4 ft. | VF | \$160.00 |
| 364013 | Type "S" Combination Inlet | EA | \$1,900.00 |
| 364014 | Type "S" Combination Inlet - Vertical Depth Exceeds 4 ft. | VF | \$160.00 |
| 364015 | Type Single - "S" | EA | \$2,600.00 |
| 364016 | Type Single "S" - Vertical Depth Exceeds 4 ft. | VF | \$160.00 |
| 364017 | Type Double - "S" | EA | \$3,200.00 |
| 364018 | Type Double "S" - Vertical Depth Exceeds 4 ft. | VF | \$190.00 |
| 364019 | Double Type "S" Combination Inlet (Parallel to Curb) | EA | \$2,300.00 |
| 364020 | Double Type "S" Combination Inlet (Normal to Curb) | EA | \$2,300.00 |
| 364021 | Double Type "S" Combination - Vertical Depth Exceeds 4 ft. | VF | \$190.00 |
| 364022 | Yard Inlet | EA | \$1,800.00 |
| 364023 | Yard Inlet - Vertical Depth Exceeds 4 ft. | VF | \$230.00 |
| 364024 | Precast Open End Grate | EA | \$1,250.00 |
| 365000 | Adjust Existing Inlet | EA | \$600.00 |
| 365001 | Reconstruct Existing Inlet | EA | \$2,000.00 |
| 370000 | Field Connection - 15" to 27" | EA | \$325.00 |
| 370001 | Field Connection - 15" to 30" | EA | \$350.00 |
| 370002 | Field Connection - 15" to 33" | EA | \$375.00 |
| 370003 | Field Connection - 15" to 36" | EA | \$400.00 |
| 370004 | Field Connection - 15" to 42" | EA | \$450.00 |
| 370005 | Field Connection - 15" to 48" | EA | \$500.00 |
| 370006 | Field Connection - 15" to 54" | EA | \$550.00 |
| 370007 | Field Connection - 15" to 60" | EA | \$600.00 |
| 370008 | Field Connection - 18" to 60" | EA | \$650.00 |
| 370009 | Field Connection - 24" to 60" | EA | \$700.00 |
| 370010 | Field Connection - 27" to 60" | EA | \$750.00 |
| 370011 | Field Connection - 30" to 48" | EA | \$750.00 |
| 370012 | Field Connection - 30" to 60" | EA | \$750.00 |
| 380000 | Type A-Manhole - (Brick) 4' Diameter | EA | \$2,600.00 |
| 380001 | Type A-Manhole - (Brick) 5' Diameter | EA | \$2,800.00 |
| 380002 | Type A-Manhole - (Brick) 6' Diameter | EA | \$3,600.00 |
| 380003 | Type A-Manhole - (Brick) 4' Diameter Offset | EA | \$3,200.00 |
| 380004 | Type B-Manhole (Shallow Brick) - 4' Diameter | EA | \$2,300.00 |
| 380005 | Type C-Manhole (Precast) - 4' Diameter (12" - 24" Pipes) | EA | \$2,000.00 |
| 380006 | Type C-Manhole (Precast) - 4' Diameter - Vertical Depth Exceeds 8' | VF | \$150.00 |
| 380007 | Type C-Manhole (Precast) - 5' Diameter (27" - 36" Pipes) | EA | \$3,300.00 |
| 380008 | Type C-Manhole (Precast) - 5' Diameter - Vertical Depth Exceeds 8' | VF | \$200.00 |
| 380009 | Type C-Manhole (Precast) - 6' Diameter (42" - 48" Pipes) | EA | \$5,000.00 |
| 380010 | Type C-Manhole (Precast) - 6' Diameter - Vertical Depth Exceeds 8' | VF | \$300.00 |
| 380011 | Type C-Manhole (Precast) - 7' Diameter (54" - 60" Pipes) | EA | \$7,200.00 |
| 380012 | Type C-Manhole (Precast) - 7' Diameter - Vertical Depth Exceeds 8' | VF | \$400.00 |
| 380013 | Type C-Manhole (Precast) - 8' Diameter (72" - 84" Pipes) | EA | \$9,375.00 |
| 380014 | Type C-Manhole (Precast) - 8' Diameter - Vertical Depth Exceeds 8' | VF | \$500.00 |
| 380015 | Type C-Manhole (Precast) - 10' Diameter (90" - 96" Pipes) | EA | \$12,500.00 |
| 380016 | Type C-Manhole (Precast) - 10' Diameter - Vertical Depth Exceeds 8' | VF | \$600.00 |
| 380017 | Type C-Manhole (Precast Shallow) - 4' Diameter | EA | \$2,600.00 |
| 380018 | Type C-Manhole (Precast Shallow) - 5' Diameter | EA | \$3,200.00 |
| 380019 | Manhole Cover | EA | \$1,000.00 |
| 380020 | Manhole Steps | EA | \$25.00 |

HOWARD COUNTY - DEPARTMENT OF PLANNING AND ZONING
APPROVED UNIT PRICES AND ITEM CODES
(County Council Resolution # -2015)
Effective Date: 7/1/2015

| ITEM CODE | DESCRIPTION | UNIT | UNIT COST |
|--|--|------|------------|
| 390000 | Subgrade Trench Drains | LF | \$9.00 |
| 391000 | 4" Perforated Circular Pipe Underdrain | LF | \$6.50 |
| 391001 | 6" Perforated Circular Pipe Longitudinal Underdrain | LF | \$7.50 |
| 391002 | 6" Perforated Circular Pipe Underdrain | LF | \$9.00 |
| 391003 | 8" Perforated Circular Pipe Underdrain | LF | \$10.00 |
| 391004 | 4" Circular Pipe Underdrain Outlets | LF | \$9.00 |
| 391005 | 6" Circular Pipe Underdrain Outlets | LF | \$12.50 |
| 391006 | 8" Circular Pipe Underdrain Outlets | LF | \$21.50 |
| 391007 | Aggregate Backfill for Underdrains | CY | \$28.00 |
| 391008 | Geotextile for Underdrains | SY | \$5.00 |
| 392000 | 4" PVC Pipe Schedule 80 | LF | \$12.50 |
| 392001 | 6" PVC Pipe Schedule 80 | LF | \$25.00 |
| 392002 | 4" Perforated PVC Pipe Schedule 80 | LF | \$15.00 |
| 392003 | 6" Perforated PVC Pipe Schedule 80 | LF | \$45.00 |
| SEDIMENT & EROSION CONTROL | | | |
| 393000 | Temporary Slope Drain - 12" Pipe | LF | \$14.00 |
| 393001 | Temporary Slope Drain - 18" Pipe | LF | \$18.00 |
| 393002 | Temporary Slope Drain - 24" Pipe | LF | \$32.00 |
| 393003 | Temporary Slope Drain - 30" Pipe | LF | \$45.00 |
| 393004 | Remove & Reset Temporary Slope Drain - 12" Pipe | LF | \$9.00 |
| 393005 | Remove & Reset Temporary Slope Drain - 18" Pipe | LF | \$8.00 |
| 393006 | Remove & Reset Temporary Slope Drain - 24" Pipe | LF | \$6.00 |
| 393007 | Remove & Reset Temporary Slope Drain - 30" Pipe | LF | \$5.00 |
| 393008 | Erosion & Sediment Control Original Excavation | CY | \$9.00 |
| 393009 | Erosion & Sediment Control Cleanout Excavation | CY | \$7.00 |
| 393010 | Earth Dike | LF | \$4.00 |
| 393011 | Perimeter Dike/Swale | LF | \$4.00 |
| 393012 | Inlet Protection | EA | \$200.00 |
| 393013 | Diversion Dike | LF | \$4.00 |
| 393014 | Straw Bales | LF | \$4.00 |
| 393015 | Placed Rip-Rap for Sediment Control | TON | \$40.00 |
| STORM DRAIN OUTFALL STABILIZATION | | | |
| 400000 | Gabions - 6' x 3' x 1' Basket (Stone, Basket, Filter Cloth) | EA | \$180.00 |
| 400001 | Gabions - 6' x 3' x 1.5' Basket (Stone, Basket, Filter Cloth) | EA | \$240.00 |
| 400002 | Gabions - 6' x 3' x 3' Basket (Stone, Basket, Filter Cloth) | EA | \$360.00 |
| 400003 | Gabions - 9' x 3' x 3' Basket (Stone, Basket, Filter Cloth) | EA | \$460.00 |
| 400004 | Gabions - 9' x 6' x .75' Basket (Stone, Basket, Filter Cloth) | EA | \$360.00 |
| 400005 | Gabions - 12' x 3' x 1' Basket (Stone, Basket, Filter Cloth) | EA | \$310.00 |
| 400006 | Gabions - 12' x 3' x 3' Basket (Stone, Basket, Filter Cloth) | EA | \$680.00 |
| 400007 | Gabions - 12' x 6' x .75' Basket (Stone, Basket, Filter Cloth) | EA | \$450.00 |
| 400100 | MSHA Class 0 Ungrouted Rip-rap | SY | \$60.00 |
| 400101 | MSHA Class 1 Ungrouted Rip-rap | SY | \$90.00 |
| 400102 | MSHA Class 2 Ungrouted Rip-rap | SY | \$100.00 |
| 400103 | MSHA Class 3 Ungrouted Rip-rap | SY | \$120.00 |
| 400200 | No. 2 Stone (3/4" - 1-1/2") | CY | \$40.00 |
| 400300 | Geotextile Class "C" - Filter Cloth or Blanket | SY | \$9.00 |
| 400301 | Geotextile Class "F" - Slope Silt Fence | LF | \$1.50 |
| 400302 | Geotextile Class "F" - Channel Silt Fence | LF | \$2.00 |
| 400303 | Remove & Reset Geotextile Class "F" Silt Fence | LF | \$1.50 |
| 400304 | Super Silt Fence | LF | \$8.00 |
| 400305 | Orange Safety Fence | LF | \$3.00 |
| RETAINING & NOISE WALLS | | | |
| 450000 | Concrete Retaining Wall - 6' high, 33 deg. surcharge | LF | \$400.00 |
| 450001 | Concrete Retaining Wall - 8' high, 33 deg. surcharge | LF | \$500.00 |
| 450002 | Concrete Retaining Wall - 10' high, 33 deg. surcharge | LF | \$600.00 |
| 450003 | Concrete Retaining Wall - 20' high, 500 lbs. per LF surcharge | LF | \$1,600.00 |

HOWARD COUNTY - DEPARTMENT OF PLANNING AND ZONING
APPROVED UNIT PRICES AND ITEM CODES
(County Council Resolution # -2015)
Effective Date: 7/1/2015

| ITEM CODE | DESCRIPTION | UNIT | UNIT COST |
|--|--|-------|-----------|
| 450100 | CMU Retaining Wall (6" Thick - Reinforced, Excluding Footing) | SF | \$7.00 |
| 450101 | CMU Retaining Wall (8" Thick - Reinforced, Excluding Footing) | SF | \$8.00 |
| 450102 | CMU Retaining Wall (10" Thick - Reinforced, Excluding Footing) | SF | \$10.00 |
| 450103 | CMU Retaining Wall (12" Thick - Reinforced, Excluding Footing) | SF | \$11.00 |
| 450200 | Timber Retaining Wall - 3' high | LF | \$45.00 |
| 450300 | GeoGrid Block Retaining Walls (Excluding Footing) | SF | \$20.00 |
| 450400 | Noise Barrier System Height Up To 24' | SF | \$14.00 |
| 450401 | Wooden Noise Wall Height Up To 8' | SF | \$12.50 |
| STREET CONSTRUCTION & PAVEMENT MARKINGS | | | |
| 500000 | Gravel Base Course Graded Aggregate (GAB) | IN/SY | \$2.00 |
| 500001 | CR-6 Base Course | IN/SY | \$1.50 |
| 500002 | 2" Sawcut | LF | \$4.00 |
| 500003 | Full Depth Sawcut | LF | \$6.00 |
| 500004 | Mill Existing Asphalt - 0" to 2" Deep | SY | \$10.00 |
| 500005 | Rubberized Crack Sealer | GAL | \$28.00 |
| 500006 | HMA SuperPave Final Surface | IN/SY | \$4.00 |
| 500007 | HMA SuperPave Intermediate | IN/SY | \$3.50 |
| 500008 | HMA SuperPave Base | IN/SY | \$3.25 |
| 500009 | Chip Seal Double Surface Treatment | IN/SY | \$2.00 |
| 500100 | P-1 Paving Section - CBR 3 to <5 (Min. HMA w/ GAB) | SY | \$29.50 |
| 500101 | P-2 Paving Section - CBR 3 to <5 (Min. HMA w/ GAB) | SY | \$32.00 |
| 500102 | P-3 Paving Section - CBR 3 to <5 (Min. HMA w/ GAB) | SY | \$39.25 |
| 500103 | P-4 Paving Section - CBR 3 to <5 (Min. HMA w/ GAB) | SY | \$54.00 |
| 500104 | P-5 Paving Section - CBR 3 to <5 (Min. HMA w/ GAB) | SY | \$56.50 |
| 500105 | P-6 Paving Section - CBR 3 to <5 (Min. HMA w/ GAB) | SY | \$63.75 |
| 500106 | P-7 Paving Section - CBR 3 to <5 (Min. HMA w/ GAB) | SY | \$36.50 |
| 500107 | P-8 Paving Section - CBR 3 to <5 (Min. HMA w/ GAB) | SY | \$31.00 |
| 500200 | P-1 Paving Section - CBR 5 to <7 (Min. HMA w/ GAB) | SY | \$26.50 |
| 500201 | P-2 Paving Section - CBR 5 to <7 (Min. HMA w/ GAB) | SY | \$24.00 |
| 500202 | P-3 Paving Section - CBR 5 to <7 (Min. HMA w/ GAB) | SY | \$31.25 |
| 500203 | P-4 Paving Section - CBR 5 to <7 (Min. HMA w/ GAB) | SY | \$42.00 |
| 500204 | P-5 Paving Section - CBR 5 to <7 (Min. HMA w/ GAB) | SY | \$44.50 |
| 500205 | P-6 Paving Section - CBR 5 to <7 (Min. HMA w/ GAB) | SY | \$49.75 |
| 500206 | P-7 Paving Section - CBR 5 to <7 (Min. HMA w/ GAB) | SY | \$32.50 |
| 500207 | P-8 Paving Section - CBR 5 to <7 (Min. HMA w/ GAB) | SY | \$28.00 |
| 500300 | P-1 Paving Section - CBR ≥ 7 (Min. HMA w/ GAB) | SY | \$22.50 |
| 500301 | P-2 Paving Section - CBR ≥ 7 (Min. HMA w/ GAB) | SY | \$20.00 |
| 500302 | P-3 Paving Section - CBR ≥ 7 (Min. HMA w/ GAB) | SY | \$25.25 |
| 500303 | P-4 Paving Section - CBR ≥ 7 (Min. HMA w/ GAB) | SY | \$32.75 |
| 500304 | P-5 Paving Section - CBR ≥ 7 (Min. HMA w/ GAB) | SY | \$42.50 |
| 500305 | P-6 Paving Section - CBR ≥ 7 (Min. HMA w/ GAB) | SY | \$45.75 |
| 500306 | P-7 Paving Section - CBR ≥ 7 (Min. HMA w/ GAB) | SY | \$29.50 |
| 500307 | P-8 Paving Section - CBR ≥ 7 (Min. HMA w/ GAB) | SY | \$23.00 |
| 500400 | P-1 Paving Section - CBR 3 to <5 (Min. HMA with Constant GAB) | SY | \$25.38 |
| 500401 | P-2 Paving Section - CBR 3 to <5 (Min. HMA with Constant GAB) | SY | \$28.88 |
| 500402 | P-3 Paving Section - CBR 3 to <5 (Min. HMA with Constant GAB) | SY | \$36.13 |
| 500403 | P-4 Paving Section - CBR 3 to <5 (Min. HMA with Constant GAB) | SY | \$46.50 |
| 500404 | P-5 Paving Section - CBR 3 to <5 (Min. HMA with Constant GAB) | SY | \$53.75 |
| 500405 | P-6 Paving Section - CBR 3 to <5 (Min. HMA with Constant GAB) | SY | \$58.63 |
| 500406 | P-8 Paving Section - CBR 3 to <5 (Min. HMA with Constant GAB) | SY | \$20.00 |
| 500500 | P-1 Paving Section - CBR 5 to <7 (Min. HMA with Constant GAB) | SY | \$23.75 |
| 500501 | P-2 Paving Section - CBR 5 to <7 (Min. HMA with Constant GAB) | SY | \$24.00 |
| 500502 | P-3 Paving Section - CBR 5 to <7 (Min. HMA with Constant GAB) | SY | \$31.25 |
| 500503 | P-4 Paving Section - CBR 5 to <7 (Min. HMA with Constant GAB) | SY | \$43.25 |
| 500504 | P-5 Paving Section - CBR 5 to <7 (Min. HMA with Constant GAB) | SY | \$47.25 |
| 500505 | P-6 Paving Section - CBR 5 to <7 (Min. HMA with Constant GAB) | SY | \$52.13 |
| 500506 | P-8 Paving Section - CBR 5 to <7 (Min. HMA with Constant GAB) | SY | \$26.00 |

HOWARD COUNTY - DEPARTMENT OF PLANNING AND ZONING
APPROVED UNIT PRICES AND ITEM CODES
(County Council Resolution # -2015)
Effective Date: 7/1/2015

| ITEM CODE | DESCRIPTION | UNIT | UNIT COST |
|-----------|--|-------|------------|
| 500600 | P-1 Paving Section - CBR \geq 7 (Min. HMA with Constant GAB) | SY | \$22.13 |
| 500601 | P-2 Paving Section - CBR \geq 7 (Min. HMA with Constant GAB) | SY | \$24.00 |
| 500602 | P-3 Paving Section - CBR \geq 7 (Min. HMA with Constant GAB) | SY | \$28.00 |
| 500603 | P-4 Paving Section - CBR \geq 7 (Min. HMA with Constant GAB) | SY | \$36.75 |
| 500604 | P-5 Paving Section - CBR \geq 7 (Min. HMA with Constant GAB) | SY | \$44.00 |
| 500605 | P-6 Paving Section - CBR \geq 7 (Min. HMA with Constant GAB) | SY | \$47.25 |
| 500606 | P-8 Paving Section - CBR \geq 7 (Min. HMA with Constant GAB) | SY | \$26.00 |
| 500700 | Concrete Pavement | IN/SY | \$10.00 |
| 501000 | HMA - Bituminous Curb | LF | \$6.00 |
| 501001 | Standard Barrier Curb | LF | \$17.00 |
| 501002 | Concrete Curb & Gutter Transition | LF | \$25.00 |
| 501003 | Concrete Curb & Gutter | LF | \$14.00 |
| 501004 | Modified Curb & Gutter | LF | \$14.00 |
| 501005 | Precast Concrete Wheel Stops - Fixed | EA | \$45.00 |
| 501006 | Monolithic Concrete Median | SF | \$49.00 |
| 502000 | Concrete Sidewalk - 4" Thick | SY | \$32.00 |
| 502001 | Monolithic Concrete Curb & Sidewalk | SY | \$45.00 |
| 502002 | Brick Pavers | SF | \$15.00 |
| 502003 | Macadam Path or Sidewalk | IN/SY | \$5.50 |
| 502100 | Sidewalk Ramp Type "A" | EA | \$575.00 |
| 502101 | Sidewalk Ramp Type "B" | EA | \$925.00 |
| 502102 | Sidewalk Ramp Type "C" | EA | \$575.00 |
| 502200 | Residential Driveway w/Sidewalk Setback from Curb | EA | \$950.00 |
| 502201 | Residential Driveway w/Sidewalk Adjacent to Curb | EA | \$950.00 |
| 502202 | Residential Driveway w/Modified Curb | EA | \$950.00 |
| 502203 | Residential Driveway w/Bit. Curb & Sidewalk | EA | \$625.00 |
| 502204 | Residential Driveway w/o Sidewalk | EA | \$625.00 |
| 502205 | Residential Driveway, Open Section Road | EA | \$325.00 |
| 502206 | Commercial Driveway on Closed Section Road | EA | \$4,400.00 |
| 502207 | Commercial Driveway on Open Section Road | EA | \$4,400.00 |
| 502208 | Commercial Driveway - High Volume | EA | \$4,400.00 |
| 503000 | Guard Rail W Beam | LF | \$17.50 |
| 503001 | Dead End Type "A" Barricade | LF | \$30.00 |
| 503002 | Dead End Type "C" Barricade | LF | \$40.00 |
| 503003 | Guard Rail w/Beam Anchor | LF | \$22.00 |
| 503004 | Type 1 - End Flare | EA | \$625.00 |
| 503005 | Type 2 - End Flare | EA | \$675.00 |
| 503006 | Guard Rail Remove & Reset | LF | \$17.00 |
| 503007 | Guard Rail Removal and Disposal | LF | \$7.25 |
| 504000 | Chain Link Fence - 6' | LF | \$20.00 |
| 504001 | Chain Link Fence - 8' | LF | \$25.00 |
| 504002 | Terminal Post 6' Chain Link fence | EA | \$12.50 |
| 504003 | Terminal Post 8' Chain Link Fence | EA | \$18.75 |
| 504004 | Gate - 6' for 6' Chain Link Fence | EA | \$140.00 |
| 504005 | Gate - 12' for 6' Chain Link Fence | EA | \$275.00 |
| 504006 | Gate - 12' for 8' Chain Link Fence | EA | \$325.00 |
| 504007 | Chain Link Fence Remove & Reset | LF | \$12.50 |
| 504008 | Chain Link Fence Removal and Disposal | LF | \$2.00 |
| 504009 | Wood Stock Fence | LF | \$16.50 |
| 504010 | Wood Fence Removal and Disposal | LF | \$2.00 |

HOWARD COUNTY - DEPARTMENT OF PLANNING AND ZONING
APPROVED UNIT PRICES AND ITEM CODES
(County Council Resolution # -2015)
Effective Date: 7/1/2015

| ITEM CODE | DESCRIPTION | UNIT | UNIT COST |
|--|---|------|-------------|
| FINE GRADING AND LANDSCAPING | | | |
| 505000 | Placing Salvaged Topsoil (2" depth) | SY | \$2.75 |
| 505001 | Top Soil - Furnished & Placed (2" depth) | SY | \$3.25 |
| 505002 | Temporary Seeding & Mulching | SY | \$0.40 |
| 505003 | Straw Mulching | SY | \$0.25 |
| 505004 | Solid Sodding | SY | \$3.00 |
| 505005 | Seeding | SY | \$0.40 |
| 505006 | Seeding & Mulching | SY | \$0.80 |
| 505007 | Soil Stabilization Matting (Miramat, Curlex, etc.) | SY | \$2.75 |
| 506000 | Selective Tree Trimming | EA | \$120.00 |
| 506001 | Street Trees | EA | \$375.00 |
| 506002 | Furnish & Plant Acer Rubrum (Red Maple) - 2" C BB | EA | \$190.00 |
| 506003 | Furnish & Plant Crataegus (Flowering Hawthorne) - 2" C BB | EA | \$190.00 |
| 506004 | Furnish & Plant Gleditsia Triacanthos Inermis (Thorny Honey Locust) - 2" C BB | EA | \$190.00 |
| 506005 | Furnish & Plant Quercus Palustris (Pin Oak) - 2" C BB | EA | \$190.00 |
| SIGNAGE | | | |
| 750000 | Install New Signs Supplied by County | SF | \$10.00 |
| 750001 | Stop signs | EA | \$110.00 |
| 750002 | Street Signs | EA | \$125.00 |
| RAILROAD TRACK INSTALLATION | | | |
| 760000 | Railroad Ties | LF | \$30.00 |
| 760001 | Railroad Track Installation | LF | \$105.00 |
| UTILITY ADJUSTMENTS & HANDRAILS | | | |
| 770000 | Adjust Existing Utility Appurtenances to Finished Grade - LT 12" Circ. | EA | \$170.00 |
| 770001 | Adjust Existing Utility Appurtenances to Finished Grade - 12" to 29" Circ. | EA | \$250.00 |
| 770002 | Adjust Existing Utility Appurtenances to Finished Grade - GT 29" Circ. | EA | \$340.00 |
| 770003 | Galvanized Handrails (3 rails) | LF | \$37.50 |
| 770004 | Wood Handrails (3 rails) | LF | \$25.00 |
| STORMWATER MANAGEMENT FACILITIES | | | |
| 800000 | Corrugated Metal Riser Structure | EA | \$3,750.00 |
| 800001 | Corrugated Metal Trash Rack for CM Riser | EA | \$2,250.00 |
| 800002 | Corrugated Metal Anti-Seep Collar | EA | \$750.00 |
| 800100 | Reinforced Concrete Riser Structure | CY | \$825.00 |
| 800101 | A-2 Concrete Cradle | CY | \$825.00 |
| 800102 | Reinforced Concrete Anti-Seep Collar | CY | \$825.00 |
| 800103 | Sand Filter Diaphragm | CY | \$33.25 |
| 800104 | Reinforced Concrete | CY | \$825.00 |
| 800200 | Rock Vane | EA | \$5,500.00 |
| 800201 | Log Vane | EA | \$2,100.00 |
| 800202 | Flush Cut | EA | \$900.00 |
| 800203 | Root Wad Revetment | EA | \$2,400.00 |
| 800204 | Rock J-Hook Vane | EA | \$6,100.00 |
| 800205 | Rock Cross Vane | EA | \$6,800.00 |
| 800206 | Boulder Bank Stabilization | LF | \$100.00 |
| 800207 | Live Stakes | EA | \$4.00 |
| 800208 | Live Branch Layering | LF | \$15.00 |
| 800209 | Coir Fiber Erosion Control Matting | SY | \$5.00 |
| 800210 | Stream Diversion and Dewatering | LS | \$50,000.00 |
| 800300 | Sand (washed) for Bioretention | CY | \$30.00 |
| 800301 | Pea Gravel (washed) for Bioretention | CY | \$30.00 |
| 800302 | Planting Soil for Bioretention | CY | \$25.00 |
| 800303 | Mulch for Bioretention | CY | \$28.00 |
| 800304 | Trees for Bioretention | EA | \$300.00 |
| 800305 | Shrubs for Bioretention | EA | \$150.00 |
| 800306 | Grasses for Bioretention | SY | \$1.00 |

HOWARD COUNTY - DEPARTMENT OF PLANNING AND ZONING
APPROVED UNIT PRICES AND ITEM CODES
(County Council Resolution # -2015)
Effective Date: 7/1/2015

| ITEM CODE | DESCRIPTION | UNIT | UNIT COST |
|------------------------------|---|------|------------|
| 800400 | Rain Garden/Biorentention Facility (complete) | EA | \$6,500.00 |
| 800401 | Infiltration Trench (Stone Only) | CY | \$60.00 |
| 800402 | Dry Well (Complete) | EA | \$6,500.00 |
| 800403 | Pervious Concrete (w/12" of #57 stone) | SY | \$80.00 |
| 800500 | Clay Backfill for Core Trench | CY | \$20.00 |
| UNDERGROUND UTILITIES | | | |
| Boring & Jacking | | | |
| 820000 | Boring & Jacking Water | LF | \$263.00 |
| 820001 | Boring & Jacking Sewer | LF | \$488.00 |
| 820002 | 36" Steel Casing Pipe (Boring/Jacking) | LF | \$125.00 |
| Water | | | |
| 820100 | 4" DIP | LF | \$50.00 |
| 820101 | 6" DIP | LF | \$56.00 |
| 820102 | 8" DIP | LF | \$60.00 |
| 820103 | 12" DIP | LF | \$76.00 |
| 820104 | 16" DIP | LF | \$80.00 |
| 820110 | 4" C-900 PVC | LF | \$26.00 |
| 820111 | 6" C-900 PVC | LF | \$30.00 |
| 820112 | 8" C-900 PVC | LF | \$36.00 |
| 820113 | 10" C-900 PVC | LF | \$46.00 |
| 820114 | 12" C-900 PVC | LF | \$52.00 |
| 820120 | 3/4" Copper WHC | LF | \$30.00 |
| 820121 | 1" Copper WHC | LF | \$31.00 |
| 820122 | 1-1/2" Copper WHC | LF | \$35.00 |
| 820123 | 2" Copper WHC | LF | \$36.00 |
| 820124 | 3" PVC Schedule 40 WHC | LF | \$40.00 |
| 820125 | 4" PVC Schedule 40 WHC | LF | \$44.00 |
| 820130 | 1-1/2" Drains | EA | \$1,000.00 |
| 820131 | Blow off valve | EA | \$9,000.00 |
| 820132 | Air Release valve & Vault | EA | \$5,700.00 |
| 820140 | 8" x 4" Tapping Sleeve & Valve | EA | \$1,500.00 |
| 820141 | 8" x 6" Tapping Sleeve & Valve | EA | \$1,875.00 |
| 820142 | 8" x 8" Tapping Sleeve & Valve | EA | \$3,125.00 |
| 820143 | 8" x 12" Tapping Sleeve & Valve | EA | \$6,250.00 |
| 820150 | 4" Gate Valve & Box | EA | \$600.00 |
| 820151 | 6" Gate Valve & Box | EA | \$700.00 |
| 820152 | 8" Gate Valve & Box | EA | \$800.00 |
| 820153 | 10" Gate Valve & Box | EA | \$1,000.00 |
| 820154 | 12" Gate Valve & Box | EA | \$1,200.00 |
| 820155 | 16" Gate Valve & Vault (Precast) | EA | \$6,000.00 |
| 820160 | 3/4" Meter Vault for outside metering | EA | \$438.00 |
| 820161 | 1" Meter Vault for outside metering | EA | \$500.00 |
| 820162 | 1-1/2" Meter Vault for outside metering | EA | \$625.00 |
| 820163 | 2" Meter Vault for outside metering | EA | \$1,063.00 |
| 820164 | 3" Meter Vault for outside metering | EA | \$3,750.00 |
| 820165 | 4" Meter Vault for outside metering | EA | \$4,375.00 |
| 820166 | 6" Meter Vault for outside metering | EA | \$8,750.00 |
| 820170 | Fire Hydrants, FH Tee and Valve | EA | \$2,500.00 |
| 820171 | Fire Suppression Tank (5,000 gal) and Concrete Slab | EA | \$6,850.00 |
| 820172 | Removal of abandoned 6" or 8" water mains | LF | \$30.00 |
| Sewer | | | |
| 820200 | 4" PVC Schedule 40 (less than 12' deep) | LF | \$55.00 |
| 820201 | 6" PVC Schedule 40 (less than 12' deep) | LF | \$60.00 |
| 820202 | 8" PVC Schedule 40 (less than 12' deep) | LF | \$65.00 |
| 820203 | 10" PVC Schedule 40 (less than 12' deep) | LF | \$70.00 |
| 820204 | 12" PVC Schedule 40 (less than 12' deep) | LF | \$75.00 |
| 820205 | 8" PVC Schedule 40 (12' - 16' deep) | LF | \$69.00 |
| 820206 | 8" PVC Schedule 40 (greater than 16' deep) | LF | \$83.00 |

HOWARD COUNTY - DEPARTMENT OF PLANNING AND ZONING
APPROVED UNIT PRICES AND ITEM CODES
(County Council Resolution # -2015)
Effective Date: 7/1/2015

| ITEM CODE | DESCRIPTION | UNIT | UNIT COST |
|---|--|--------------|-------------|
| 820210 | 8" DIP Sewer (all depths) | LF | \$75.00 |
| 820211 | 10" DIP Sewer (all depths) | LF | \$85.00 |
| 820212 | 12" DIP Sewer (all depths) | LF | \$95.00 |
| 820220 | 4" C-900 PVC Sewer Pipe | LF | \$70.00 |
| 820221 | 6" C-900 PVC Sewer Pipe | LF | \$75.00 |
| 820222 | 8" C-900 PVC Sewer Pipe | LF | \$80.00 |
| 820223 | 10" C-900 PVC Sewer Pipe | LF | \$90.00 |
| 820224 | 12" C-900 PVC Sewer Pipe | LF | \$93.00 |
| 820230 | 4' Sewer Manhole | EA | \$2,500.00 |
| 820231 | Sewer Cleanouts | EA | \$1,000.00 |
| 820232 | Type A Drop Connection | EA | \$1,060.00 |
| 820233 | Type B Drop Connection | EA | \$1,185.00 |
| 820234 | Oil/Grease Interceptors | EA | \$6,250.00 |
| Shared Septic | | | |
| Piping and Drain Fields | | | |
| 820300 | 1-1/4" SDP 11 PVC (Low Pressure Sewer) | LF | \$15.00 |
| 820301 | 1-1/2" SDP 11 PVC SHC (Low Pressure Sewer) | LF | \$20.00 |
| 820302 | 2" Sewer Force Main | LF | \$25.00 |
| 820303 | 4" Sewer Force Main | LF | \$35.00 |
| 820304 | Drain Field Trenches, gravity, 4" PVC, 3' depth including tile | LF | \$8.00 |
| Pumps/Distribution System Controls/Buildings | | | |
| 820310 | Simplex Grinder Pump | EA | \$4,000.00 |
| 820311 | Duplex Grinder Pump | EA | \$8,000.00 |
| 820312 | Duplex Submersible Pumps | EA | \$8,000.00 |
| 820313 | Flushing Connections | EA | \$1,500.00 |
| 820314 | Concrete Settling Tank | EA | \$2,500.00 |
| 820315 | Monitoring Well | EA | \$1,500.00 |
| 820316 | Distribution Box | EA | \$1,000.00 |
| 820317 | Electrical Controls and Telemetry | EA | \$15,000.00 |
| 820318 | Blower/Distribution Pumpsets/Controls | EA | \$20,000.00 |
| 820319 | Septic Tanks | Per 1000 Gal | \$1,500.00 |
| 820320 | Treatment/Chemical/Storage Building | EA | \$30,000.00 |
| SIGNAGE & ELECTRICAL WORK | | | |
| 870000 | 3/4" Electrical Conduit-PVC Schedule 80-Riser | LF | \$1.00 |
| 870001 | 3/4" Electrical Conduit-PVC Schedule 80-Pushed | LF | \$2.00 |
| 870002 | 3/4" Electrical Conduit-PVC Schedule 80-Trenched | LF | \$3.00 |
| 870003 | 3/4" Electrical Conduit-PVC Schedule 80-Slotted | LF | \$2.00 |
| 870004 | 3/4" Electrical Conduit-PVC Schedule 80-Elbow | EA | \$5.00 |
| 870005 | 1" Electrical Conduit-PVC Schedule 80-Riser | LF | \$2.50 |
| 870006 | 1" Electrical Conduit-PVC Schedule 80-Pushed | LF | \$5.00 |
| 870007 | 1" Electrical Conduit-PVC Schedule 80-Trenched | LF | \$2.00 |
| 870008 | 1" Electrical Conduit-PVC Schedule 80-Slotted | LF | \$5.00 |
| 870009 | 1" Electrical Conduit-PVC Schedule 80-Elbow | EA | \$7.50 |
| 870010 | 2" Electrical Conduit-PVC Schedule 80-Riser | LF | \$5.00 |
| 870011 | 2" Electrical Conduit-PVC Schedule 80-Pushed | LF | \$18.50 |
| 870012 | 2" Electrical Conduit-PVC Schedule 80-Trenched | LF | \$5.00 |
| 870013 | 2" Electrical Conduit-PVC Schedule 80-Slotted | LF | \$18.50 |
| 870014 | 2" Electrical Conduit-PVC Schedule 80-Elbow | EA | \$9.00 |
| 870015 | 3" Electrical Conduit-PVC Schedule 80-Riser | LF | \$10.00 |
| 870016 | 3" Electrical Conduit-PVC Schedule 80-Pushed | LF | \$20.00 |
| 870017 | 3" Electrical Conduit-PVC Schedule 80-Trenched | LF | \$6.50 |
| 870018 | 3" Electrical Conduit-PVC Schedule 80-Slotted | LF | \$7.00 |
| 870019 | 3" Electrical Conduit-PVC Schedule 80-Elbow | EA | \$15.00 |
| 870020 | 4" Electrical Conduit-PVC Schedule 80-Riser | LF | \$15.00 |
| 870021 | 4" Electrical Conduit-PVC Schedule 80-Pushed | LF | \$20.00 |
| 870022 | 4" Electrical Conduit-PVC Schedule 80-Trenched | LF | \$6.50 |
| 870023 | 4" Electrical Conduit-PVC Schedule 80-Slotted | LF | \$21.00 |
| 870024 | 4" Electrical Conduit-PVC Schedule 80-Elbow | EA | \$45.00 |

HOWARD COUNTY - DEPARTMENT OF PLANNING AND ZONING
APPROVED UNIT PRICES AND ITEM CODES
(County Council Resolution # -2015)
Effective Date: 7/1/2015

| ITEM CODE | DESCRIPTION | UNIT | UNIT COST |
|-----------|---|------|------------|
| 870200 | 2" U-guard | LF | \$11.00 |
| 870201 | 3" U-guard | LF | \$15.00 |
| 870202 | Trenching & Backfill | LF | \$7.00 |
| 870203 | Meter Socket | EA | \$50.00 |
| 870204 | Disconnect Switch NEMA Type 3R-30 Amp | EA | \$135.00 |
| 870205 | Disconnect Switch NEMA Type 3R-60 Amp | EA | \$150.00 |
| 870206 | Disconnect Switch NEMA Type 4-30 Amp Stainless Steel | EA | \$1,100.00 |
| 870207 | Disconnect Switch NEMA Type 4-60 Amp Stainless Steel | EA | \$1,200.00 |
| 870208 | Ground Rod w/Clamp | EA | \$20.00 |
| 870209 | Breakaway Connector Kit-Bussman #HEBAWRLC-J or Approved Equal | EA | \$50.00 |
| 870210 | Install County Supplied Telemetry Cable-Self Supporting (Overhead)(Any Size) | LF | \$0.60 |
| 870211 | Install County Supplied Telemetry Cable-Jelly Filled (Underground)(Up to 12 Pairs) | LF | \$0.60 |
| 870212 | Install County Supplied Telemetry Cable-Jelly Filled (Underground)(Over 12 Pairs) | LF | \$1.10 |
| 870213 | Install LDF4 Coaxial Cable | LF | \$0.50 |
| 870214 | Install Opticom Detector Cable | LF | \$5.00 |
| 870215 | Loop Wire - 14 THWN in 1/4" Flexible Tubing-For Loop Detector Work Independent of Other S | LF | \$1.00 |
| 870216 | Loop Wire - 14 AWG THWN in 1/4" Flexible Tubing | LF | \$1.00 |
| 870217 | Belden 8281 Coaxial Cable | LF | \$1.25 |
| 870218 | Install County Supplied Video Camera Cable (Traficam) | LF | \$0.50 |
| 870219 | Install County Supplied Autoscope Video Cable | LF | \$5.00 |
| 870300 | Electrical Cable-1 Conductor-14 AWG Aluminum Shielded (Loop Lead in Wire) | LF | \$0.25 |
| 870301 | Electrical Cable-2 Conductor-14 AWG Aluminum Shielded (Loop Lead in Wire) | LF | \$1.25 |
| 870302 | Electrical Cable-2 Conductor-14 AWG-ISMA 19-1 | LF | \$0.40 |
| 870303 | Electrical Cable-3 Conductor-14 AWG-ISMA 19-1 | LF | \$0.60 |
| 870304 | Electrical Cable-5 Conductor-14 AWG-ISMA 19-1 | LF | \$1.35 |
| 870305 | Electrical Cable-7 Conductor-14 AWG-ISMA 19-1 | LF | \$1.45 |
| 870306 | Electrical Cable-10 Conductor-14 AWG-ISMA 19-1 | LF | \$1.25 |
| 870307 | Electrical Cable-15 Conductor-14 AWG-ISMA 19-1 | LF | \$1.35 |
| 870308 | Electrical Cable-20 Conductor-14 AWG-ISMA 19-1 | LF | \$1.60 |
| 870309 | Electrical Cable-2 Conductor-12 AWG Copper Type TC | LF | \$1.25 |
| 870310 | Electrical Cable-2 Conductor-10 AWG Copper Type TC | LF | \$1.25 |
| 870311 | Electrical Cable-1 Conductor-10 AWG-THWN Copper | LF | \$0.30 |
| 870312 | Electrical Cable-1 Conductor-8 AWG-THWN Copper | LF | \$0.85 |
| 870313 | Electrical Cable-1 Conductor-8 AWG-Solid Bare Copper | LF | \$0.55 |
| 870314 | Electrical Cable-1 Conductor-6 AWG-Stranded Bare Copper | LF | \$0.65 |
| 870315 | Electrical Cable-1 Conductor-6 AWG-THWN-Copper | LF | \$0.65 |
| 870316 | Electrical Cable-1 Conductor-4 AWG-THWN-Copper | LF | \$0.70 |
| 870400 | Ground mount sign supports | LF | \$15.00 |
| 870401 | Install sign 0 to ≤ 5SF (Overhead Post) | EA | \$5.50 |
| 870402 | Install sign > 5 SF to ≤ 25SF (Overhead Post) | EA | \$100.00 |
| 870403 | Install sign > 25 SF to ≤ 50SF (Overhead Post) | EA | \$50.00 |
| 870404 | Install sign > 50 SF to ≤ 100SF (Overhead Post) | EA | \$55.00 |
| 870410 | Install Lighting Pole With Arm (Includes T-Base) | EA | \$350.00 |
| 870411 | Install Lighting Arm on Strain Pole or Mast Arm Pole | EA | \$350.00 |
| 870412 | Install Cobra Style Luminaire | EA | \$5.50 |
| 870413 | Wood Pole - Class II (40') | EA | \$55.00 |
| 870414 | Install Wood Pole | EA | \$11.00 |
| 870415 | Install Strain Pole | EA | \$55.00 |
| 870416 | Install Mast Arm Pole | EA | \$275.00 |
| 870417 | Install Mast Arm | EA | \$275.00 |
| 870418 | Install Pedestal Pole-Any Size-With Breakaway Base | EA | \$250.00 |
| 870419 | Install Pedestal Pole-Any Size-on Existing Breakaway Base | EA | \$150.00 |
| 870420 | Install 12' Washington Style Cast Iron Lamp Post | EA | \$2.25 |
| 870421 | Install 14' Aluminum Pole with Solar or AC Powered Flashing School Zone Beacon/Sign Assem | EA | \$220.00 |
| 870422 | Up to 2" Weather Head | EA | \$10.00 |
| 870423 | 3" Weather Head | EA | \$45.00 |
| 870424 | Fuenish & Install Elbow in Existing Concrete Base-Includes Concrete | EA | \$165.00 |
| 870425 | Grout Existing/New Pole Base | EA | \$25.00 |
| 870426 | 3/8" Span Wire | LF | \$0.25 |
| 870427 | 1/4" Span Wire | LF | \$0.20 |
| 870428 | Adjust Span or Tether | EA | \$0.80 |
| 870429 | Bull Ring | EA | \$1.25 |
| 870430 | Black Guy | EA | \$1.00 |
| 870431 | Adjust Black Guy | EA | \$1.00 |
| 870432 | Install Signal Head | EA | \$105.00 |

HOWARD COUNTY - DEPARTMENT OF PLANNING AND ZONING
APPROVED UNIT PRICES AND ITEM CODES
(County Council Resolution # -2015)
Effective Date: 7/1/2015

| ITEM CODE | DESCRIPTION | UNIT | UNIT COST |
|---|---|------|-----------|
| 870433 | Install Optically Programmed Signal Head | EA | \$3.50 |
| 870434 | Install Pedestrian Signal Head | EA | \$94.00 |
| 870435 | Install Pedestrian Pushbutton and Sign | EA | \$25.00 |
| 870436 | Install Mast Arm Mounted Video Camera Detector w/County Supplied Astro-bracket Clamps | EA | \$225.00 |
| 870437 | Photo Cell | EA | \$11.00 |
| 870438 | Install Pole Mounted Radio Antenna w/County Supplied Astro Bracket Clamps | EA | \$72.00 |
| 870439 | Install Opticom Detector w/County Supplied Astro Bracket Clamps | EA | \$50.00 |
| 870440 | Install Flasher Cabinet | EA | \$55.00 |
| 870441 | Install Terminal Cabinet (Splice Cabinet) | EA | \$28.00 |
| 870442 | Install Control Cabinet-Base or Pole Mounted | EA | \$500.00 |
| 870443 | Adjust Elevation of Existing Handbox-Frame and Cover | EA | \$50.00 |
| 870444 | Traffic Signal Handbox (Pullbox) | EA | \$700.00 |
| 870445 | Traffic Signal Handbox-Over Existing Conduits and Cable | EA | \$22.00 |
| 870446 | Remove and Reinstall Existing Conduit Cable (Any Number) | LF | \$5.00 |
| 870447 | Saw Cut 4-1/2" depth | LF | \$7.50 |
| 870448 | Saw Cut 4-1/2" depth-For Loop Detector Work Independent of other Signal Work | LF | \$7.50 |
| 870449 | Install Micro Loop Detector | EA | \$50.00 |
| 870500 | Clean and Paint Strain Pole | EA | \$28.00 |
| 870501 | Clean and Paint Pedestal Pole | EA | \$300.00 |
| 870502 | Clean and Paint Mast Arm Pole | EA | \$350.00 |
| 870503 | Clean and Paint Mast Arm | EA | \$350.00 |
| 870504 | Clean and Paint Streetlight Arm | EA | \$275.00 |
| 870510 | Relocate Any Existing Signal Head (Including Aiming and Adjusting) | EA | \$75.00 |
| 870511 | Removal and Salvage of Signs Less Than 50 SF | EA | \$6.00 |
| 870512 | Removal and Salvage of Signs Greater Than 50 SF | EA | \$11.00 |
| 870513 | Removal and Salvage of Lighting Pole with Arm | EA | \$140.00 |
| 870514 | Removal and Salvage of Lighting Arm on Pole | EA | \$13.00 |
| 870515 | Removal and Salvage of Luminaire | EA | \$1.25 |
| 870516 | Removal and Salvage of Span & Associated Wiring | EA | \$12.00 |
| 870517 | Removal and Salvage Wood Pole | EA | \$1.25 |
| 870518 | Removal and Salvage Strain Pole | EA | \$6.00 |
| 870519 | Removal and Salvage Traffic Signal Mast Arm Pole | EA | \$165.00 |
| 870520 | Remove Foundation 12" Below Grade | CY | \$450.00 |
| 870521 | Removal and Salvage Mast Arm | EA | \$55.00 |
| 870522 | Removal and Salvage Pedestal Pole | EA | \$30.00 |
| 870523 | Removal and Salvage Pedestal Pole and Breakaway Base | EA | \$50.00 |
| 870524 | Removal and Salvage Cabinet | EA | \$55.00 |
| 870525 | Removal Signal Handbox | EA | \$5.00 |
| 870526 | Relocate Existing Handbox | EA | \$13.00 |
| 870527 | Removal and Salvage Any Signal Head | EA | \$35.00 |
| 870528 | Removal and Salvage Pedestrian Signal Head | EA | \$20.00 |
| 870529 | Removal and Salvage Pedestrian Pushbutton & Sign | EA | \$20.00 |
| DEVELOPER STREET LIGHTS* | | | |
| ENERGY AND MAINTENANCE (FOR 2 YEARS) | | | |
| 870600 | 100-WATT HPS VAPOR FIXTURE | EA | \$84.00 |
| 870601 | 150-WATT HPS VAPOR FIXTURE | EA | \$90.00 |
| 870602 | 250-WATT HPS VAPOR FIXTURE | EA | \$100.00 |
| 870603 | 400-WATT HPS VAPOR FIXTURE | EA | \$120.00 |
| 870604 | 100-WATT MH FIXTURE | EA | \$138.00 |
| 870605 | 150-WATT MH FIXTURE | EA | \$145.00 |
| ENERGY (FOR 2 YEARS) | | | |
| 870620 | 56-WATT LED FIXTURE | EA | \$8.00 |
| 870621 | 71-WATT LED FIXTURE | EA | \$10.00 |
| 870622 | 78-WATT LED FIXTURE | EA | \$12.00 |
| 870623 | 86-WATT LED FIXTURE | EA | \$14.00 |
| 870624 | 150-WATT LED FIXTURE | EA | \$19.00 |
| 870625 | 208-WATT LED FIXTURE | EA | \$25.00 |

*PASS-THROUGH FEES BASED ON RATES SET BY BGE